

U.S. LAND CORNER MAINTENANCE

Corner ID : SE Sec. 22, T18N-R1E
41801220000

<u>DATE</u>	<u>CREW</u>	<u>MONUMENT TYPE</u> -----
August 27, 2013	Zachariah P. Dechant Gary L. Dechant	Existing railroad spike over Harrison 7' west of centerline "PP" & 3' north centerline Frontier Ave, on line with fence west

Highway construction is currently taking place. Milling of the old pavement is to be part of the reconstruction.

References:

- 1) Set ½"x24" iron pipe down 8"
- 2) Set ½"x24" iron pipe down 8"
- 3) Set ½"x24" iron pipe at toe of slope of mound system
- 4) Set ½"x24" iron pipe in lawn

<u>Bearing</u>	<u>Distance</u>
N40W	53.33'
N64E	71.89'
S40E	76.10'
S64W	52.18'

Gary L. Dechant

August 27, 2013

Harrison and pipes set on straight lines.

41801220000

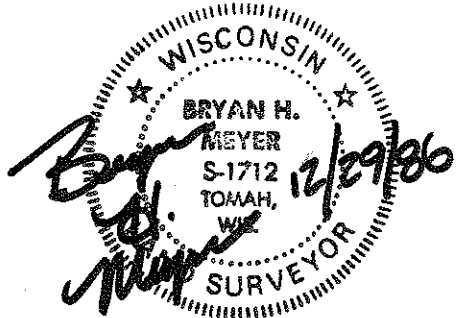

I, Bryan H. Meyer, do hereby certify that on the 25th day of March 19 86, I found (evidence) ~~(evidence)~~ of the Northwest corner of Section 26, T 18 N, R 1 E Fourth Principal Meridian, and I re-established said corner according to the Wisconsin Statutes as shown and described hereon.

Dated this 29th day of Dec. 19 86.

Bryan H. Meyer

Deputy County Surveyor
Title

History of corner establishment since Original Government Survey

Webster Kenyon was here in December of 1889. This corner was re-established by the County Surveyors office in May of 1982 (see page 1).

Description of corner evidence found:

George Baker (Monroe County Highway Commissioner) contacted the County Surveyors Office and informed us that he was planning to resurface C.T.H. "PP". During the fall of 1985, two additional ties were taken and the existing ties checked. Using the above mentioned ties, a railroad spike was set over the top of the Harrison!

Description of corner and witness monuments, references and accessories used to perpetuate the original or re-established location of this corner:

Crew: Meyer, Wilhite
Date: March 25, 1986

Witnesses to corner location:

Dallas Wilhite

Bryan Meyer

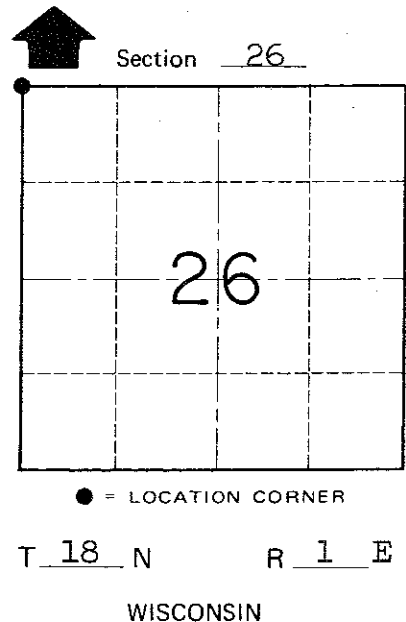
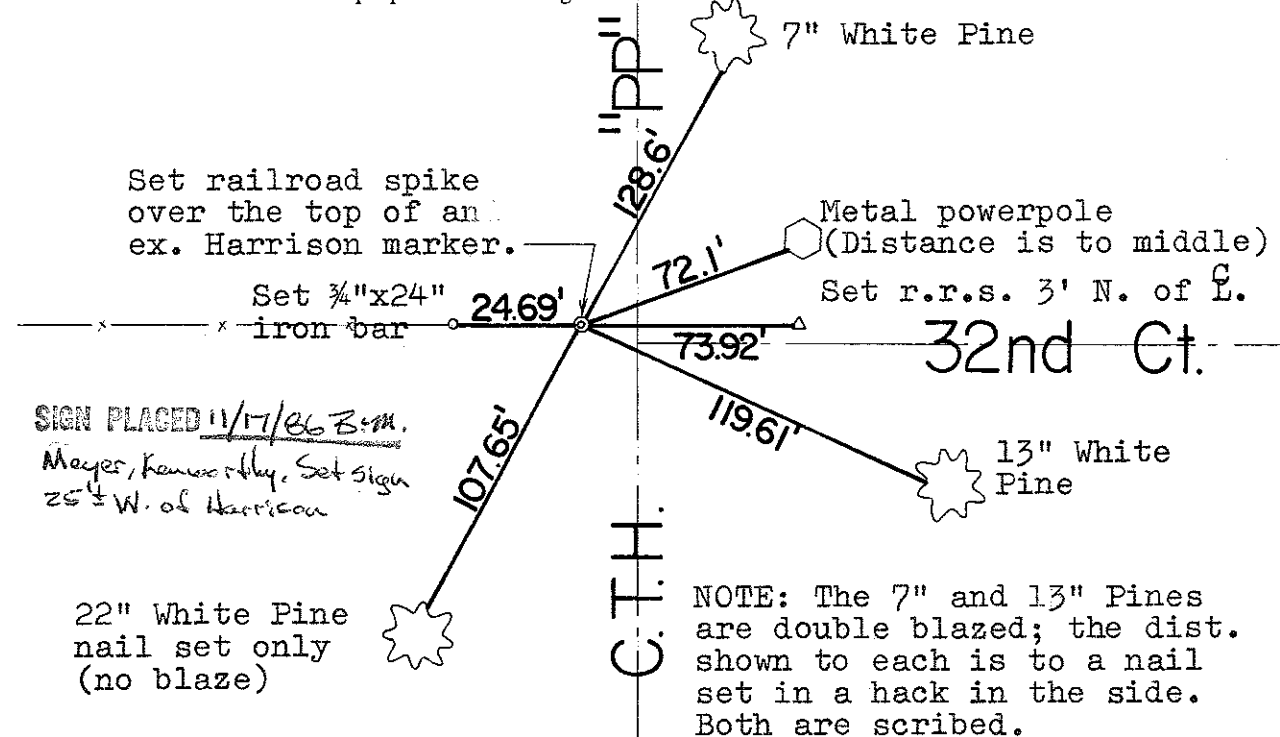

COUNTY SURVEYOR FORM NO. 1

SURVEY CONTROL ORDER

Horizontal	_____
Vertical	_____

WISCONSIN COORDINATE SYSTEM

Corner	East (X)	North (Y)	Elevation (Z)	Zone
Control Sta. Name				

~~City, Village or~~ Town of Byron

County of Monroe

I, Harley A. Sime, do hereby certify that on the twentieth day of May 19 82, I found ~~(no evidence)~~ (no evidence) of the Northwest corner of Section 26, T 18 N, R 1 E Fourth Principal Meridian, and I re-established said corner according to the Wisconsin Statutes as shown and described hereon.

Dated this 27th day of May 19 82.

Harley A. Sime - R. L. S. 355

County Surveyor, Monroe County

Approved: HARLEY A. SIME
MONROE CO. SURVEYOR

History of corner establishment since Original Government Survey

Henry Schroeder was here in December of 1889.

Description of corner evidence found:

Set corner on line with the Section line fence to the West, and at a distance 1320'± from the forty fence on the West side of the ~~SE~~^{SE}/₄-~~SE~~^{SE}/₄ of Section 22.



Description of corner and witness monuments, references and accessories used to perpetuate the original or re-established location of this corner:

Witnesses to corner location:

Bryan Meyer - Crew Chief

Gary Dechant

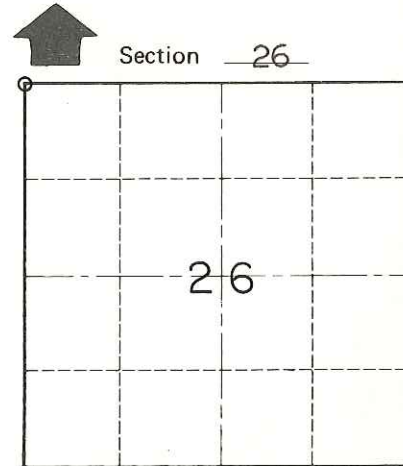
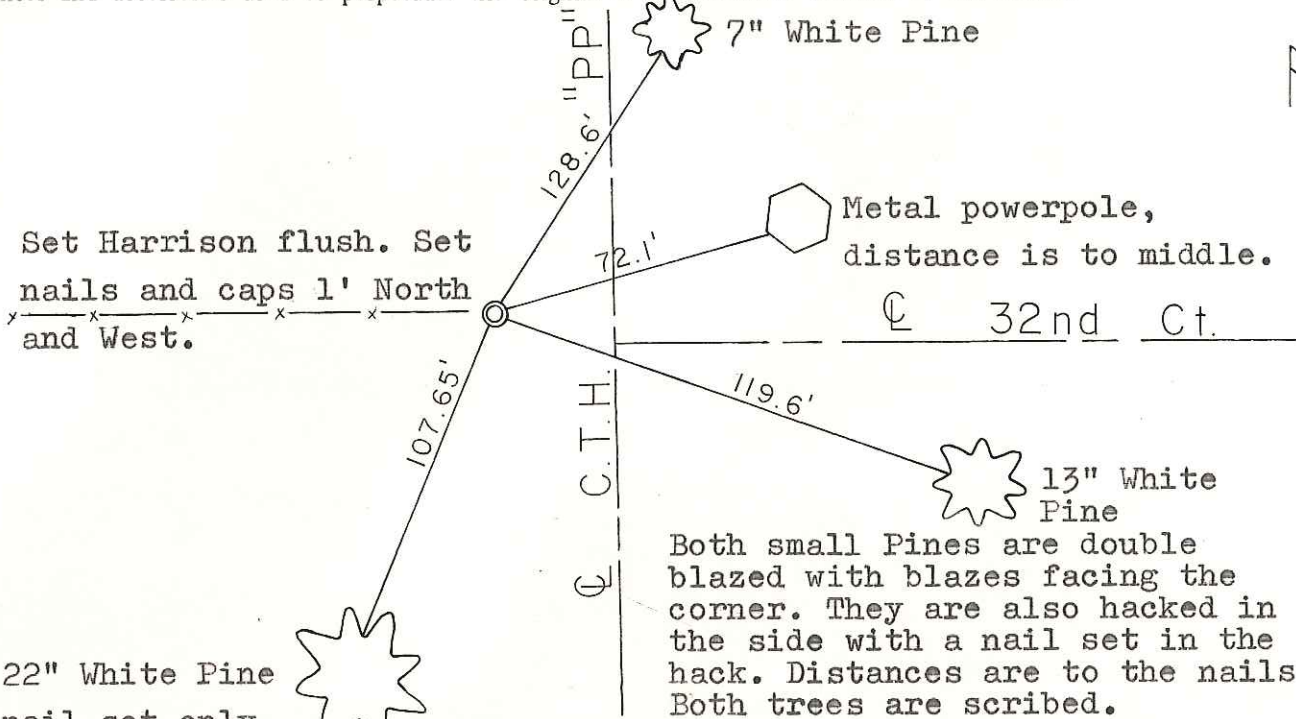

O = LOCATION CORNER

T 18 N R 1 E

WISCONSIN

COUNTY SURVEYOR FORM NO. 1

SURVEY CONTROL ORDER

Horizontal	_____
Vertical	_____

22" White Pine nail set only.

WISCONSIN COORDINATE SYSTEM

Corner	East (X)	North (Y)	Elevation (Z)	Zone
Control Sta. Name				

~~City, Village or~~ Town of Byron

County of Monroe