

4180120000

I, Bryan H. Meyer, do hereby certify that on the 12th day of August, 19 83, I found ~~no evidence~~ (no evidence) of the Northeast corner of Section 29, T 18 N, R 1 E Fourth Principal Meridian, and I re-established said corner according to the Wisconsin Statutes as shown and described hereon.

History of corner establishment since Original Government Survey

Nothing Recorded.

Description of corner evidence found:

I established this corner by double proportionate measurement.

Dated this 30th day of Dec. 19 83

Bryan H. Meyer

Deputy County Surveyor
Title

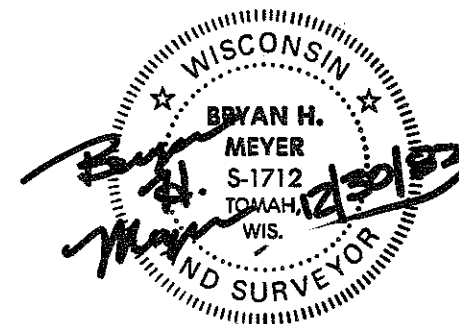

COUNTY SURVEYOR FORM NO. 1

Description of corner and witness monuments, references and accessories used to perpetuate the original or re-established location of this corner:

Crew: Meyer, Wilhite
Date: August 12, 1983 - 12:00 P.M.
Weather: P. Cloudy, Humid, 80°±.
Witnesses to corner location:

Bryan H. Meyer

Dallas Wilhite

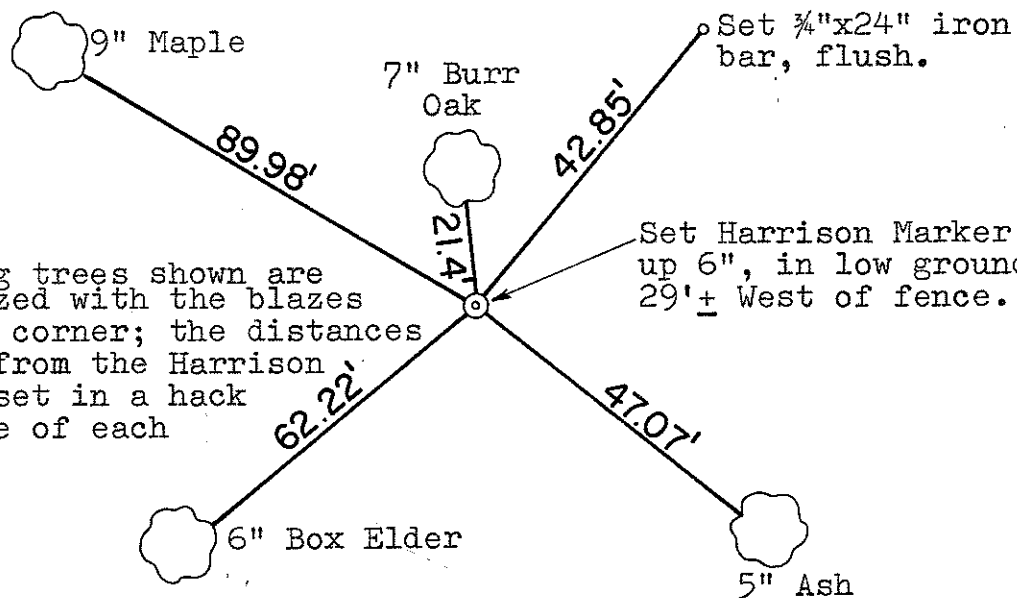

The bearing trees shown are double blazed with the blazes facing the corner; the distances shown are from the Harrison to a nail set in a hack in the side of each tree.

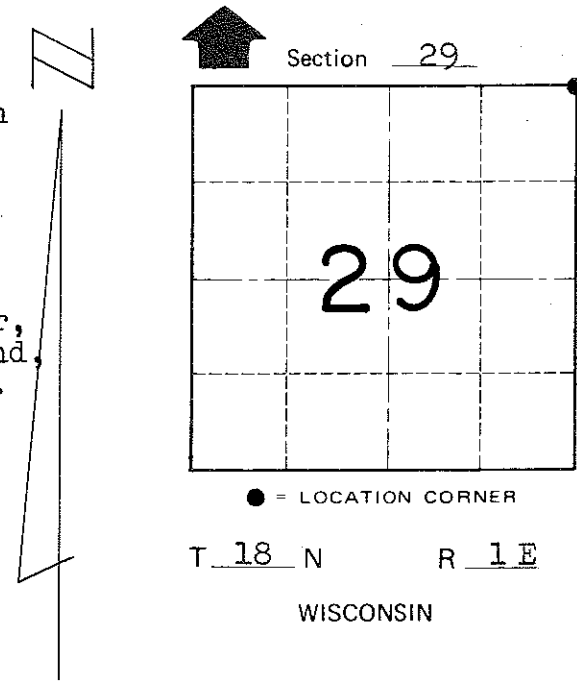

SURVEY CONTROL ORDER

Horizontal	_____
Vertical	_____

WISCONSIN COORDINATE SYSTEM

Corner	East (X)	North (Y)	Elevation (Z)	Zone
Control Sta. Name				

~~City, Village or~~ Town of Byron

County of Monroe