

21901162000

I, Harley A. Sime, do hereby certify that on the 12 day of July 19 76, I found (evidence) (no evidence) of the W 1/4 corner of Section 15, T 19 N, R 1W E, Fourth Principal Meridian, and I re-established said corner according to the Wisconsin Statutes as shown and described hereon.

Dated this 19 day of Sept. 19 77.

History of original corner establishment:

There is no known history since the original history.

Description of corner evidence found:

This corner was established by doubling the distance and on a straight line from the existing Harrison Monument at the northwest corner of said Section 15 and the W1/16NW (existing Iron Pipe) of said Section 15. This fit the existing East - West fence line at the 1/4 corner within 2.5 feet more or less.

County Surveyor
Title

Approved: HARLEY A. SIME
MONROE CO. SURVEYOR

Description of corner and witness monuments, references and accessories used to perpetuate the original or re-established location of this corner:

Witnesses to corner location:

G. Sime - Crew Chief *Harley A. Sime*

D. Dade

B. Meyer

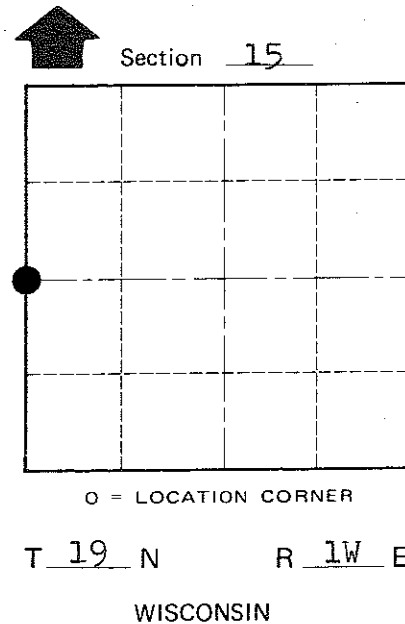
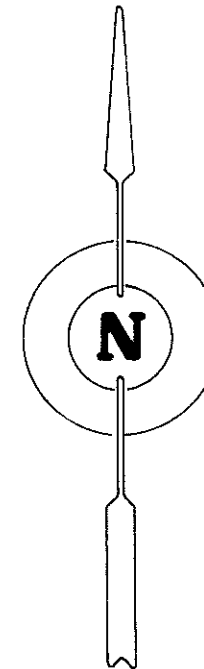
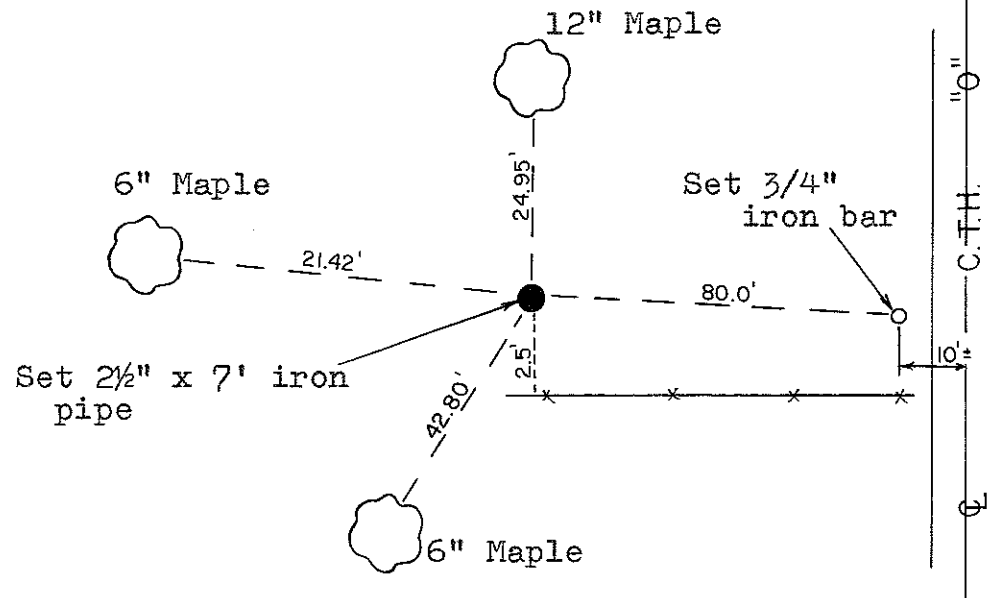

(All trees double blazed with nails & caps)

COUNTY SURVEYOR FORM NO. 1

SURVEY CONTROL ORDER

Horizontal	_____
Vertical	_____

WISCONSIN COORDINATE SYSTEM

Corner	East (X)	North (Y)	Elevation (Z)	Zone
Control Sta. Name				

City, Village or Town Lincoln
County of Monroe