

117

U.S. PUBLIC LAND CORNER MAINTENANCE

Corner ID : W1/4 Sec. 34, T18N-R1E

41801332000

DATE	CREW	MONUMENT TYPE -----
February 5, 2018	Zachariah P.Dechant Gary Dechant	Existing Harrison intact, at remnants of old fence corner. 170' south of westerly extension of Freeland Ave Set new sign 2' north

<u>References:</u>	<u>Bearing</u>	<u>Distance</u>
1) Set 3/4"x24" round iron bar, down 4", 4' SW of 12" Red Oak (BT)	N51E	27.58'
2) Set 3/4"x24" round iron bar, down 4, 4' SW of 3" White Pine	S14E	15.80'
3) Set 3/4"x24" round iron bar, flush", 4' south of 14" Red Oak	S80W	29.75'
4) Set 3/4"x24" round iron bar, down 4", 4' SE of 6" White Oak	N56W	35.63'



CERTIFICATE

CERTIFIED LAND CORNER

No. 117

41801332000

I, Lawrence A. Feddersen, do hereby certify that on the 1 day of December 19 77, I found (evidence) ~~(no evidence)~~ of the ~~W¹/₄~~ corner of Section 34, T 18 N, R 1 E, Fourth Principal Meridian, and I re-established said corner according to the Wisconsin Statutes as shown and described hereon.

Dated this 1 day of DEC. 19 77.

Lawrence A. Feddersen

Registered Land Surveyor
Title

History of original corner establishment:

In 1904 Fred Holden had set a stake at this corner, and had set stones in other locations in this section.

Description of corner evidence found:

A 9"x6"x19" stone with a chiseled cross on top, believed to have been set by Holden, was found at a fence corner at this corner location. A Harrison monument was set in place of the stone, which was moved 0.65' South of the Harrison.

Description of corner and witness monuments, references and accessories used to perpetuate the original or re-established location of this corner:

Witnesses to corner location:

Lawrence Feddersen
Mark Heidecke
Douglas Malliet

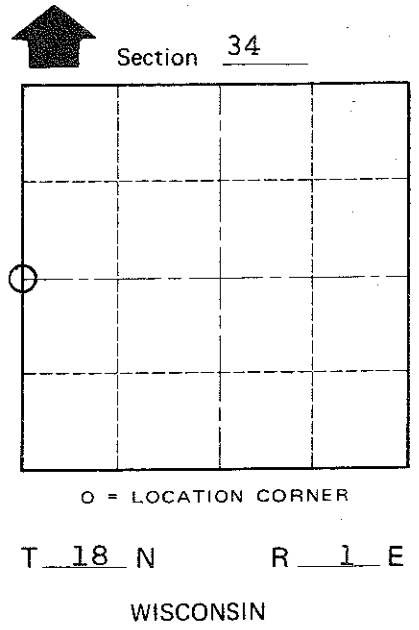
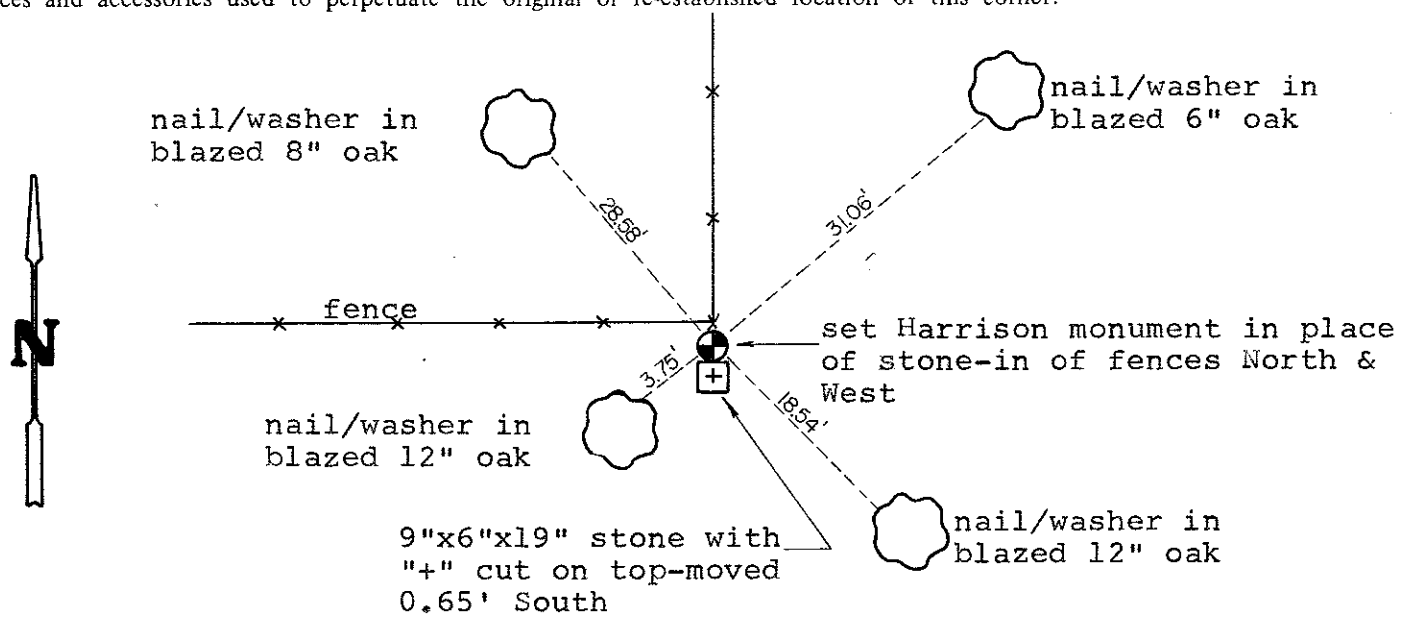

COUNTY SURVEYOR FORM NO. 1

SURVEY CONTROL ORDER

Horizontal	_____
Vertical	_____

WISCONSIN COORDINATE SYSTEM

Corner	East (X)	North (Y)	Elevation (Z)	Zone
Control Sta. Name				

~~XXXXXX~~ Town of Byron
County of Monroe