

# 7

# U.S. PUBLIC LAND CORNER MAINTENANCE

Corner ID : NW Sec.3, T17N-R1E

41801330000

| DATE        | CREW                                   | MONUMENT TYPE -----  |
|-------------|--|--|
| May 1, 2014 | Zachariah P.Dechant<br>Gary L. Dechant | Existing Harrison Monument<br>6' north centerline of Grosbeak Ave. |

References:

|  | <u>Bearing</u> | <u>Distance</u> |
|--|----------------|-----------------|
| 1) Set 3/4"x24" hex iron bar, centerline of power line, down 8"      | N38E           | 48.56'          |
| 2) Set 3/4"x24" hex iron bar 4' south of r/w fence, down 8"          | S27E           | 45.45'          |
| 3) Set 3/4"x24" hex iron bar 2' south of r/w fence, down 8"          | S38W           | 44.52'          |
| 4) Set 3/4"x24" hex iron bar middle of east-west power line, down 8" | N27W           | 48.10'          |
| 5) Existing 1" iron pipe   | North          | 33.03'          |

**COORDINATES:**

**NOTE:** Reference markers and Harrison set on straight lines

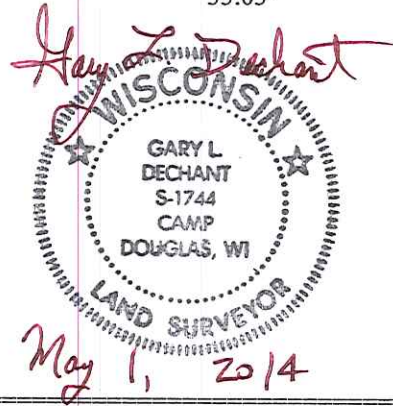

CERTIFICATE

CERTIFIED LAND CORNER

No. 127

41801330000

I, Harley A. Sime, do hereby certify that on the 23rd day of April 1974, I found (evidence) (~~no evidence~~) of the SW corner of Section 34, T18 N, R1 E, Fourth Principal Meridian, and I re-established said corner according to the Wisconsin Statutes as shown and described hereon.

History of original corner establishment:

Holden was at this corner in March of 1903, and in Feb. of 1901.

Description of corner evidence found:

Corner was set so as to match Herman Hovelsrud's survey of March 1973.

Dated this 9th day of Feb. 1978.

County Surveyor  
Title

**Approved: HARLEY A. SIME**  
**MONROE CO. SURVEYOR**

COUNTY SURVEYOR FORM NO. 1

Description of corner and witness monuments, references and accessories used to perpetuate the original or re-established location of this corner:

Set Harrison, down 4" in sand road.

Witnesses to corner location:

D. Marten

North

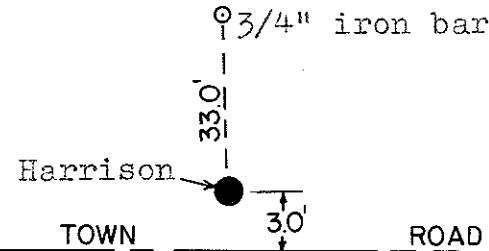

Section 34

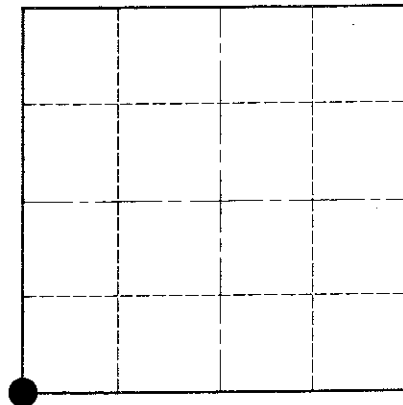

O = LOCATION CORNER

T 18 N R 1 E

WISCONSIN

PLACED  
COUNTY SURVEYOR'S  
SIGN 6-12-87

SURVEY CONTROL ORDER

|            |       |
|------------|-------|
| Horizontal | _____ |
| Vertical   | _____ |

WISCONSIN COORDINATE SYSTEM

| Corner            | East (X) | North (Y) | Elevation (Z) | Zone |
|-------------------|----------|-----------|---------------|------|
| Control Sta. Name |          |           |               |      |

City, Village or Town Byron

County of Monroe