

I, Harley A. Sime, do hereby certify that on the thirteenth day of May 19 82 I found (evidence) of the East 1/4 corner of Section 24, T 18 N, R 1 E Fourth Principal Meridian, and I re-established said corner according to the Wisconsin Statutes as shown and described hereon.

Dated this 26th day of May 19 82.

Harley A. Sime - R. L. S. 355

County Surveyor, Monroe County

Approved: HARLEY A. SIME

MONROE CO. SURVEYOR

COUNTY SURVEYOR FORM NO

Description of corner and witness monuments, references and accessories used to perpetuate the original or re-established location of this corner:

Set 3/4"x24" iron bar on Northeast side of tree. The tree is blazed on N-S-W-E sides. The bearing trees are double blazed with blazes facing the corner. They are also hacked in the side with a nail set in the hack. The distances are from the nails to the bar. THE TREE IS

Bryan Meyer-Crew Chief THE CORNER.

Gary Dechant

History of corner establishment since Original Government Survey Kennedy was here in Nov. of 1927 Schroeder was here in December of 1889. H.A. Sime was here in January of 1963 and used a Black Oak with a circumference of 6.17' as the corner.

Description of corner evidence found:

Found Sime's Black Oak with wire wrapped around and accepted it as the corner.

41801242000

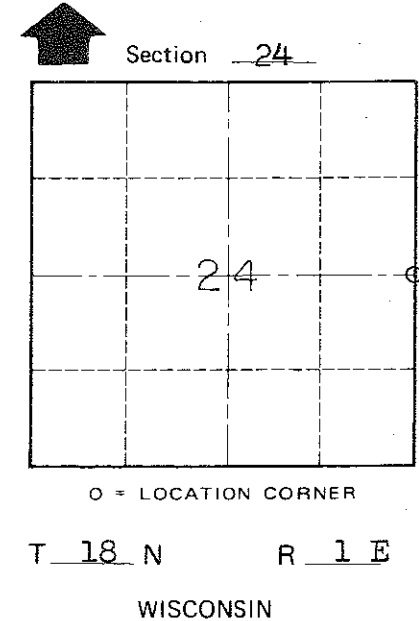
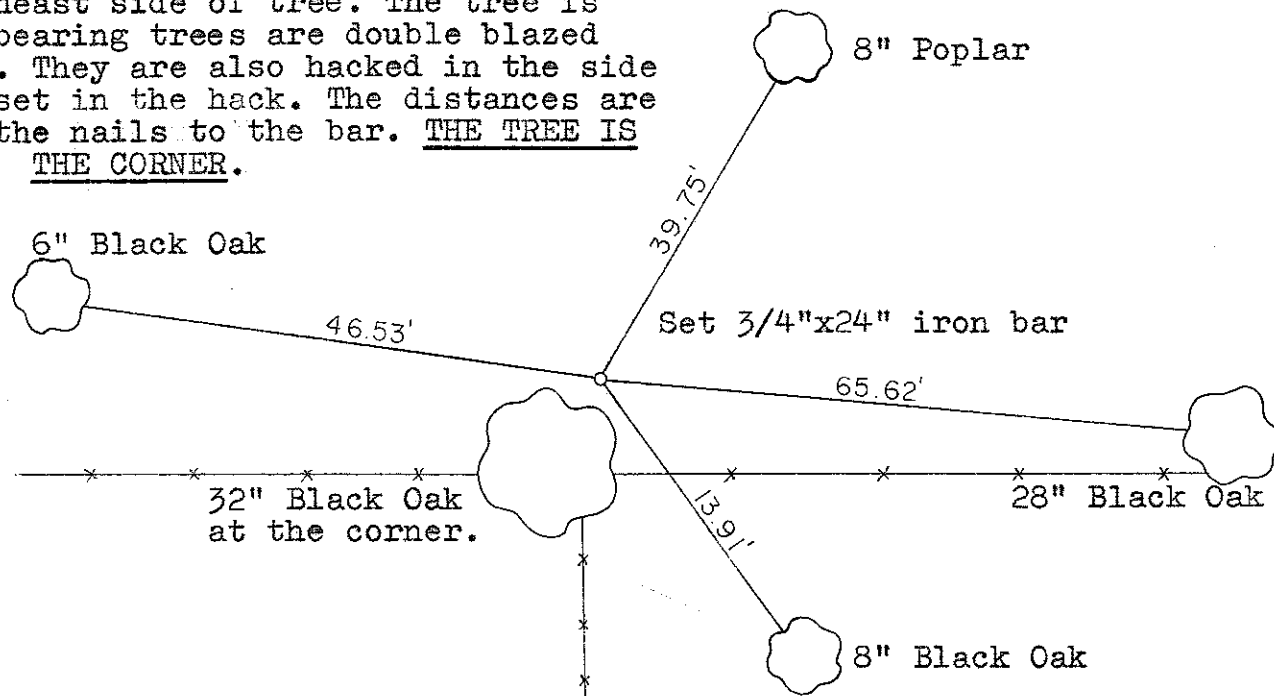
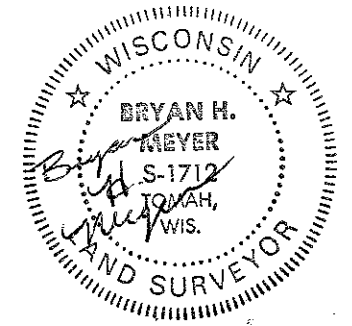

SURVEY CONTROL ORDER

Horizontal	_____
Vertical	_____

WISCONSIN COORDINATE SYSTEM

Corner	East (X)	North (Y)	Elevation (Z)	Zone
Control Sta. Name				

~~City~~ Town of Byron
County of Monroe