

#62

**U.S. PUBLIC LAND CORNER
MAINTENANCE**

Corner ID : S1/4 Sec. 13, T18N-R1E

41801130020

<u>DATE</u>	<u>CREW</u>	<u>MONUMENT TYPE -----</u>
October 23, 2017	Zachariah P. Dechant Gary L. Dechant	Existing Harrison intact 1.5' east of fence 140' south of Railroad. Set sign 1.5' west.

<u>References:</u>	<u>Bearing</u>	<u>Distance</u>
1) Set 3/4"x24" iron pipe, down 4"	N50E	16.91'
2) Set 3/4"x24" iron pipe, down 4", 5' west of 20" Black Oak (BT)	S50E	30.37'
3) Set 3/4"x24" iron pipe, down 10" in field	S66W	24.19
4) Set 3/4"x24" iron pipe, down 10" in field	N56W	26.13'



November 21, 2017

I, William Jung, do hereby certify that on the 1st day of June 1982, I found (evidence) ~~(no evidence)~~ of the South 1/4 corner of Section 13, T 18 N, R 1 E Fourth Principal Meridian, and I re-established said corner according to the Wisconsin Statutes as shown and described hereon.

Dated this 22nd day of Feb. 1983.

William C. Jung
Deputy County Surveyor
Title

History of corner establishment since Original Government Survey
No history recorded since the original government survey.

Description of corner evidence found:

After surveying out Section 13, I set the corner at a location that best fits the existing monuments and occupation in Section 13. The old railroad map calls for the corner being 141' South of the track centerline, and it is. I measure 2633.45' to the SW of Section 13, and the railroad map calls for 2636'. I measure 1316.82' to the S1/16SE of Section 13, and the railroad map calls for 1316'. This corner is 1.5' East of the fence, but 12.5' to the South of the corner is a 19" Black Oak with wire running through it. This oak is 1.6' East of the existing fence. Therefore the corner matches the older occupation.

See Reverse Side For Maintenance

Description of corner and witness monuments, references and accessories used to perpetuate the original or re-established location of this corner:

Witnesses to corner location:

William Jung
Bryan Meyer

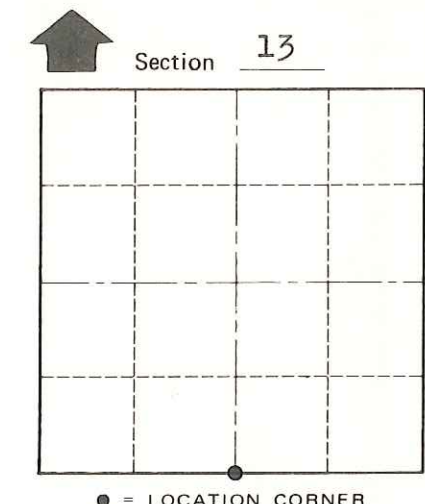
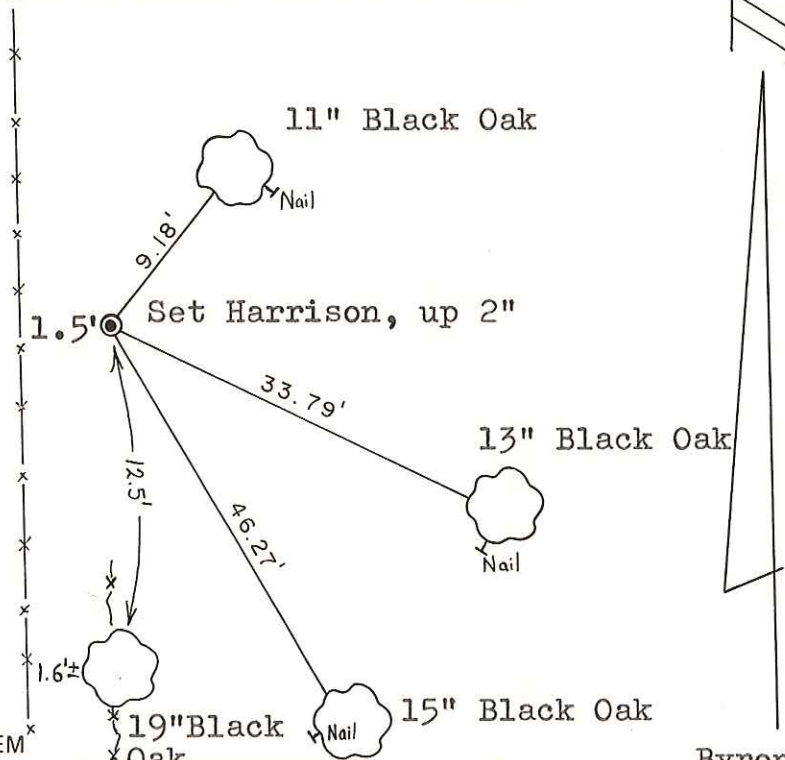
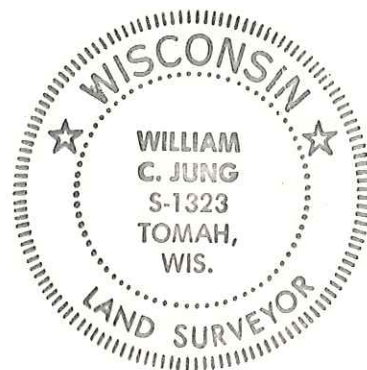

T 18 N R 1 E

WISCONSIN
PLACED
COUNTY SURVEYOR'S
SIGN 6-17-87

City, Village or Town Byron
County of Monroe

Approved: **HARLEY A. SIME**
MONROE CO. SURVEYOR

Note: All bearing trees are double blazed. Each distance is to a nail in a blaze on the side of the tree.

SURVEY CONTROL ORDER

Horizontal	_____
Vertical	_____

WISCONSIN COORDINATE SYSTEM

Corner	East (X)	North (Y)	Elevation (Z)	Zone
Control Sta. Name				

COUNTY SURVEYOR FORM NO. 1