

CERTIFICATE

CERTIFIED LAND CORNER

No. 63

21905140000

I, Harley A. Sime, do hereby certify that on the 8 day of April 1976, I found (evidence) (~~no evidence~~) of the SW corner of Section 13, T19 N, R 5W, Fourth Principal Meridian, and I re-established said corner according to the Wisconsin Statutes as shown and described hereon.
Dated this 7th day of Feb. 1978.

History of original corner establishment:

Description of corner evidence found:

Found existing Iron Pipe used in previous surveys.

County Surveyor
Title

Approved: HARLEY A. SIME
MONROE CO. SURVEYOR

COUNTY SURVEYOR FORM NO. 1

Description of corner and witness monuments, references and accessories used to perpetuate the original or re-established location of this corner:

Replaced existing Iron Pipe with Harrison Monument. Harrison down 2".

Witnesses to corner location:

Douglas Malliet, Crew Chief

W. C. Jung *W.C. Jung*

A. Lueck

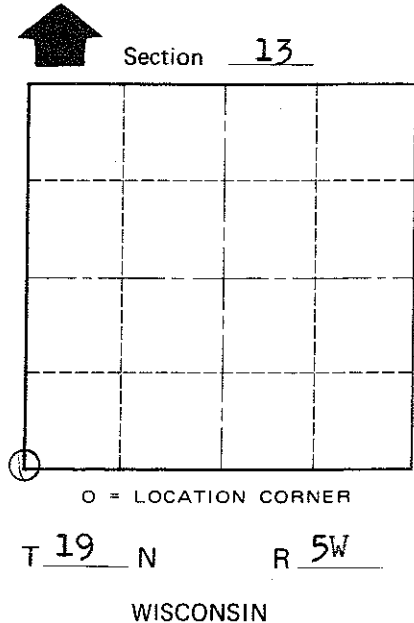
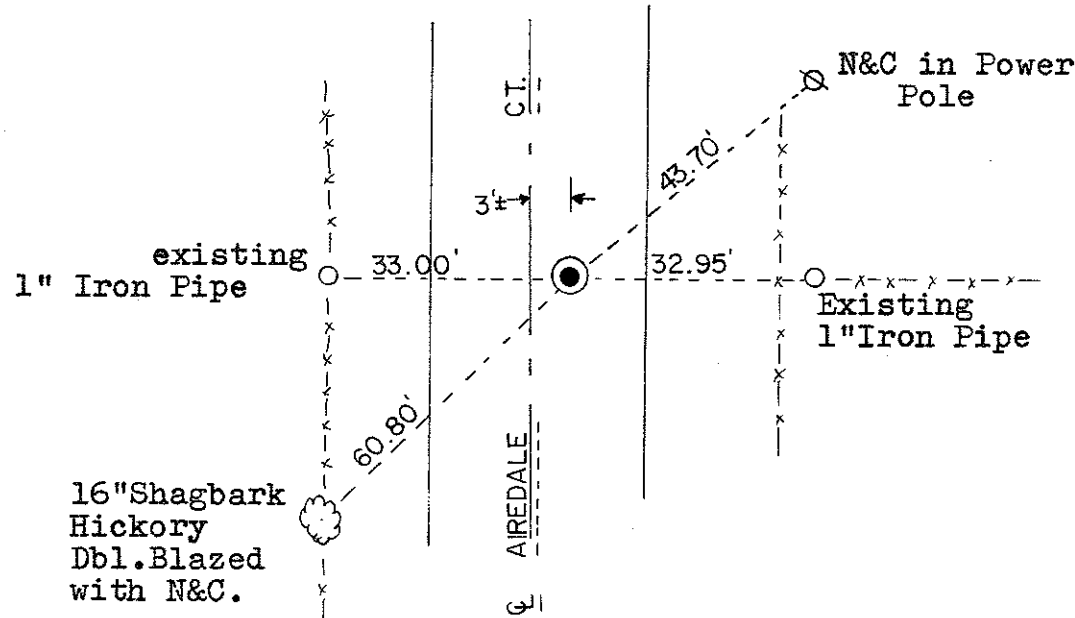

SURVEY CONTROL ORDER

Horizontal	_____
Vertical	_____

WISCONSIN COORDINATE SYSTEM

Corner	East (X)	North (Y)	Elevation (Z)	Zone
Control Sta. Name				

~~Little Falls~~ or Town Little Falls
County of Monroe