

CERTIFICATE

CERTIFIED LAND CORNER

No. 43

21905110000

I, Harley A. Sime, do hereby certify that on the 8 day of April 1976, I found (evidence) (~~at this site~~) of the NW corner of Section 13, T 19 N, R 5 W. Fourth Principal Meridian, and I re-established said corner according to the Wisconsin Statutes as shown and described hereon. Dated this 7TH day of Feb. 1978.

History of original corner establishment:

Schroeder was at this corner in November of 1890.

Description of corner evidence found:

Found Iron Pipe used in previous surveys and accepted it as the corner.

Approved: **HARLEY A. SIME**
MONROE CO. SURVEYOR

County Surveyor
Title

COUNTY SURVEYOR FORM NO. 1

Description of corner and witness monuments, references and accessories used to perpetuate the original or re-established location of this corner:

Replaced existing Iron Pipe with Harrison Monument.
Harrison down 6".

Witnesses to corner location:

Douglas Malliet, Crew Chief

W.C. Jung *W.C. Jung*

A. Lueck

SIGN PLACED 11/21/86
Meyer, Kenworthy

Road Sign
3/4" Iron Bar 1' South of Sign.

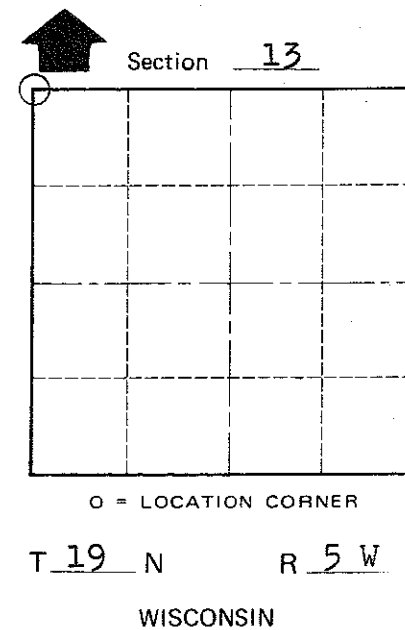
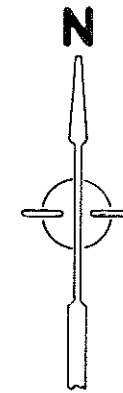
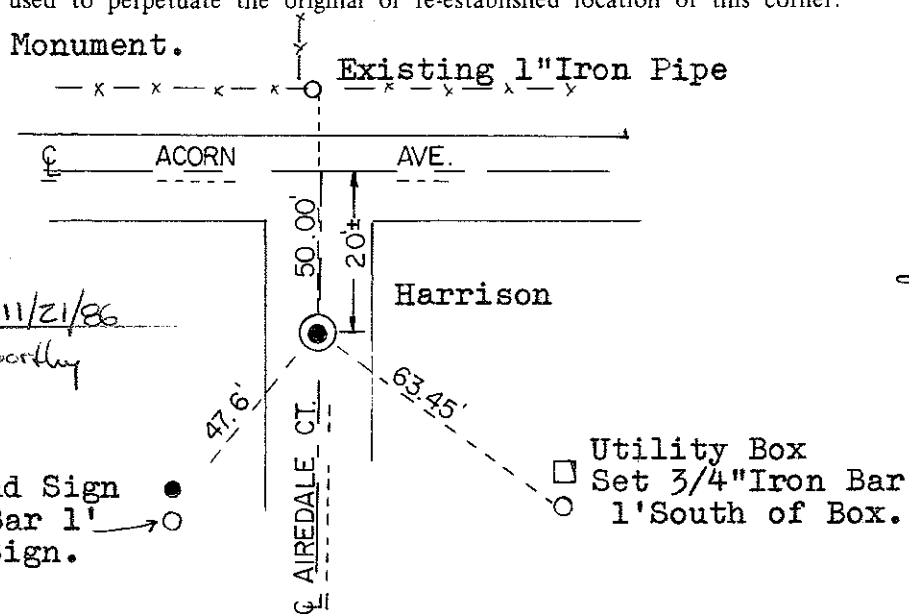

SURVEY CONTROL ORDER

Horizontal	_____
Vertical	_____

WISCONSIN COORDINATE SYSTEM

Corner	East (X)	North (Y)	Elevation (Z)	Zone
Control Sta. Name				

City, Village or Town Little Falls

County of Monroe