

CERTIFICATE

CERTIFIED LAND CORNER

21905020020

No. 24

I, Mark C. Carlson, do hereby certify that on the 16th day of April, 2010, I found (evidence) (no evidence) of the S1/4 corner of Section 2, T 19 N, R 5 W Fourth Principal Meridian, and I re-established said corner according to the Wisconsin Statutes as shown and described hereon.

Dated this 5th day of May 2010.

Mark C Carlson

Registered Land Surveyor S-2021 Title

History of corner establishment since Original Government Survey

Surveyor Keach surveyed north from S1/4 corner to N1/4 corner and set a random C1/4 on N-S 1/4 line in 1909. Surveyor Ray Hurlburt ran between E1/4 and W1/4 corners and set true C1/4 corner in 1959 based on Keach's random C1/4 corner. Surveyor Hurlburt also staked a parcel for Zielsdorf at the time. Hurlburt surveyed for Floyd Brown in 1966 and checked into the C1/4 corner. He adjusted some stakes set earlier. Surveyor Ken Carlson could not find Hurlburt's C1/4 corner and reset the C1/4 corner from stakes found from Zielsdorf and Brown surveys.

The distance between the current monuments at the SE and SW corners of Section 2 is 5106.76 feet as measured by GPS. This compares with the original government survey distance of 79 chains, 5215 feet. Th. S1/4 was set at the intersection of a straight line connecting the monuments at the SE and SW corners of Section 2 with the extension of a line from the monuments at the N1/4 corner through the C1/4 corner. The resulting intersection position is 6.65' west of splitting the distance between existing SE and SW corner monuments.

Description of corner and witness monuments, references and accessories used to perpetuate the original or re-established location of this corner:

Witnesses to corner location:

Dick Hilliker

Jacob Kyser

Mark C Carlson

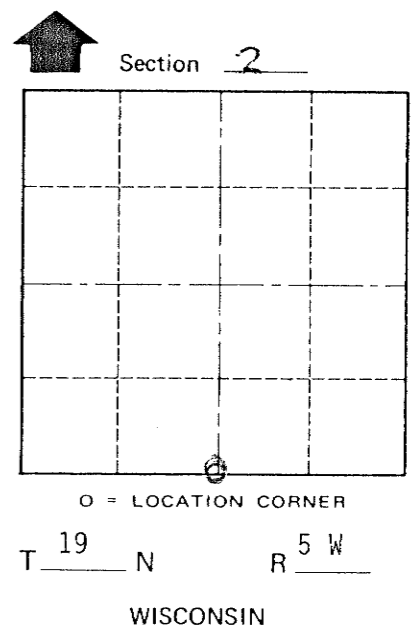
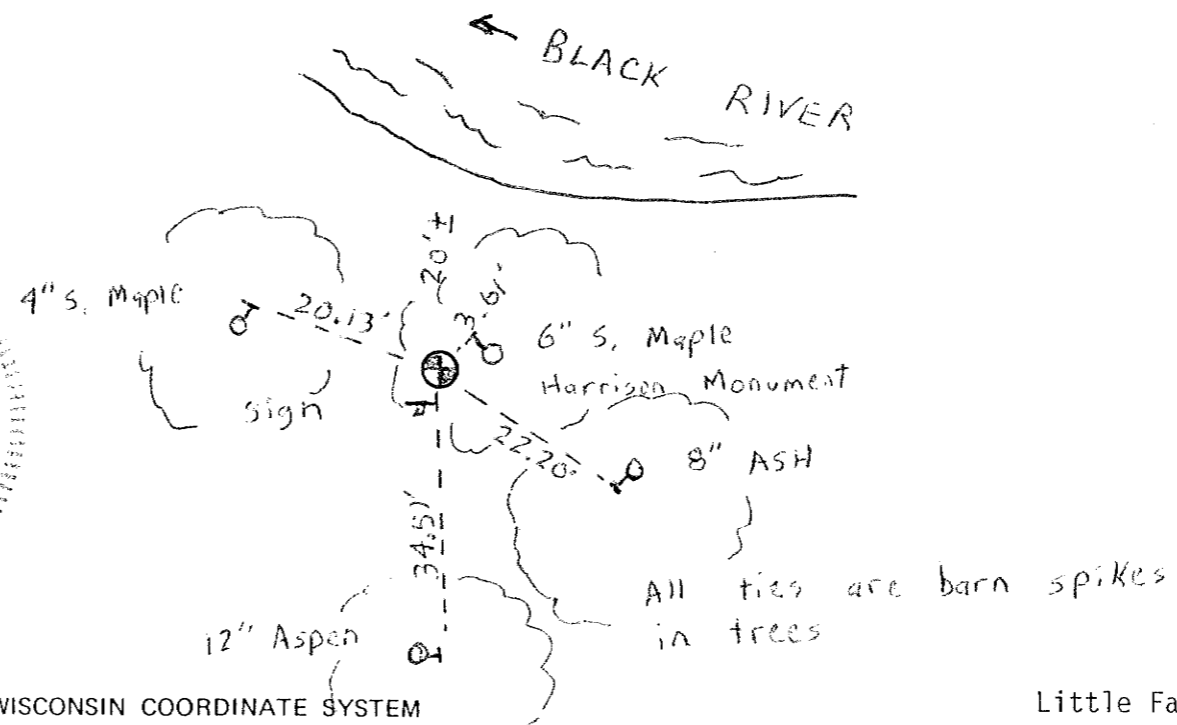
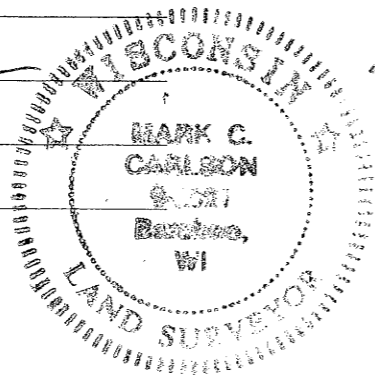

SURVEY CONTROL ORDER

Table with 2 rows: Horizontal, Vertical.

WISCONSIN COORDINATE SYSTEM

Table with 5 columns: Corner, East (X), North (Y), Elevation (Z), Zone. Row 1: Control Sta. Name.

Little Falls City, Village or Town
County of Monroe

COUNTY SURVEYOR FORM NO. 1