

CERTIFICATE

CERTIFIED LAND CORNER

No. 594

21905143000

I, Harley A. Sime, do hereby certify that on the 8 day of April 19 76, I found ~~(no evidence)~~ (no evidence) of the W1/16NW corner of Section 13, T 19 N, R 5 W Fourth Principal Meridian, and I re-established said corner according to the Wisconsin Statutes as shown and described hereon.

History of original corner establishment:

Description of corner evidence found:

Dated this 7<sup>TH</sup> day of Feb. 19 78.

After surveying out section 13, I set the W1/16NW corner by Law.

Approved: **HARLEY A. SIME**  
**MONROE CO. SURVEYOR**

County Surveyor

Description of corner and witness monuments, references and accessories used to perpetuate the original or re-established location of this corner:  
Set 3/4"x 24" Iron Bar East edge of Gravel Roadway.

Witnesses to corner location:

Douglas Malliet, Crew Chief  
W.C. Jung *W.C. Jung*  
A. Lueck

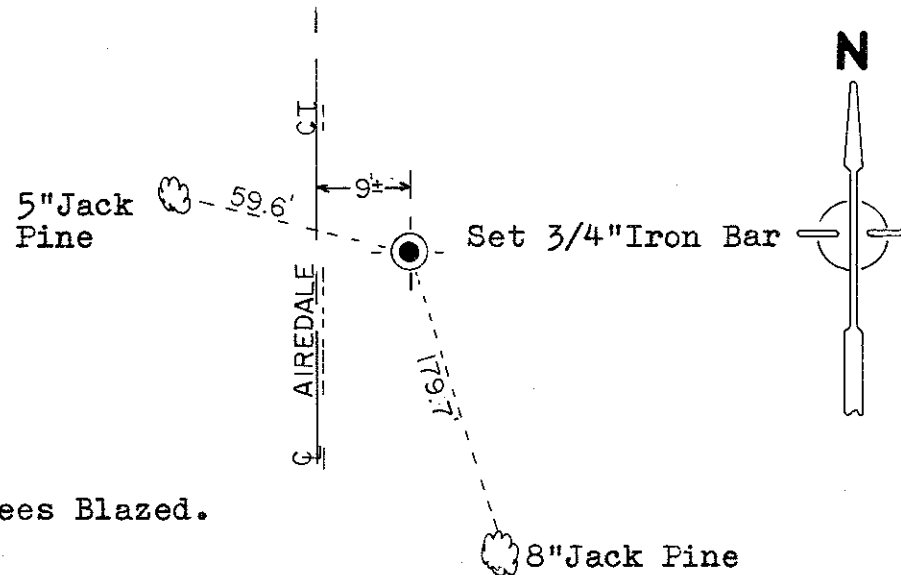

All trees Blazed.

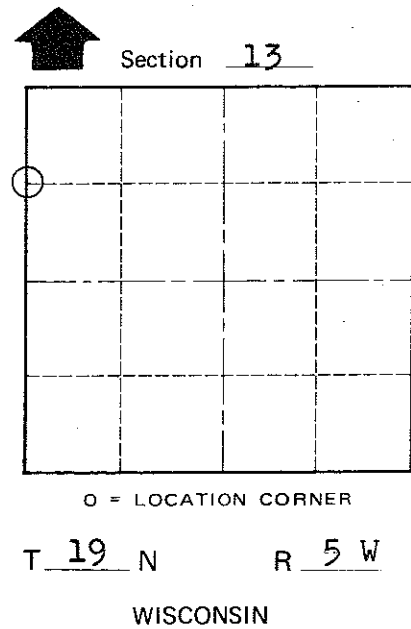

COUNTY SURVEYOR FORM NO. 1

SURVEY CONTROL ORDER

Horizontal \_\_\_\_\_  
Vertical \_\_\_\_\_

WISCONSIN COORDINATE SYSTEM

Corner	East (X)	North (Y)	Elevation (Z)	Zone
Control Sta. Name				

~~Little Falls~~ Town Little Falls

County of Monroe