

21904050000

I, Harley A. Sime, do hereby certify that on the tenth day of August 1981, I found (evidence) ~~XXXXXXXXXX~~ of the Southwest corner of Section 4, T 19 N, R 4W ~~xx~~ Fourth Principal Meridian, and I re-established said corner according to the Wisconsin Statutes as shown and described hereon.

Dated this 31st day of Aug. 1981.

Harley A. Sime

Monroe County Surveyor

Approved: ^{Title} HARLEY A. SIME
MONROE CO. SURVEYOR

Description of corner and witness monuments, references and accessories used to perpetuate the original or re-established location of this corner:

Witnesses to corner location:

Bryan H. Meyer - Crew Chief

Carlton R. Pietz

History of original corner establishment:
 Schroeder was here in May of 1886. Schroeder was here again in May of 1893.

Description of corner evidence found:

Found stone in the shape of a "t". Also found what could be one of Schroeder's bearing trees. Duke Marten, in his research of a job in Section 5, shows a stone at this corner.

COUNTY SURVEYOR FORM NO. 1

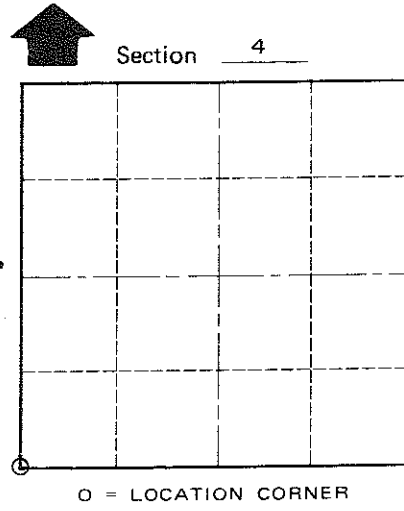
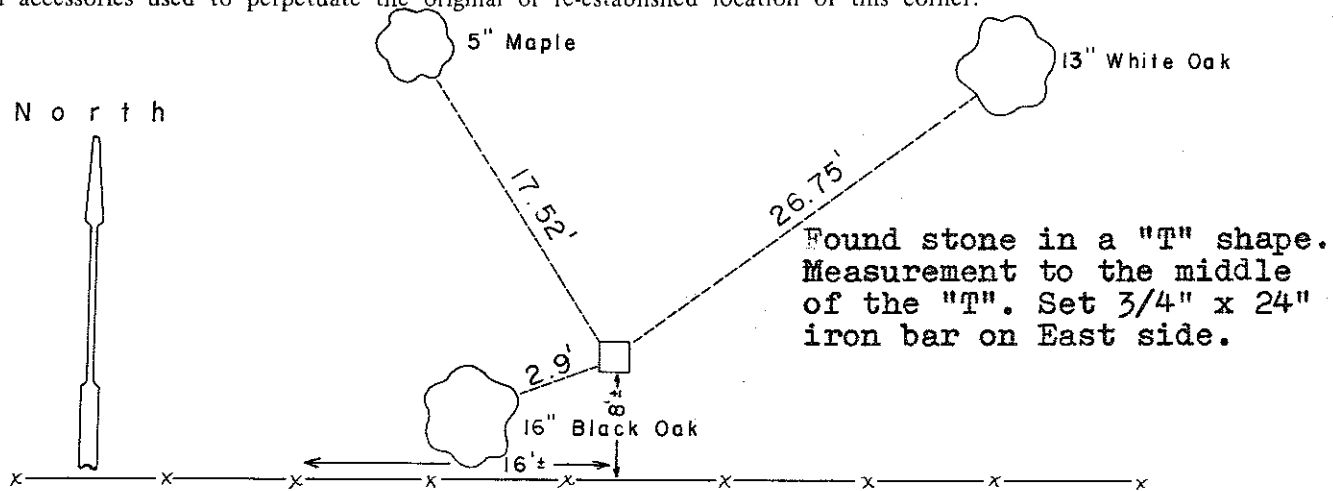

Note: Trees are double blazed with a nail set in the lower blaze of the Maple. Nothing was set in the Oaks.

SURVEY CONTROL ORDER

Horizontal	_____
Vertical	_____

WISCONSIN COORDINATE SYSTEM

Corner	East (X)	North (Y)	Elevation (Z)	Zone
Control Sta. Name				

~~City/Village~~ Town of Little Falls
 County of Monroe