

I, Harley A. Sime, do hereby certify that on the 26th day of October 1981, I found (evidence) (~~was~~) of the SE corner of Section 3, T 19 N, R 4 W Fourth Principal Meridian, and I re-established said corner according to the Wisconsin Statutes as shown and described hereon.

Dated this 29th day of Oct. 1981.

Harley A. Sime, R.L.S. 355

County Surveyor

Title

History of corner establishment since Original Government Survey Keach set a stone(+) here in 1902. Holden was here in October of 1904 and in October of 1909, he found a stone pile. Stone(+) found and verified by Blencoe in November of 1929.

Description of corner evidence found:

Found a stone(+) with other stones around it, ties were taken.

COUNTY SURVEYOR FORM NO. 1

Description of corner and witness monuments, references and accessories used to perpetuate the original or re-established location of this corner:

Witnesses to corner location:

G. Dechant

B. Meyer

C. Pietz

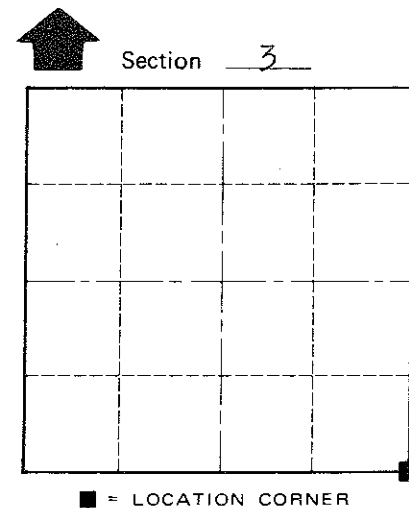
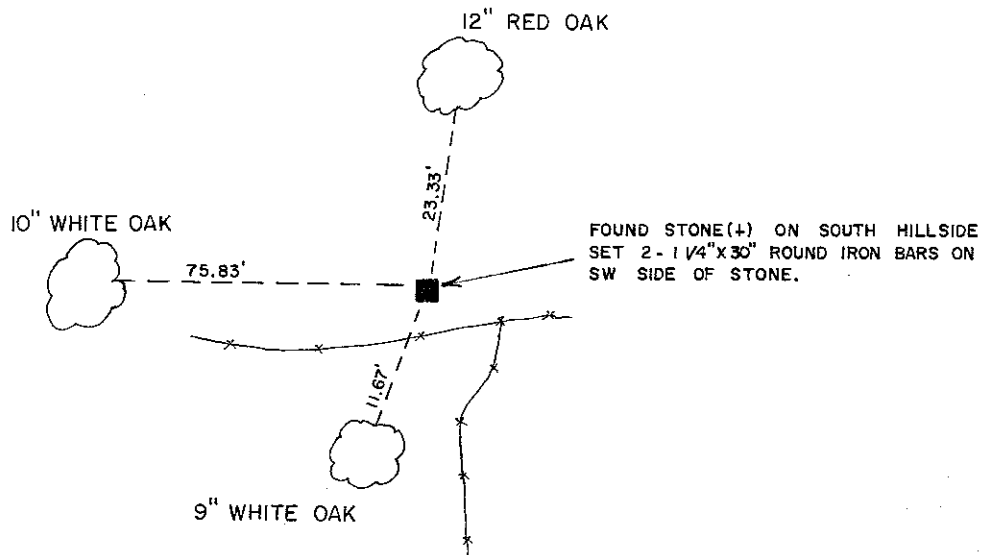

T 19 N R 4 W
WISCONSIN

Approved: **HARLEY A. SIME**
MONROE CO. SURVEYOR

SURVEY CONTROL ORDER

Horizontal	_____
Vertical	_____

WISCONSIN COORDINATE SYSTEM

Corner	East (X)	North (Y)	Elevation (Z)	Zone
Control Sta. Name				

(Trees double blazed with nails set)

City, Village or Town Little Falls

County of Monroe