

21904062000

I, William C. Jung, do hereby certify that on the 15th day of December 1982, I found ~~(evidence)~~ (no evidence) of the West 1/4 corner of Section 5, T 19 N, R 4 W Fourth Principal Meridian, and I re-established said corner according to the Wisconsin Statutes as shown and described hereon.

Dated this 28th day of Dec. 19 83.

William C. Jung

Deputy County Surveyor
Title

History of corner establishment since Original Government Survey
Schroeder reset this corner in April of 1893. In October of 1972, Zietlow computed a location for this corner after surveying out Section 5. This location fit his field evidence very well.

Description of corner evidence found:

Approved: **HARLEY A. SIME**
MONROE CO. SURVEYOR

I set a Harrison marker at Zietlow's computed 1/4 corner location.

COUNTY SURVEYOR FORM NO. 1

Description of corner and witness monuments, references and accessories used to perpetuate the original or re-established location of this corner:

Witnesses to corner location:

William C. Jung

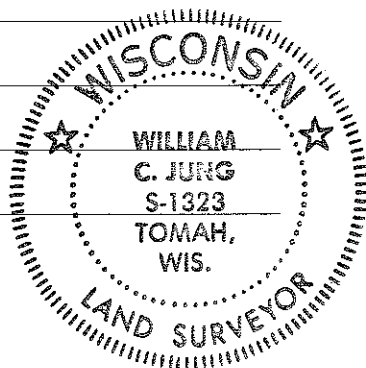

Set Harrison, flush, 3' W. N48°E of fence, 9" N. of steel fence post.

All B.T.'s double blazed; each dist. is to a nail in a hack on the side of the tree.

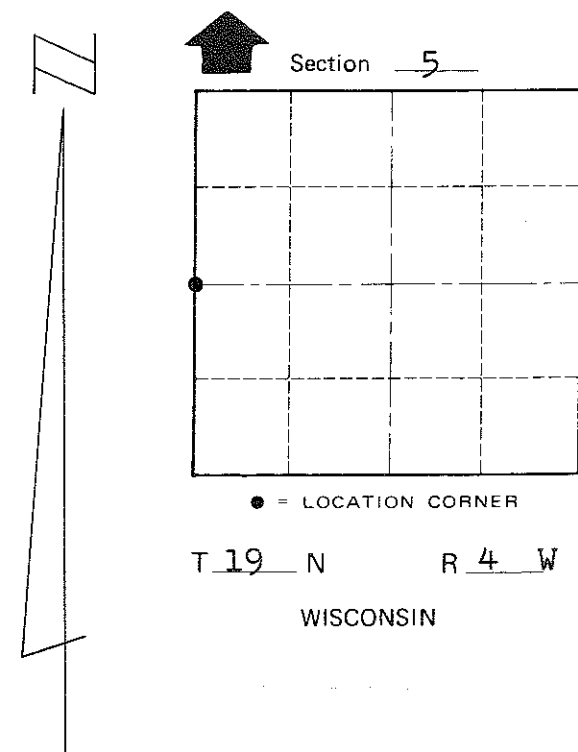
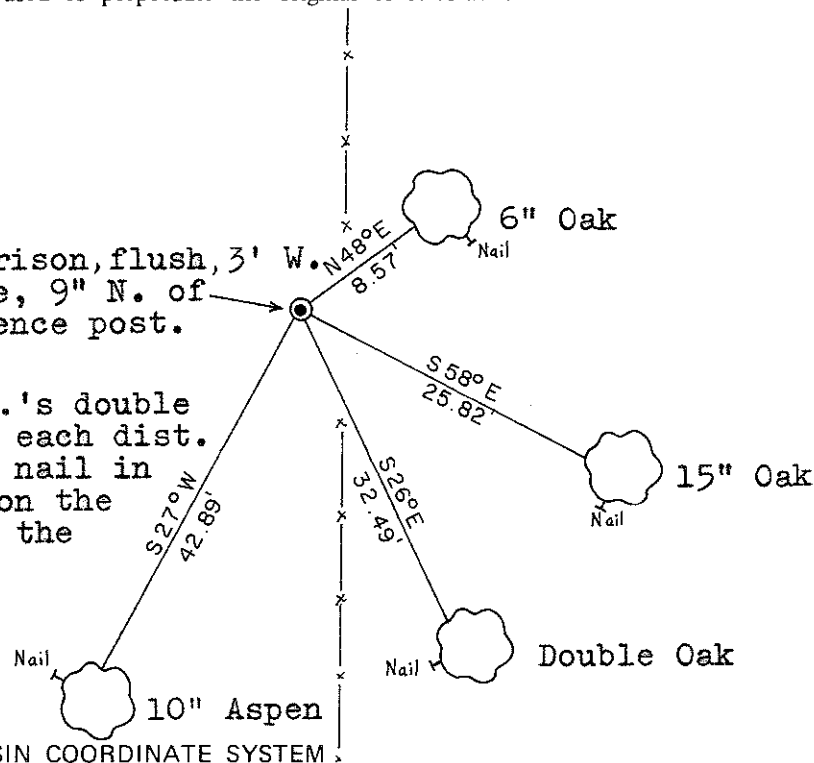

SURVEY CONTROL ORDER

Horizontal	_____
Vertical	_____

Corner	East (X)	North (Y)	Elevation (Z)	Zone
Control Sta. Name				

~~City, Village or~~ Town of Little Falls
County of Monroe