

21904130020

I, Harley A. Sime, do hereby certify that on the sixth day of April 1982, I found (evidence) of the North 1/4 corner of Section 24, T. 19 N, R. 4 W Fourth Principal Meridian, and I re-established said corner according to the Wisconsin Statutes as shown and described hereon.

History of corner establishment since Original Government Survey
Schroeder was here in May of 1886. D.L. Mulock was here the Spring of 1967, and set a 1"x24" iron pipe. A crew from the County Surveyor's office was here in May of 1980, and found a 1" pipe laying flat. Description of corner evidence found:

Set corner to best fit existing surveys in the area.

Dated this 19th day of April 1982.

Harley A. Sime R.L.S. 355

County Surveyor-Monroe County, Wisconsin

Approved: **HARLEY A. SIME**

MONROE CO. SURVEYOR

Description of corner and witness monuments, references and accessories used to perpetuate the original or re-established location of this corner:

Witnesses to corner location:

Bryan Meyer

Gary Dechant

COUNTY SURVEYOR FORM NO. 1

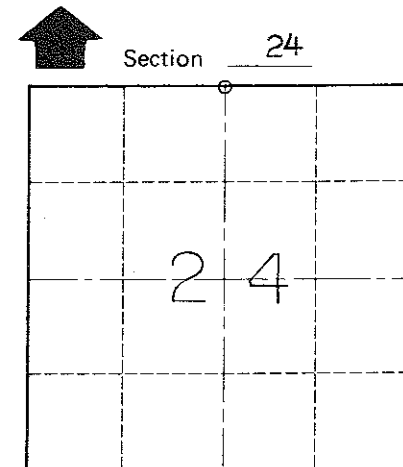
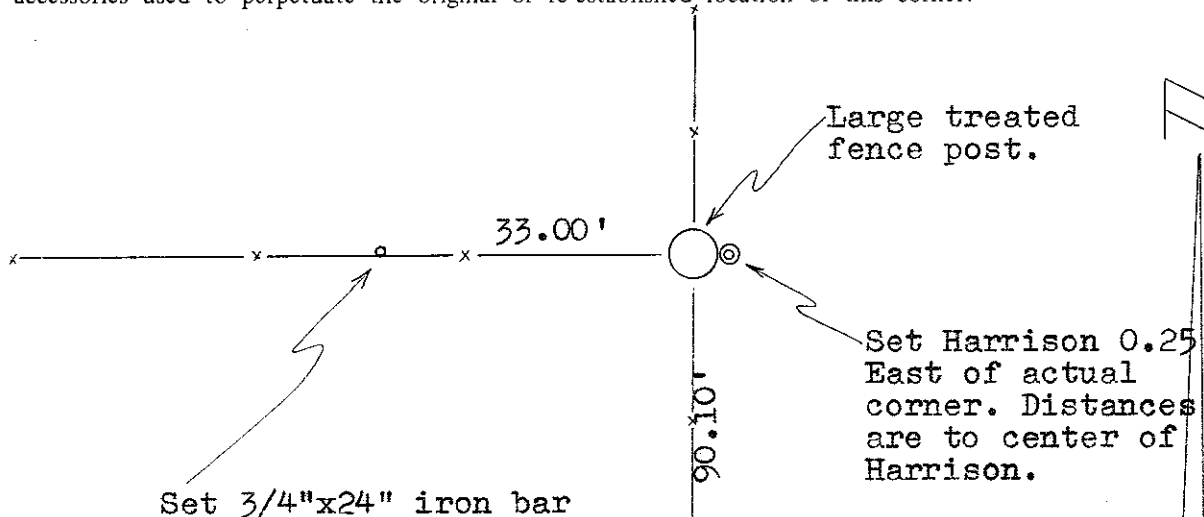

O = LOCATION CORNER

T 19 N R 4 W
WISCONSIN

NOTE: No other good ties in the area.

WISCONSIN COORDINATE SYSTEM

14" Burr Oak-double blazed Hacked in the side with a nail set in hack. Distance is to nail.

SURVEY CONTROL ORDER

Horizontal	_____
Vertical	_____

Corner	East (X)	North (Y)	Elevation (Z)	Zone
Control Sta. Name				

~~City, Village or~~ Town of Little Falls
County of Monroe

