

CERTIFICATE

UPDATED
CERTIFIED LAND CORNER

21904212000

No. 77

Page 2

I, Harley A. Sime, do hereby certify that on the 8 day of November 1975, I found (evidence) ~~(no evidence)~~ of the E 1/4 corner of Section 21, T 19 N, R 4 W, Fourth Principal Meridian, and I re-established said corner according to the Wisconsin Statutes as shown and described hereon.

History of original corner establishment:

Holden was at this corner in 1908.

Description of corner evidence found:

I found a 1 1/2" Iron Pipe, down 2.4' in the road.

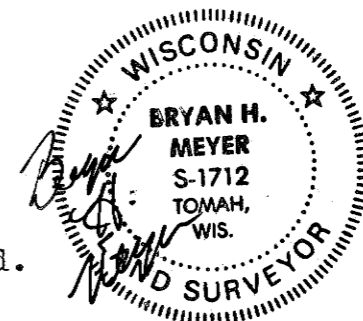

H. A. Sime and Assoc.
P. O. Box 50
Tomah, Wisconsin 54660
Phone: (608)-372-5392

Dated this _____ day of _____ 19____.

UPDATE: Found the monument at this corner location in good condition. Established ties as illustrated below.

Bryan Meyer, R.L.S. #1712, 29 August 1995

County Surveyor
Title

Description of corner and witness monuments, references and accessories used to perpetuate the original or re-established location of this corner:

Set a Harrison Monument over the top of this existing Iron Pipe. Harrison down 2" and 4'± East of West shoulder of road.

Witnesses to corner location:

William C. Jung, Crew Chief

A. Lueck

CREW:

Bryan Meyer
Harold Haberlin
29 August 1995

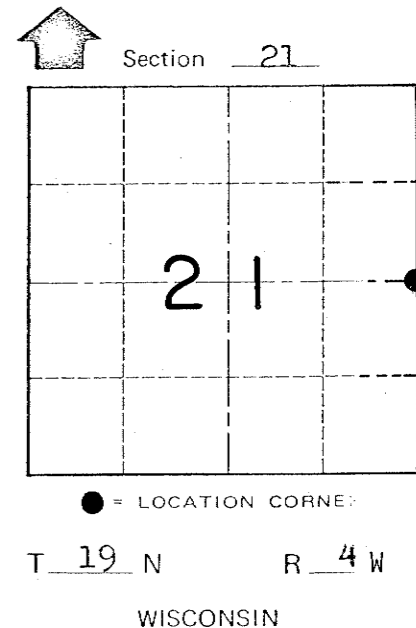
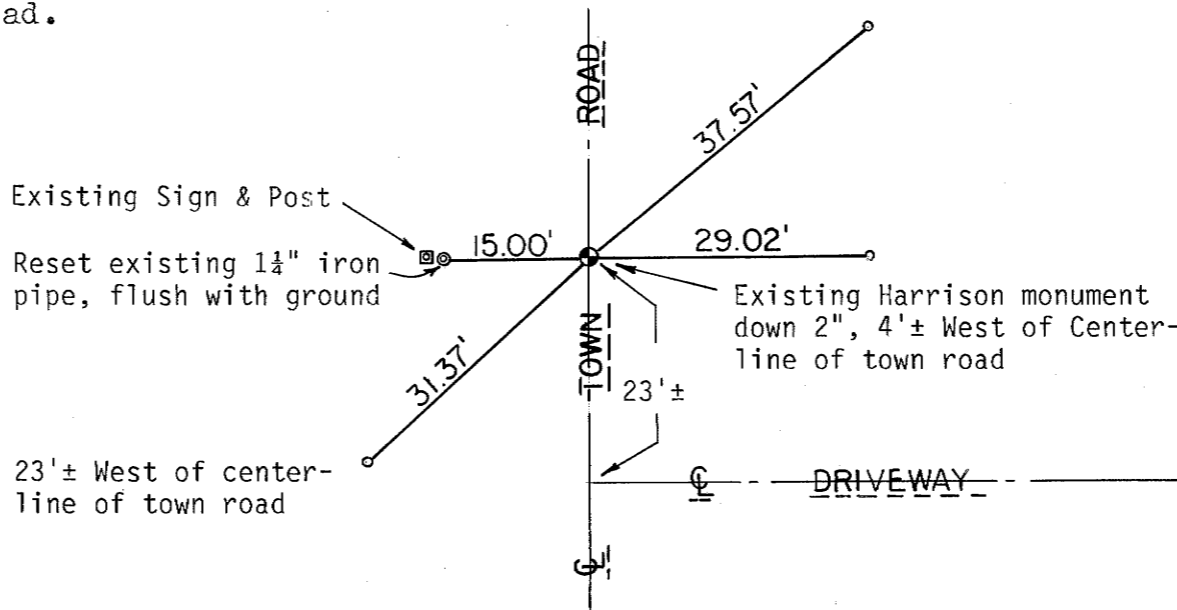
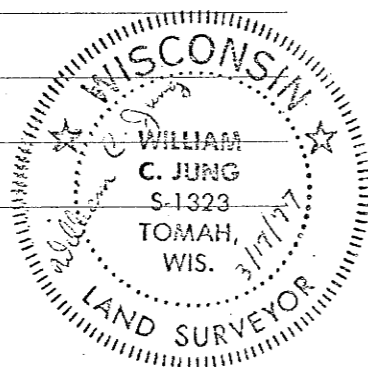

Ref. file number 4367

o = Set 3/4"x24" round iron bar

SURVEY CONTROL ORDER

Horizontal	_____
Vertical	_____

WISCONSIN COORDINATE SYSTEM

Corner	East (X)	North (Y)	Elevation (Z)	Zone
Control Sta. Name				

~~Little Falls~~ or Town Little Falls
County of Monroe

COUNTY SURVEYOR FORM NO. 1