

21904250000

I, Garold A. Sime, do hereby certify that on the 10th day of April 1989, I found ~~(evidence)~~ (no evidence) of the Northeast corner of Section 36, T 19 N, R 4 W Fourth Principal Meridian, and I re-established said corner according to the Wisconsin Statutes as shown and described hereon.

Dated this 7th day of July 1989.

Garold A. Sime

Garold A. Sime, Monroe County Surveyor  
Title

History of corner establishment since Original Government Survey

O. R. Dahl was at this corner in August of 1868.  
W. Kenyon was at this corner in May of 1893.  
F. W. Zietlow had a computed location for this corner in April of 1971.

Description of corner evidence found:

I set this corner on line with the Northeast and East 1/4 corners of Sec.25-T19N-R4W and at a distance from the East 1/4 corner that is equal to the distance between said Northeast and East 1/4 corners. This location fits the North - South fence found at the west line of the NE1/4-NE1/4 of said Section 36.

COUNTY SURVEYOR FORM NO. 1

Description of corner and witness monuments, references and accessories used to perpetuate the original or re-established location of this corner

Set Harrison Monument down 15" in field

Witnesses to corner location:

Garold A. Sime R. L. S.

Brian Forsythe

**H. A. SIME & ASSOC.**

**Surveying & Land Planning**

1819 Stoughton Ave. - P.O. Box 703

TOMAH, WI 54660

608-372-5392

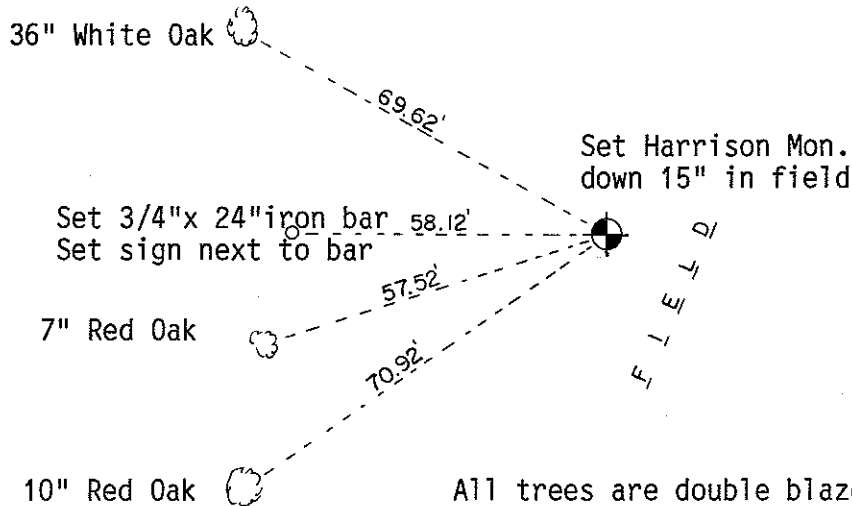

All trees are double blazed and distances are to nail set in hack in side of tree

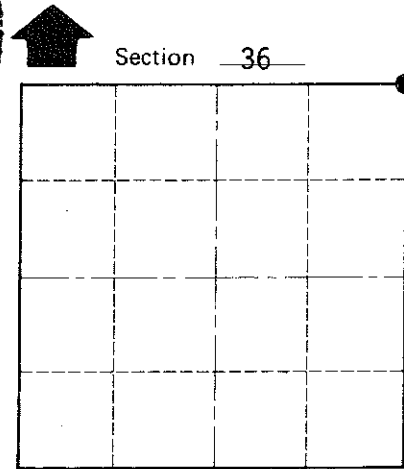

O = LOCATION CORNER

T 19 N R 4 W

WISCONSIN

SURVEY CONTROL ORDER

Horizontal	_____
Vertical	_____

WISCONSIN COORDINATE SYSTEM

Corner	East (X)	North (Y)	Elevation (Z)	Zone
Control Sta. Name				

City, Village or Town of Little Falls  
County of Monroe