

CERTIFICATE

CERTIFIED LAND CORNER

No. 87

21904210000

I, Harley A. Sime, do hereby certify that on the 3 day of November 19 75, I found (evidence) ~~the monument~~ of the SE corner of Section 21, T 19 N, R 4W, Fourth Principal Meridian, and I re-established said corner according to the Wisconsin Statutes as shown and described hereon. Dated this 17th day of March 19 77.

History of original corner establishment:

This corner was visited by surveyors in 1908 & 1911, but no mention was made as to the type of monument set.

Description of corner evidence found:

Found a 1" Iron Pipe here, which fit the Section. Accepted it and set a Harrison Monument in its place. Set an oak post by the Harrison, up 3'.

Approved: **HARLEY A. SIME**

County Surveyor **MONROE CO. SURVEYOR**

Description of corner and witness monuments, references and accessories used to perpetuate the original or re-established location of this corner:

Set Harrison Monument in place of existing 1" Iron Pipe, Set an oak post by the Harrison, up 3'.

Witnesses to corner location:

William C. Jung, Crew chief

A. Lueck

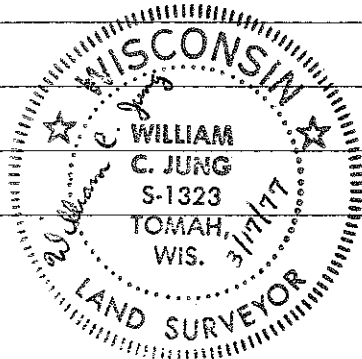

All trees blazed and N&C set

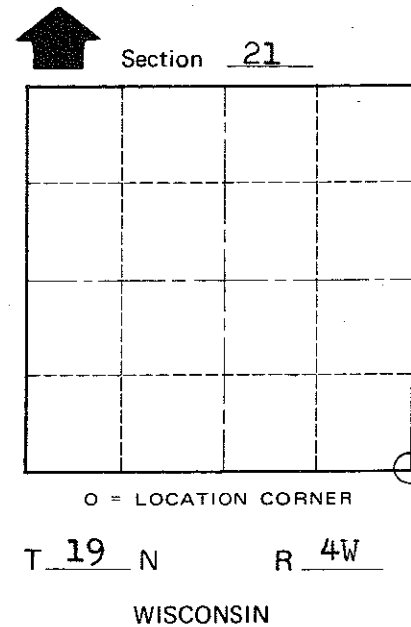
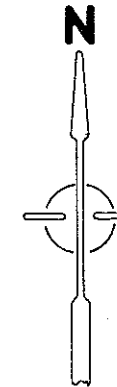
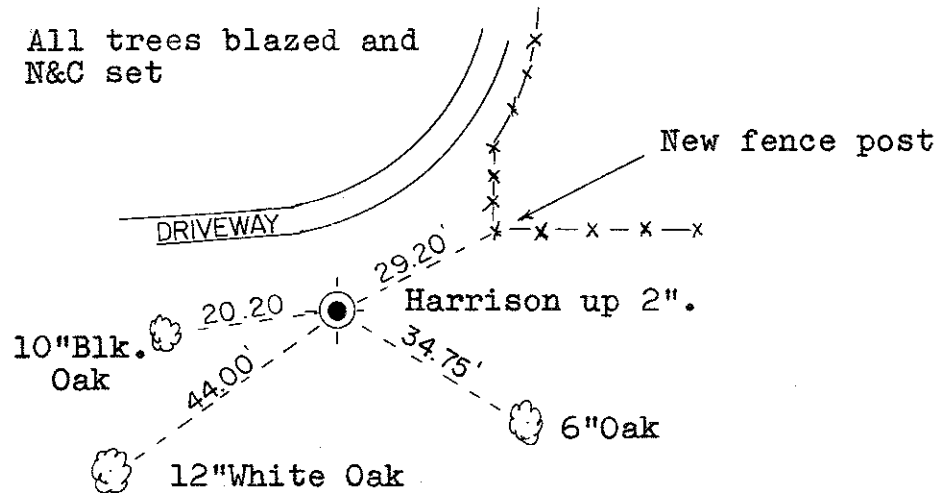

SURVEY CONTROL ORDER

Horizontal	_____
Vertical	_____

WISCONSIN COORDINATE SYSTEM

Corner	East (X)	North (Y)	Elevation (Z)	Zone
Control Sta. Name				

~~City/Town~~ or Town Little Falls
County of Monroe

COUNTY SURVEYOR FORM NO. 1