

CERTIFICATE

CERTIFIED LAND CORNER

No. 96

21904292000

I, William C. Jung, do hereby certify that on the 12th day of November 1979, I found ~~(no evidence)~~ (no evidence) of the East 1/4 corner of Section 29, T 19 N, R 4 W., Fourth Principal Meridian, and I re-established said corner according to the Wisconsin Statutes as shown and described hereon.

History of original corner establishment:

Schroeder (?) was at this corner in May of 1886.

Description of corner evidence found:

This corner was established by intersecting the occupied East line of the SE1/4 with a line projected through the West 1/4 and Center 1/4. This location fits the overall section measurements of the S1/2 of the section very well.

Dated this 3rd day of Feb. 1981.

William C. Jung

William C. Jung, R.L.S. 1323
Title

Approved: **HARLEY A. SIME**
MONROE CO. SURVEYOR

COUNTY SURVEYOR FORM NO. 1

Witnesses to corner location:

Witnesses to corner location:

W. Jung

R. Hayden

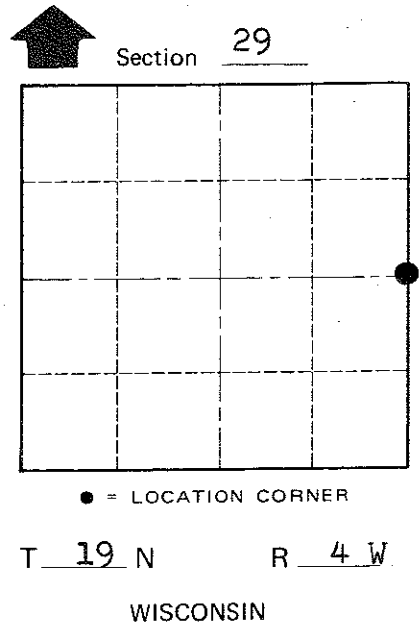
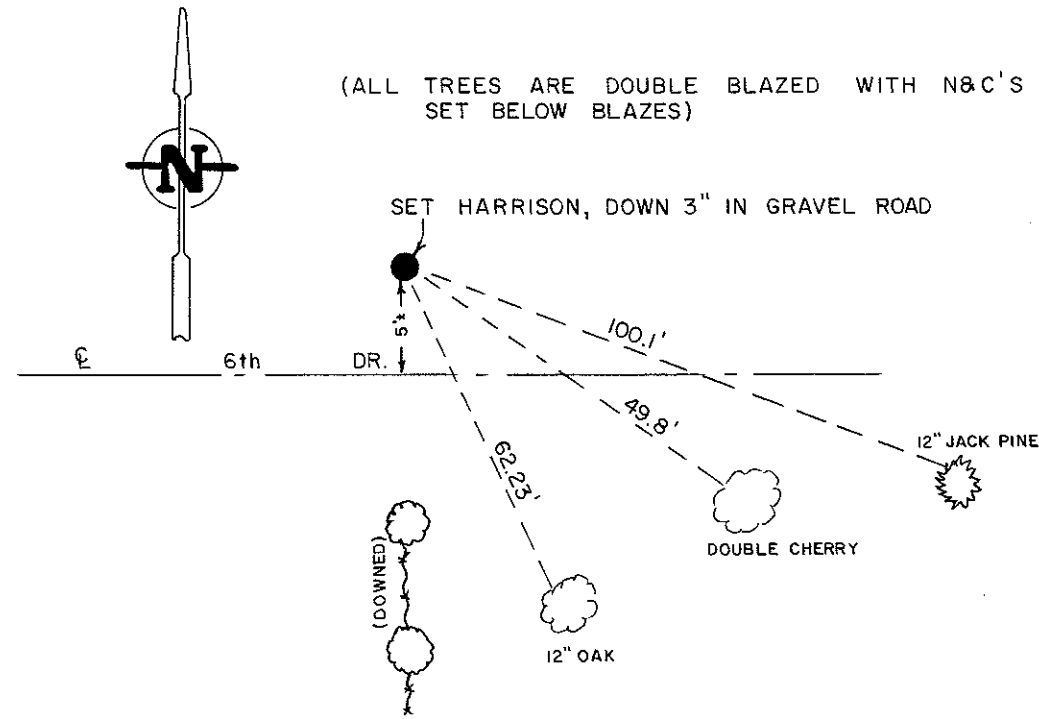
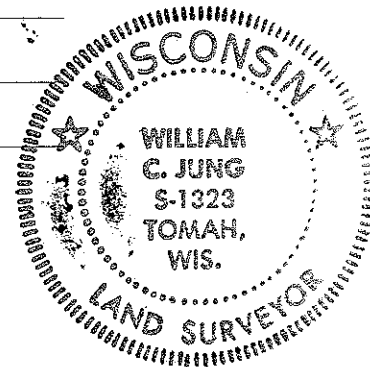

SURVEY CONTROL ORDER

Horizontal	_____
Vertical	_____

WISCONSIN COORDINATE SYSTEM

Corner	East (X)	North (Y)	Elevation (Z)	Zone
Control Sta. Name				

~~City/Village~~ or Town Little Falls
County of Monroe