

CERTIFICATE

CERTIFIED LAND CORNER

No. 120

21904362000

I, Garold A. Sime, do hereby certify that on the 10th day of April 1989, I found ~~(evidence)~~ (no evidence) of the East 1/4 corner of Section 36, T19 N, R4 W Fourth Principal Meridian, and I re-established said corner according to the Wisconsin Statutes as shown and described hereon.

History of corner establishment since Original Government Survey

O. R. Dahl was at this corner in August of 1868 and Fred Holden may have been at this corner in Sept. of 1902.

Description of corner evidence found:

I set this corner on line and equi-distant between section corners

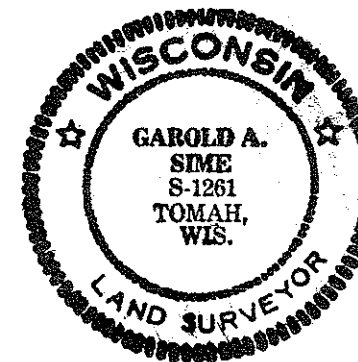

Dated this 7th day of July 1989.

Garold A. Sime

Garold A. Sime, Monroe County Surveyor
Title

COUNTY SURVEYOR FORM NO. 1

Description of corner and witness monuments, references and accessories used to perpetuate the original or re-established location of this corner:

Set Harrison Monument down 15" in field

Witnesses to corner location:

Garold A. Sime, R.L.S.

Brian Forsythe

H. A. SIME & ASSOC.

Surveying & Land Planning

1819 Stoughton Ave. - P.O. Box 705

TOMAH, WI 54660

808-372-5392

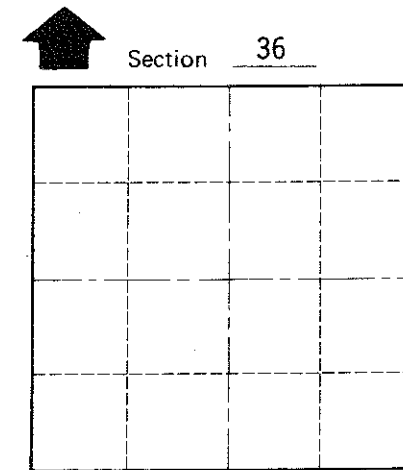
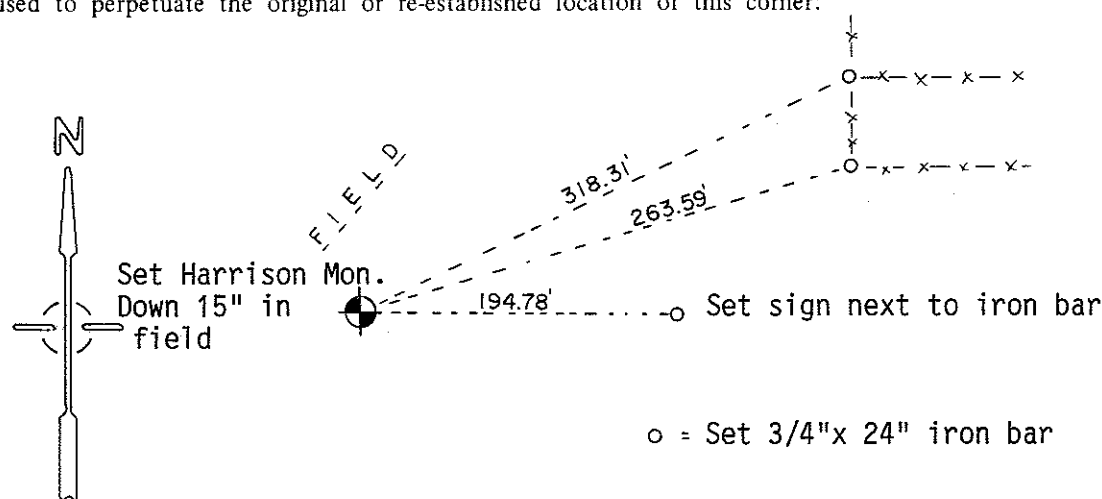

O = LOCATION CORNER

T 19 N R 4 W

WISCONSIN

SURVEY CONTROL ORDER

Horizontal	_____
Vertical	_____

WISCONSIN COORDINATE SYSTEM

Corner	East (X)	North (Y)	Elevation (Z)	Zone
Control Sta. Name				

City, Village or Town of Little Falls
County of Monroe