

CERTIFICATE

CERTIFIED LAND CORNER

No. 117

21904332000

I, William C. Jung, do hereby certify that on the 3rd day of APRIL 1978, I found (evidence) (~~No evidence~~) of the EAST 1/4 corner of SECTION 33, T 19 N, R 4 W, Fourth Principal Meridian, and I re-established said corner according to the Wisconsin Statutes as shown and described hereon.

Dated this 11th day of APRIL 1978.

*William C. Jung*

William C. Jung, Co. Surveyors Office  
Title

History of original corner establishment:

No History of corner since original Government survey

Description of corner evidence found:

Accepted the intersection of the centerline of the Town Road and the existing fence line to the north as the best available evidence.

Approved: **HARLEY A. SIME**  
**MONROE CO. SURVEYOR**

Description of corner and witness monuments, references and accessories used to perpetuate the original or re-established location of this corner:

Witnesses to corner location:

JUNG  
DECHANT

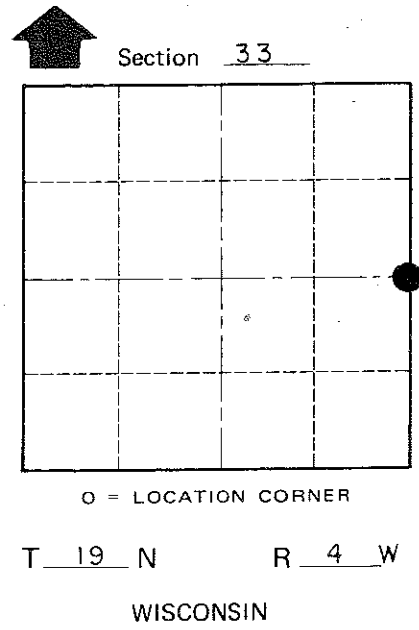
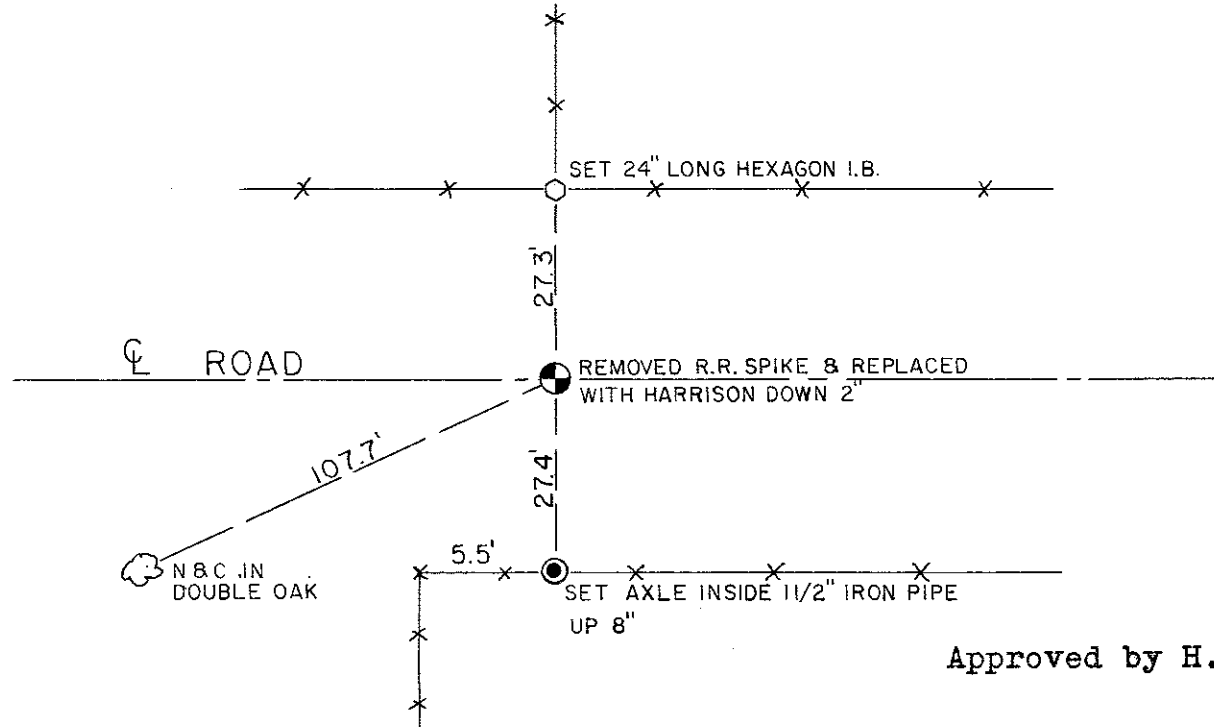
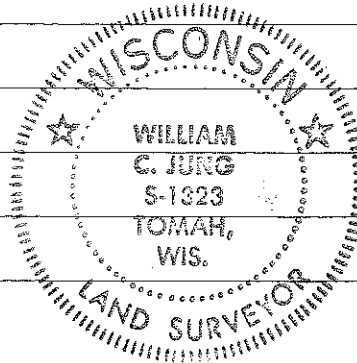

SURVEY CONTROL ORDER

Horizontal	_____
Vertical	_____

WISCONSIN COORDINATE SYSTEM

Corner	East (X)	North (Y)	Elevation (Z)	Zone
Control Sta. Name				

Approved by H.A.Sime, Co. Surveyor

City, Village or Town Little Falls  
County of Monroe

COUNTY SURVEYOR FORM NO. 1