

CERTIFICATE

CERTIFIED LAND CORNER

No. 115 A

21904322030

I, William C. Jung, do hereby certify that on the 9th day of November 19 79, I found ~~(evidence)~~ (no evidence) of the W1/16 corner of Section 32, T 19 N, R 4 W, Fourth Principal Meridian, and I re-established said corner according to the Wisconsin Statutes as shown and described hereon.

History of original corner establishment:

None recorded.

Description of corner evidence found:

Set as required by law, equidistant and on line between the W1/4 corner and the C1/4 corner.

Dated this 3rd day of Feb., 1981.

William C. Jung

William C. Jung, R.L.S. 1323
Title

Approved: **HARLEY A. SIME**
MONROE CO. SURVEYOR

Description of corner and witness monuments, references and accessories used to perpetuate the original or re-established location of this corner:

COUNTY SURVEYOR FORM NO. 1

Witnesses to corner location:

Jung
Pietz
Tormoen

NOTE: TREES BLAZED WITH NAIL & CAPS SET

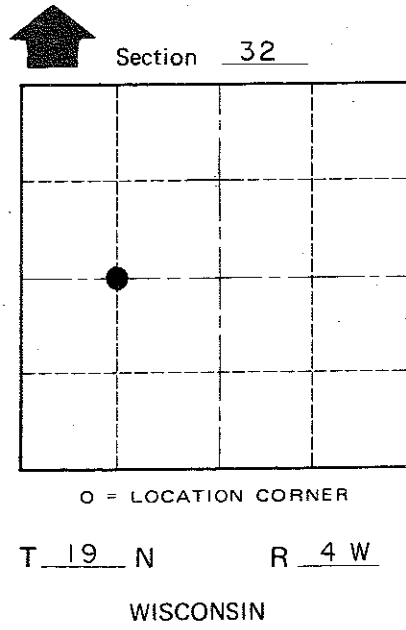
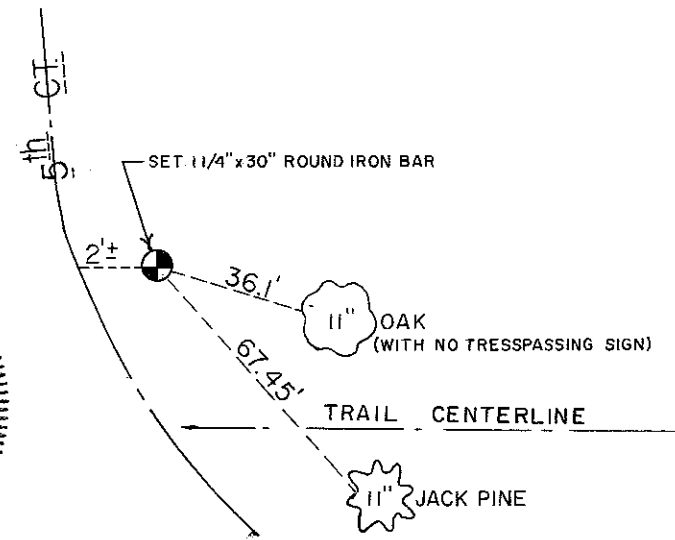
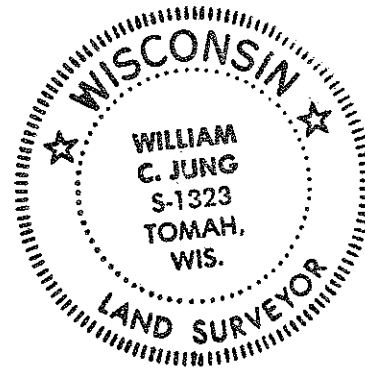

SURVEY CONTROL ORDER

Horizontal	_____
Vertical	_____

WISCONSIN COORDINATE SYSTEM

Corner	East (X)	North (Y)	Elevation (Z)	Zone
Control Sta. Name				

or Town Little Falls

County of Monroe