

21902030020

I, William C. Jung, do hereby certify that on the 21st day of September 1982, I found (evidence) ~~no evidence~~ of the South 1/4 corner of Section 3, T 19 N, R 2 W Fourth Principal Meridian, and I re-established said corner according to the Wisconsin Statutes as shown and described hereon.

History of corner establishment since Original Government Survey

Holden set a stone at this corner in May of 1908. Feddersen's map, dated March, 1980, and Heidecke's map, dated September, 1980, both show a stone at this corner.

Description of corner evidence found:

I found the stone of record at the corner.

Dated this 17th day of Dec. 19 82.

William C. Jung  
Deputy County Surveyor

Title

Approved: **HARLEY A. SIME**  
**MONROE CO. SURVEYOR**

COUNTY SURVEYOR FORM NO. 1

Description of corner and witness monuments, references and accessories used to perpetuate the original or re-established location of this corner:

Witnesses to corner location:

William C. Jung

Bryan H. Meyer

Set Harrison on North side of stone. Harrison is a witness monument. All b.t.'s double blazed. Each distance is to a nail in a hack on the side of the tree.

Stone w/cross up 3"±.

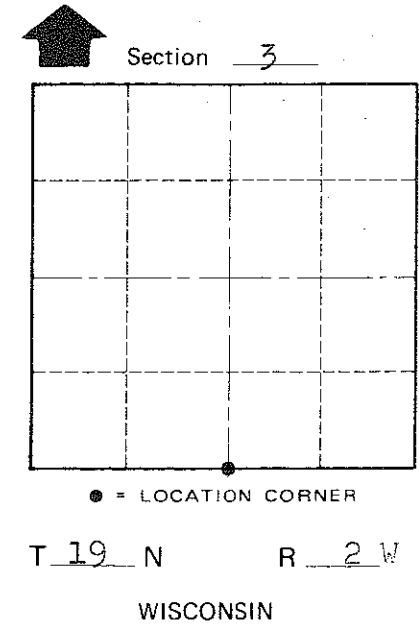
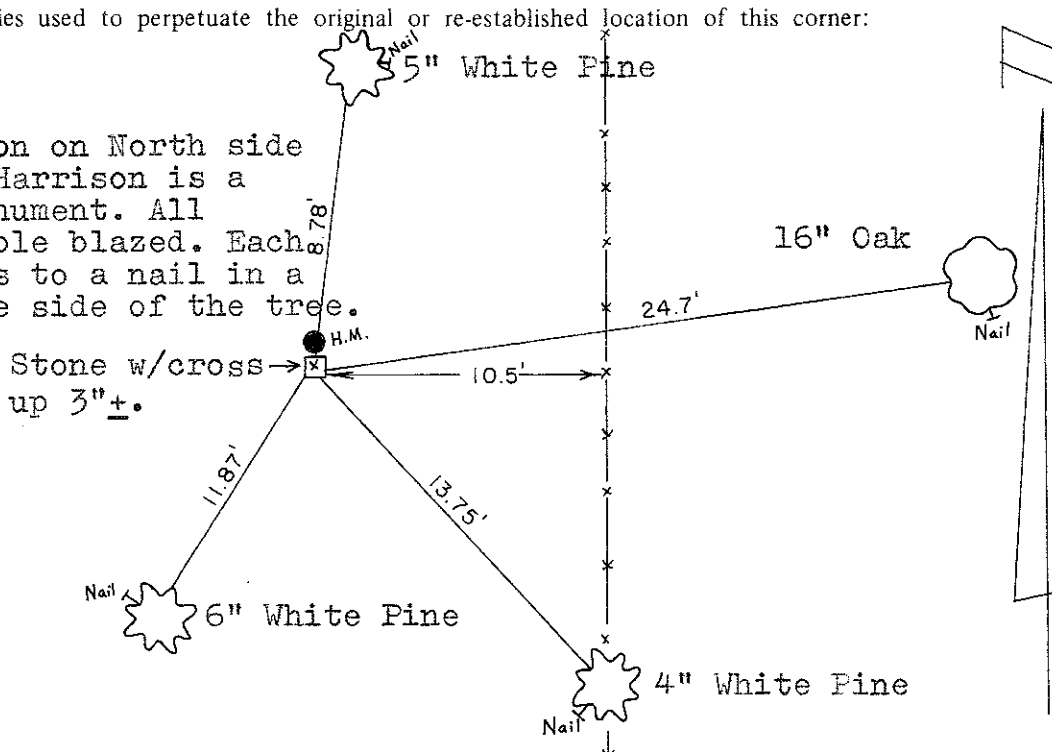
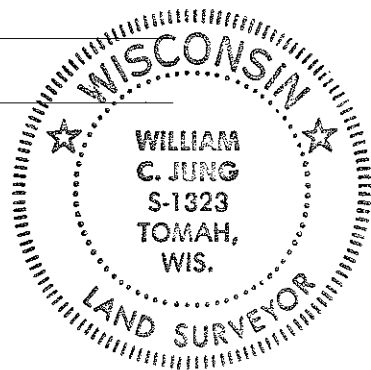

SURVEY CONTROL ORDER

Horizontal \_\_\_\_\_  
Vertical \_\_\_\_\_

WISCONSIN COORDINATE SYSTEM

Corner	East (X)	North (Y)	Elevation (Z)	Zone
Control Sta. Name				

~~City, Village or~~ Town of Grant  
County of Monroe