

**U.S. PUBLIC LAND CORNER
MAINTENANCE**

24

**Corner ID: N1/4 Sec. 11, T19N-R2W
21902020020**

<u>DATE</u>	<u>CREW</u>	<u>MONUMENT INFO</u>
March 4, 2020	Zachariah P. Dechant Gary L. Dechant	Existing Stone (+), grader blade north side, sign 1' NE, at fence corner, NE corner of 20538 Aspen Ave Approx 200' north of Aspen Ave & 300' east of USH "12"

<u>Compass Bearing</u>	<u>Distance</u>
------------------------	-----------------

- | | | |
|---|------|--------|
| 1) Set 3/4"x24' round iron bar, 4' SW of 12" White Pine | N75E | 31.56' |
| 2) Set 3/4"x24" round iron bar, 4' NW of 10" Jack Pine (1977 BT) | S46E | 22.92' |
| 3) Set 3/4" round iron bar, 4' NE of 7" White pine in lawn | S33W | 30.51' |
| 4) Set 3/4"x24" round iron bar, 3' NW & between 14" & 12" White Pines | N60W | 13.63' |

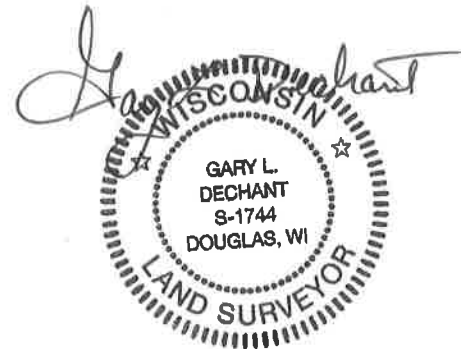

March 17, 2020

I, Harley A. Sime, do hereby certify that on the 8 day of September 1977, I found evidence (~~no evidence~~) of the N 1/4 corner of Section 11, T19 N, R 2 W, Fourth Principal Meridian, and I re-established said corner according to the Wisconsin Statutes as shown and described hereon.

Dated this 9 day of Sept. 1977.

History of original corner establishment:

Fred Holden set a corner here in 1902.

Description of corner evidence found:

Found a stone used in previous surveys by Hurlburt and Sime.

County Surveyor Approved: HARLEY A. SIME
 Title MONROE CO. SURVEYOR

**See Reverse Side
For Maintenance**

Description of corner and witness monuments, references and accessories used to perpetuate the original or re-established location of this corner:

Found a stone at the fence corner with a grader blade on the North side.

Witnesses to corner location:

W. C. Jung - Crew Chief *W.C. Jung*

G. L. Dechant

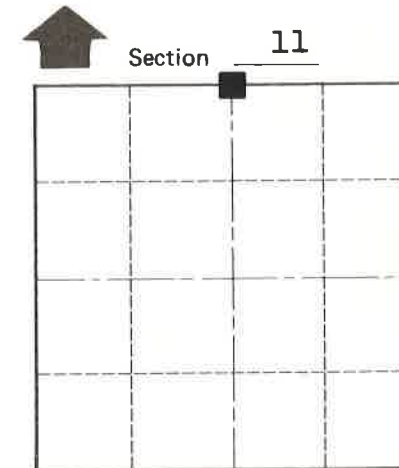
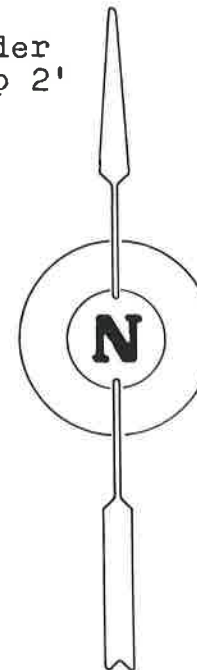
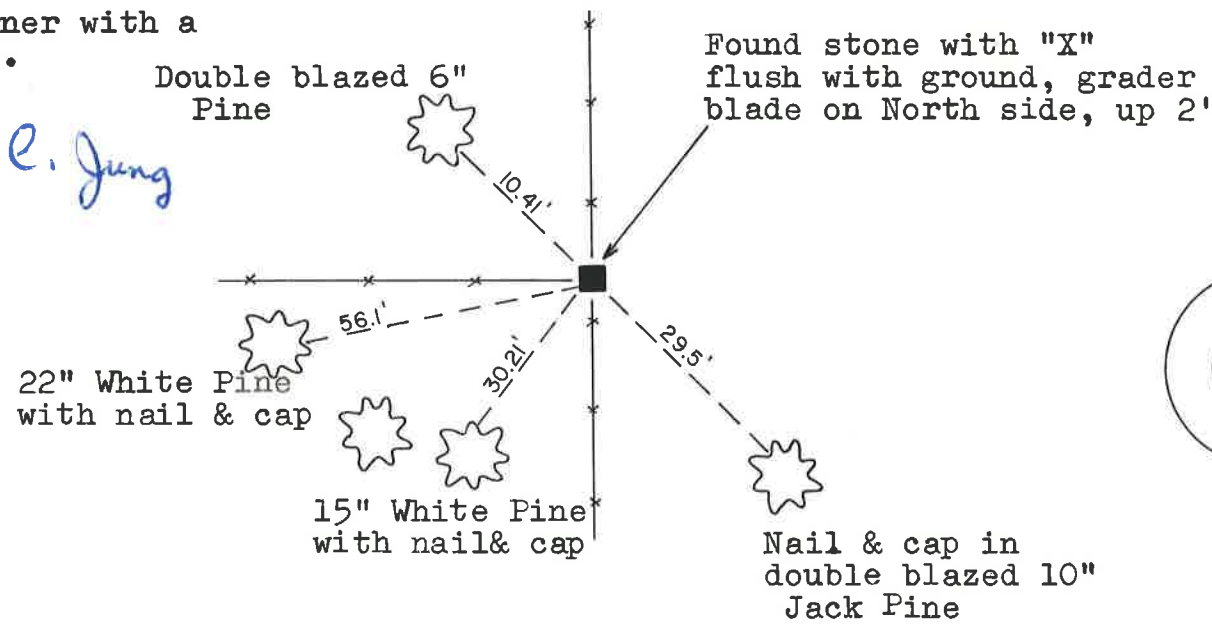
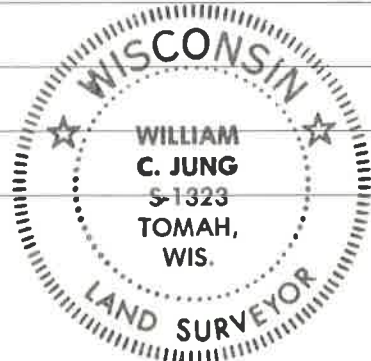

O = LOCATION CORNER

T 19 N R 2W

WISCONSIN

SURVEY CONTROL ORDER

Horizontal	_____
Vertical	_____

WISCONSIN COORDINATE SYSTEM

Corner	East (X)	North (Y)	Elevation (Z)	Zone
Control Sta. Name				

City, Village or Town Grant

County of Monroe

O.K.

COUNTY SURVEYOR FORM NO. 1