

21902230020

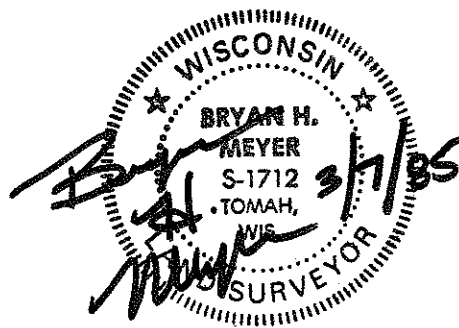

I, Bryan H. Meyer, do hereby certify that on the 29th day of June 1984, I found (no evidence) of the South 1/4 corner of Section 23, T 19 N, R 2 W Fourth Principal Meridian, and I re-established said corner according to the Wisconsin Statutes as shown and described hereon.

Dated this 7th day of Mar. 1985.

Bryan H. Meyer (Signature)

Deputy County Surveyor

History of corner establishment since Original Government Survey

H. A. Sime did work in Sections 22 and 23 and had a computed location for this corner in 1974.

Description of corner evidence found:

I set this corner equi-distant between the Southwest and the Southeast corners of Section 23 and at a distance of 2622.24 feet South of the Center 1/4 corner of Section 23. This location is very close to Mr. Sime's location.

Description of corner and witness monuments, references and accessories used to perpetuate the original or re-established location of this corner:

Crew: Meyer, Wilhite
Date: June 29, 1984 - 2:00 P.M.

The bearings shown are magnetic hand compass bearings.

Witnesses to corner location:

Bryan H. Meyer

Dallas Wilhite

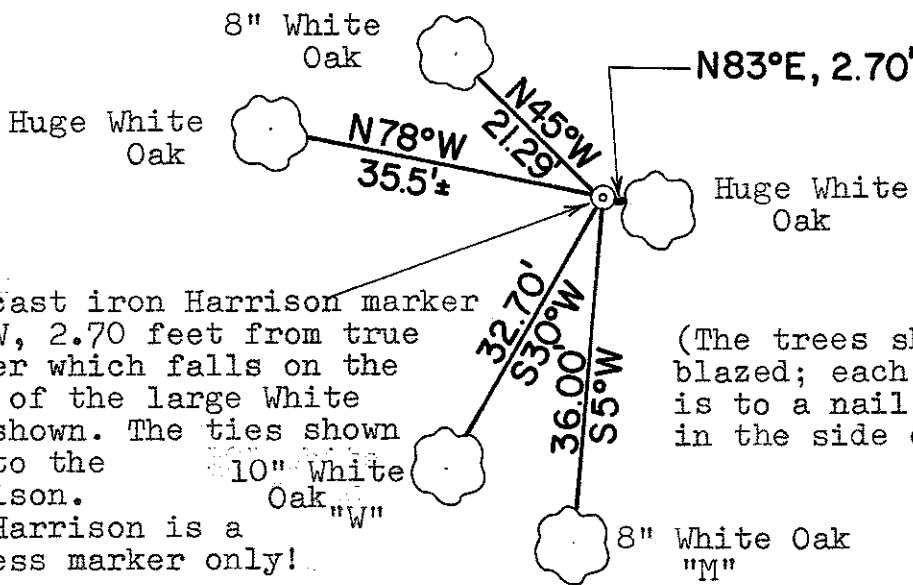

Set cast iron Harrison marker S83°W, 2.70 feet from true corner which falls on the side of the large White Oak shown. The ties shown are to the 10 inch White Oak 'W'. The Harrison is a witness marker only!

(The trees shown are double blazed; each distance shown is to a nail set in a hack in the side of each tree.)

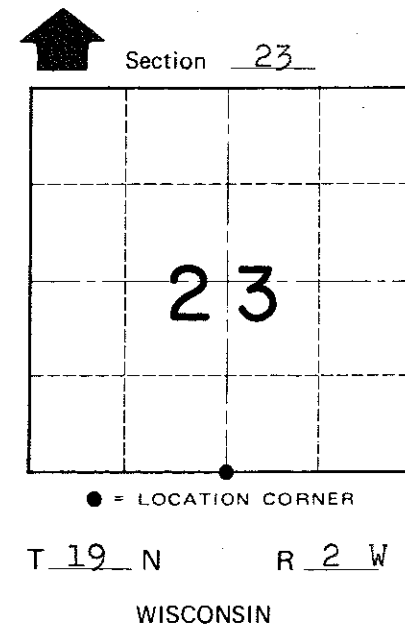

COUNTY SURVEYOR FORM NO. 1

SURVEY CONTROL ORDER

Table with 2 rows: Horizontal, Vertical

WISCONSIN COORDINATE SYSTEM

Table with 5 columns: Corner, East (X), North (Y), Elevation (Z), Zone

Town of Grant
County of Monroe