

85

**U.S. PUBLIC LAND CORNER
MAINTENANCE**

Corner ID : SE Sec.22, T19N-R2W
21902220000

<u>DATE</u>	<u>CREW</u>	<u>MONUMENT TYPE</u> -----
May 6, 2015	Zachariah P. Dechant Gary L. Dechant	Existing STONE. Harrison (top broke off) SE of stone as WITNESS MARKER. Sign 1' North

References:

	<u>Bearing</u>	<u>Distance</u>
1) Set 3/4"x 24" round iron bar, down 6", 3' south of 10" Maple	North	23.60'
2) Set 3/4"x24" round iron bar, down 6", 5' NE 14" White Oak (BT)	S48E	24.30'
3) Set 3/4"x24" round iron bar, down 6", 6' east 16" Red Pine	S74W	31.80'
4) Set 3/4"x24" round iron bar, down 6", 3' SE 12" White Oak	N47W	27.92'

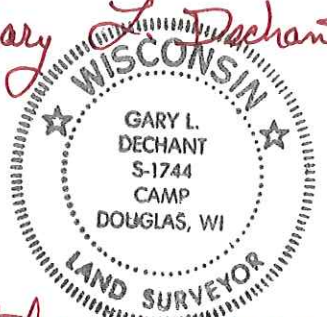
Gary L. Dechant

October 29, 2015

I, William C. Jung, do hereby certify that on the 10th day of September 1982, I found (evidence) ~~no evidence~~ of the SE corner of Section 22, T. 19 N, R. 2 W Fourth Principal Meridian, and I re-established said corner according to the Wisconsin Statutes as shown and described hereon.

Dated this 23rd day of Feb. 1983.

William C. Jung
Deputy County Surveyor
Title

History of corner establishment since Original Government Survey
In November of 1906 Holden was at this corner and found the original corner. A survey crew from Harley Sime's office was at this corner in 1973 and found a stone.

**See Reverse Side
For Maintenance**

Description of corner evidence found:

I found an iron bar by a stone at the old occupied corner. I removed the bar and replaced it with a Harrison. The ties are to the Harrison which is a witness corner. The stone is 6" to the Southeast of the Harrison. The stone is the corner. Also, the stone measures about 4"x10"x22"

**Approved: HARLEY A. SIME
MONROE CO. SURVEYOR**

Description of corner and witness monuments, references and accessories used to perpetuate the original or re-established location of this corner:

Witnesses to corner location:

William C. Jung
Bryan Meyer

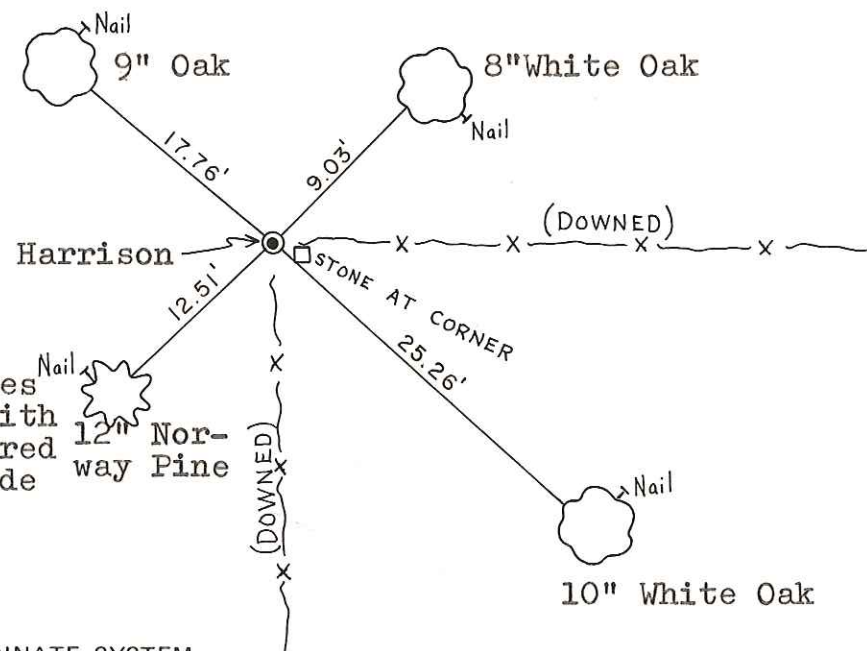

Note: All the bearing trees are double blazed with each distance measured to a nail in the side of the tree.

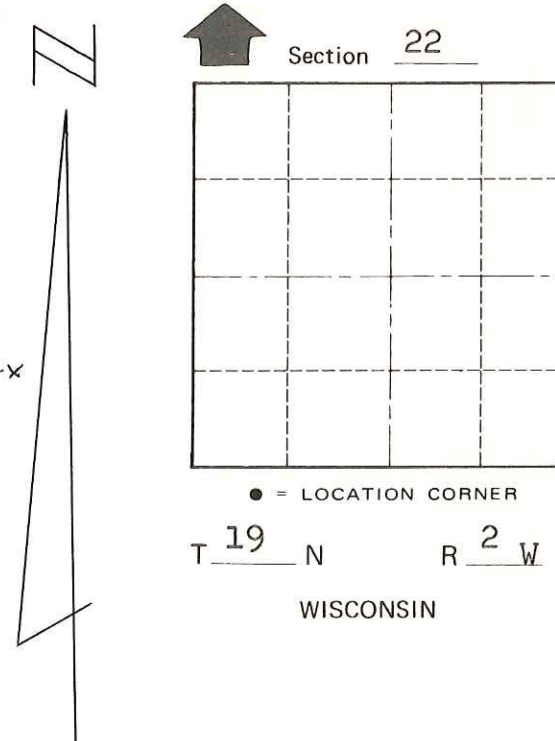

SURVEY CONTROL ORDER

Horizontal	_____
Vertical	_____

WISCONSIN COORDINATE SYSTEM

Corner	East (X)	North (Y)	Elevation (Z)	Zone
Control Sta. Name				

~~City, Village or~~ Town Grant
County of Monroe

COUNTY SURVEYOR FORM NO. 1