

**CERTIFICATE**

I, Nicholas M. Hillmer, do hereby certify that this document and the data contained herein was prepared by me or under my direct supervision and that I am a duly Licensed Land Surveyor under the laws of the State of Wisconsin.

Dated this 21st day of May, 2013

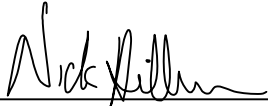

Nicholas M. Hillmer, P.L.S. 2909  
Anderson Engineering of Minnesota, LLC.

**CERTIFIED LAND CORNER**

History of corner established since Original Government Survey

The 1940's McCoy boundary notes show a corner at this location.

**Description of evidence found**

On December 19th, 2012, Anderson Engineering of Minnesota located a 1 1/2 inch iron 0.30 feet above grade. The pipe was accepted as the best available evidence. On April 21st, 2013, Anderson Engineering of Minnesota replaced the pipe with a 3/4 inch aluminum drive monument with a 3 1/4 inch cap, stamped "FORT MCCOY BOUNDARY" "2013" "ANDERSON ENG. OF MN."

No. 21902282010

Description of corner and witness monuments, references and accessories used to perpetuate the original or re-established location of this corner:

Witnesses to corner location:

Nick Hillmer  
Josh Oslund  
Dan Greenwald

MONROE COUNTY  
COORDINATE SYSTEM  
NAD 1983 (2007)

MCCOY DRIVE MONUMENT  
Northing (Y) 434301.32  
Easting (X) 677073.78

Base Station - 22 182W  
Northing (Y) 408053.25  
Easting (X) 679287.00

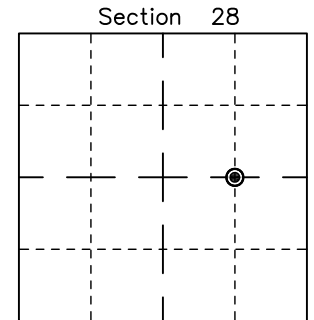
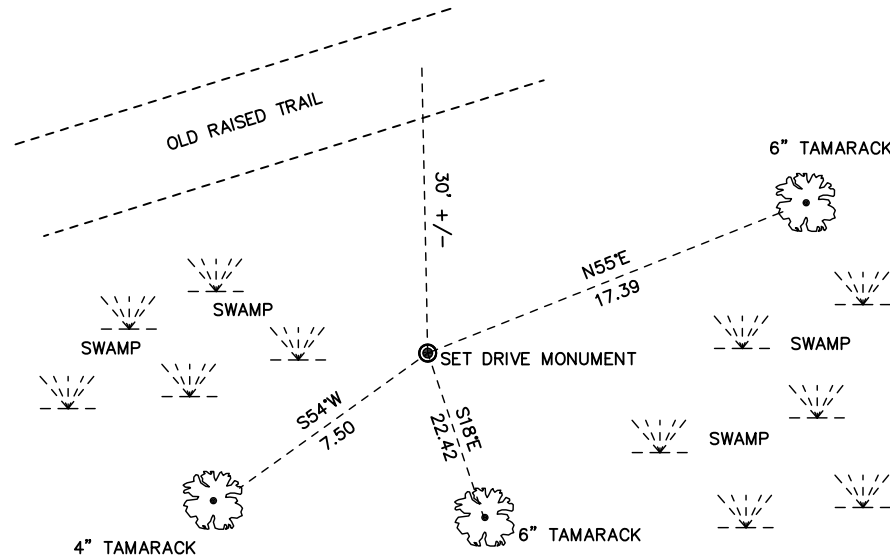

● = LOCATION CORNER  
Corner I.D. CE 1/16 28  
T 19 N R 2 W  
Town of Grant  
Monroe County, WI.

All distances are shown in U.S. Survey Feet.  
Ties are to 60D nails set in trees.  
Bearings are for tie reference purposes only.  
Coordinates were derived from RTK GNSS procedures.