

# 100 / 94

**U.S. PUBLIC LAND CORNER  
MAINTENANCE**

**Corner ID : E1/4 Sec.25, T19N-R2W**

**21902252000**

<u>DATE</u>	<u>CREW</u>	<u>MONUMENT TYPE -----</u>
June 17, 2016	Zachariah P.Dechant Gary L. Dechant	Existing Harrison in tact in east-west fence. Set sign 1' west. Only one tie remaining. 5/8" hexagon iron bar 22.10' (22.23') east.

References:

	<u>Bearing</u>	<u>Distance</u>
1) Set 3/4"x24" round iron bar, down 12" in field, 13' north of fence	NE	15.82'
2) Set 3/4"x24" round iron bar, down 6" 2.5' south of bent steel post	SE	13.03'
3) Set 3/4"x24" round iron bar, down 12" in field, 4' south of fence	SW	12.25'
4) Set 3/4"x24" round iron bar, down 12" in field, 12' north of fence	NW	14.30'

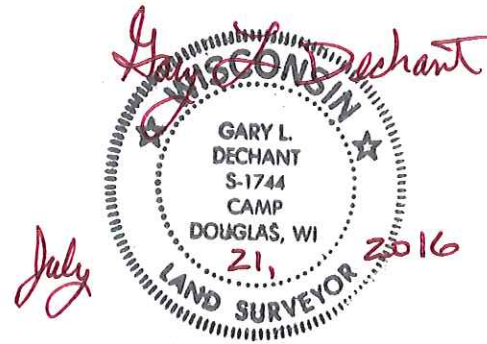

I, Garold A. Sime, do hereby certify that on the \_\_\_\_\_ day of \_\_\_\_\_ 19\_\_\_\_, I found (evidence) ~~(no evidence)~~ of the W 1/4 corner of Section 30, T 19 N, R 1 W Fourth Principal Meridian, and I re-established said corner according to the Wisconsin Statutes as shown and described hereon.

Dated this 11th day of Jan. 1979.

Garold A. Sime, R.L.S. 1261

Crew Chief, County Surveyor's  
Title Office

History of original corner establishment:

A. S. Ingalls was at this corner in April of 1873.

Description of corner evidence found:

Set this corner by intersecting the E-W 1/4 line (ex. monuments at C 1/4 & E 1/4 corners) with a straight line between the SW corner and the NW corner of Sec. 30, this fit the existing E-W fence very well.

**See Reverse Side For Maintenance**

Description of corner and witness monuments, references and accessories used to perpetuate the original or re-established location of this corner:

Witnesses to corner location:

G. Sime

D.C. Dade

B. Meyer

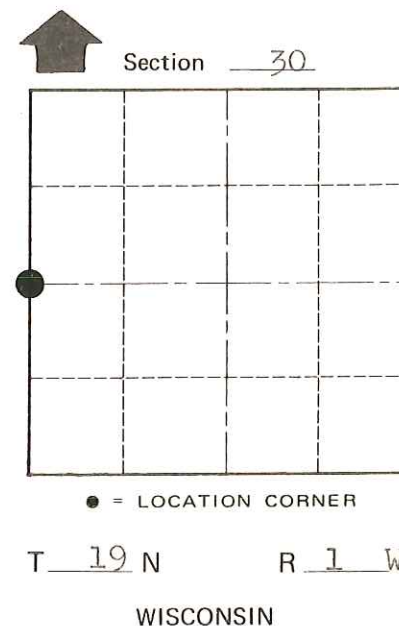
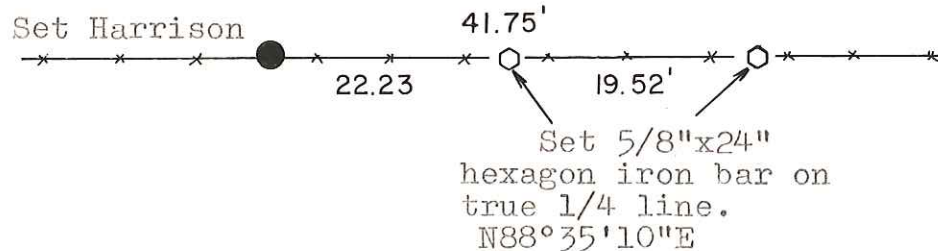
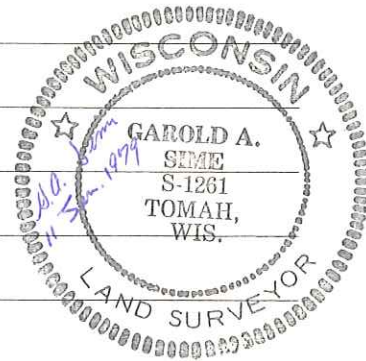

SURVEY CONTROL ORDER

Horizontal \_\_\_\_\_  
Vertical \_\_\_\_\_

Approved by: Harley A. Sime  
County Surveyor

WISCONSIN COORDINATE SYSTEM

Corner	East (X)	North (Y)	Elevation (Z)	Zone
Control Sta. Name				

City, Village or Town Lincoln

County of Monroe

COUNTY SURVEYOR FORM NO. 1