

CERTIFICATE

CERTIFIED LAND CORNER

No. 94 N

**21902251000**

I, Garold A. Sime, do hereby certify that on the \_\_\_\_\_ day of December 1977, I found (evidence) (~~no evidence~~) of the W1/16SW corner of Section 30, T 19 N, R 1 W Fourth Principal Meridian, and I re-established said corner according to the Wisconsin Statutes as shown and described hereon.

History of original corner establishment:

No known recorded history since the original government survey.

Description of corner evidence found:

Set as per law after surveying exterior of Section.

Dated this 11th day of Jan. 1979.

Garold A. Sime, R.L.S. 1261

Crew Chief, County Surveyor's  
Title Office

Description of corner and witness monuments, references and accessories used to perpetuate the original or re-established location of this corner:

Witnesses to corner location:

- \_\_\_\_\_G. Sime\_\_\_\_\_
- \_\_\_\_\_C. Pietz\_\_\_\_\_
- \_\_\_\_\_L. Radcliffe\_\_\_\_\_
- \_\_\_\_\_G. Dechant\_\_\_\_\_

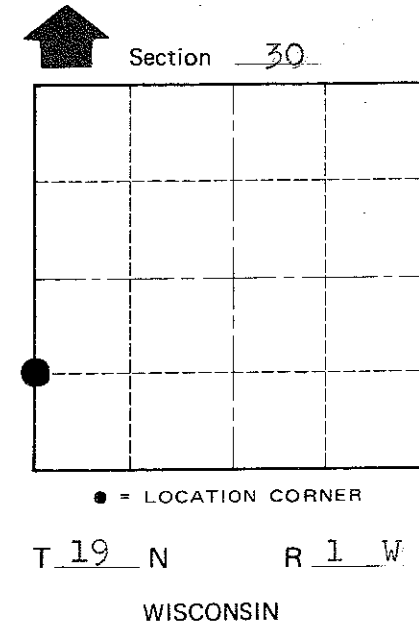
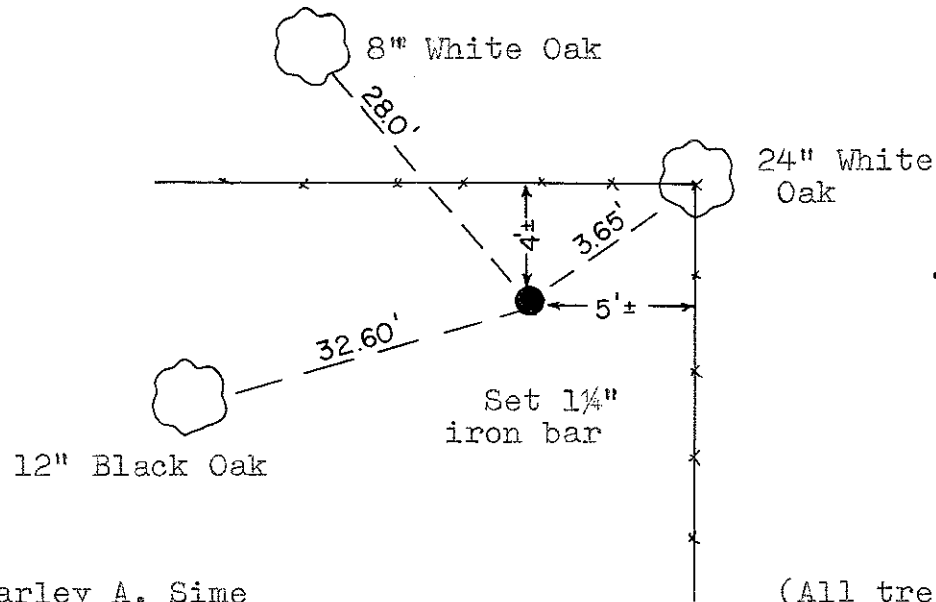
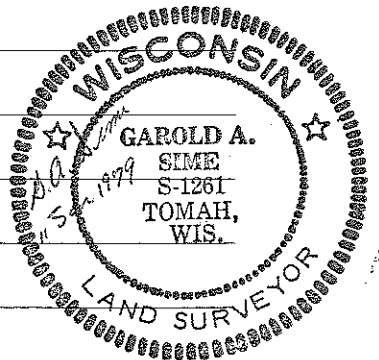

(All trees blazed with N&C's set)

Approved by: Harley A. Sime  
County Surveyor

City, Village or Town Lincoln  
County of Monroe

COUNTY SURVEYOR FORM NO. 1

SURVEY CONTROL ORDER

Horizontal	_____
Vertical	_____

WISCONSIN COORDINATE SYSTEM

Corner	East (X)	North (Y)	Elevation (Z)	Zone
Control Sta. Name				