

21902310000

I, William C. Jung, do hereby certify that on the 29th day of November 1982, I found (evidence) ~~re-established~~ of the Northwest corner of Section 5, T 18 N, R 2 W Fourth Principal Meridian, and I re-established said corner according to the Wisconsin Statutes as shown and described hereon.

History of corner establishment since Original Government Survey
In September of 1911, Holden set a drive well point at this corner.

Description of corner evidence found:

I found a well point at the corner, down 24", and Southeast of the road intersection. I set over the top of it an old iron (24" long with a 2" shaft and a 2" nut on top with a 5" round housing under the nut). I set this iron down 7". I also set a plow share along the North side of the iron. I set 6" nail offsets 1.5' North and 1.5' West. Corner is on line with South edges of roads East-West and on line with East edges of roads North-South.

Dated this 17th day of Dec. 1982.

William C. Jung
Deputy County Surveyor

Title

COUNTY SURVEYOR FORM NO. 1

Description of corner and witness monuments, references and accessories used to perpetuate the original or re-established location of this corner:

Witnesses to corner location:

William C. Jung

Melvin A. Pliner

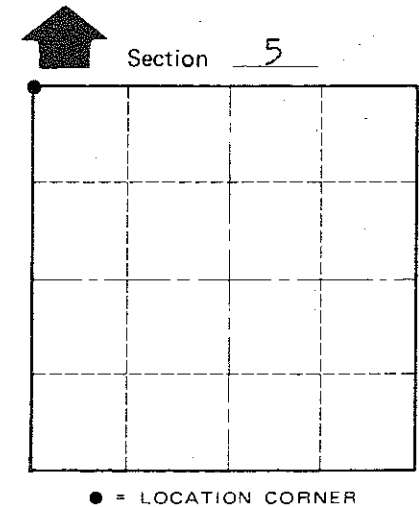
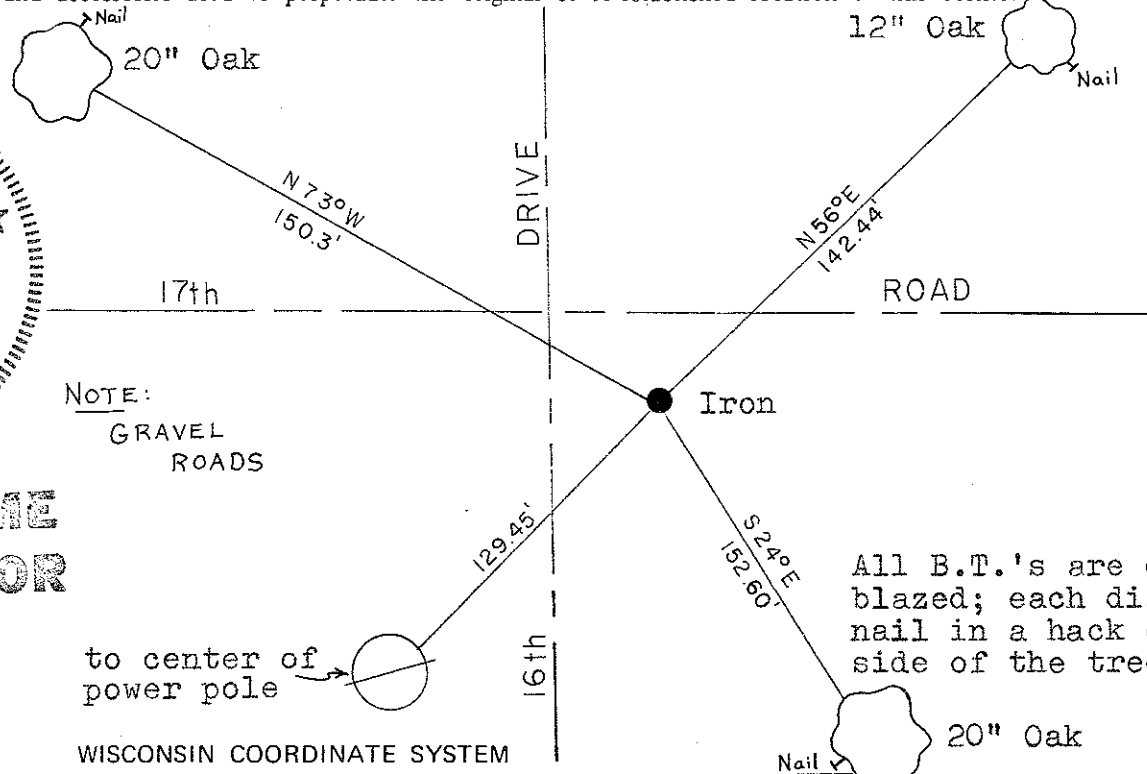
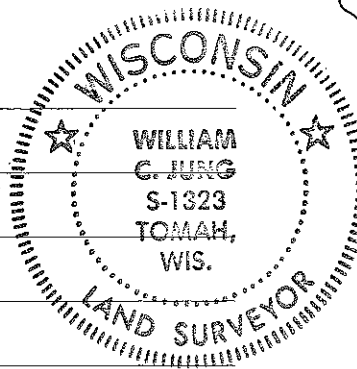

Approved: **HARLEY A. SIME**
MONROE CO. SURVEYOR

SURVEY CONTROL ORDER

Horizontal	_____
Vertical	_____

WISCONSIN COORDINATE SYSTEM

Corner	East (X)	North (Y)	Elevation (Z)	Zone
Control Sta. Name				

All B.T.'s are double blazed; each dist. to a nail in a hack on the side of the tree.

City, Village or Town of Greenfield
County of Monroe