

# 44

**U.S. PUBLIC LAND CORNER  
MAINTENANCE**

**Corner ID : S1/4 Sec. 11, T19N-R1W  
21901110020**

DATE	CREW	MONUMENT TYPE -----
May 26, 2016	Zachariah P.Dechant Gary L. Dechant	Drove existing 1/4" iron bar down 12" 1.5' south center line CTH "EW". 40' east of bridge. West of Atwater Road

References:

	<u>Bearing</u>	<u>Distance</u>
1) Set 3/4"x24" round iron bar, down 6", 2' east of power pole	N18E	60.53'
2) Set 3/4"x24" round iron bar, down 6" , 8' west of 24" White Pine, 13' south of 24" White Pine	N18E	112.43'
3) Set 3/4"x24" round iron bar, down 6" , 7' west of 30" White Pine	S60E	103.11'
4) Set 3/4"x24"round iron bar, down 6" , 14' north of lone 28" White Pine	S60E	170.16'

1/4" iron bar and reference markers set on straight lines.

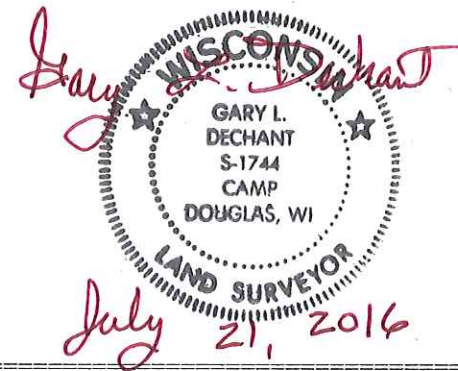

I, Harley A. Sime, do hereby certify that on the 1st day of October 1975, I found (evidence) ~~(no evidence)~~ of the South 1/4 corner of Section 11, T 19 N, R 1 W Fourth Principal Meridian, and I re-established said corner according to the Wisconsin Statutes as shown and described hereon.

Dated this 2nd day of March 1976.

History of original corner establishment:

Description of corner evidence found:

Found a large nail, set and used in previous surveys by F. Zietlow. Removed the nail and replaced it with a Harrison marker.

**See Reverse Side For Maintenance**

County Surveyor Approved: HARLEY A. SIME  
 Title MONROE CO. SURVEYOR

Description of corner and witness monuments, references and accessories used to perpetuate the original or re-established location of this corner:

Set a Harrison in the center of C.T.H. "E", down 1".

Witnesses to corner location:

W.C. Jung-Crew Chief W.C. Jung

A. Lueck

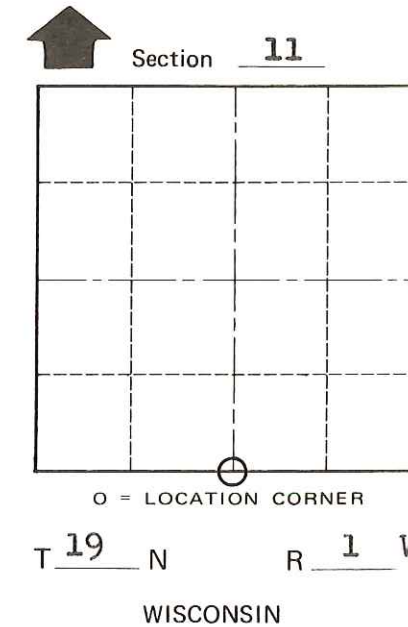
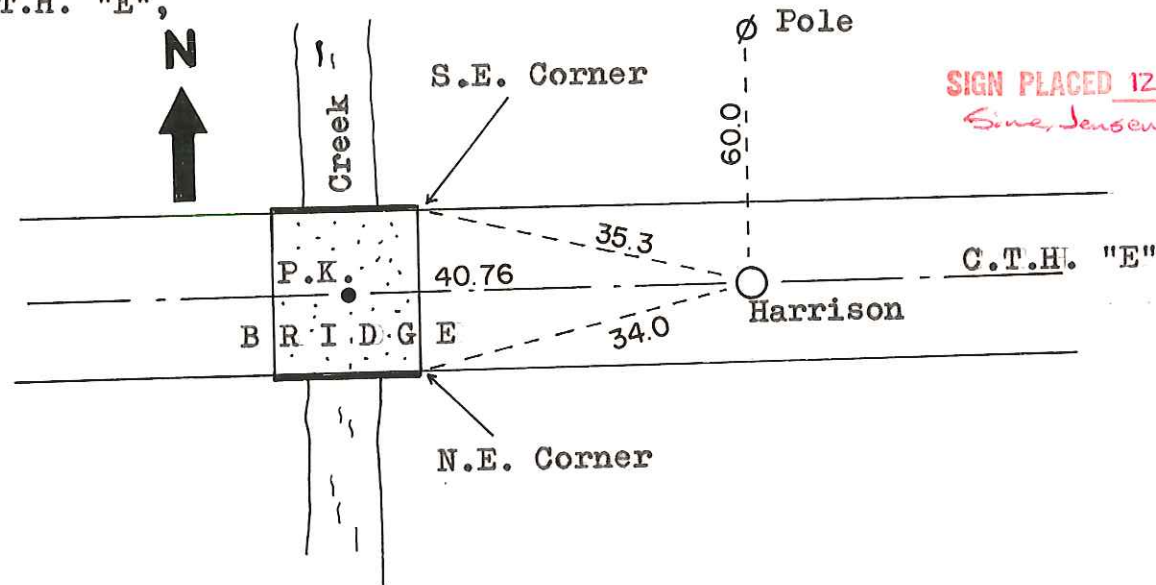
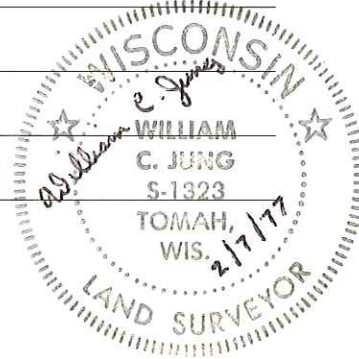

SIGN PLACED 12/18/86  
*Sime, Jensen*

COUNTY SURVEYOR FORM NO. 1

SURVEY CONTROL ORDER

Horizontal	_____
Vertical	_____

WISCONSIN COORDINATE SYSTEM

Corner	East (X)	North (Y)	Elevation (Z)	Zone
Control Sta. Name				

City, Village or Town Lincoln

County of Monroe