

# 43

**U.S. PUBLIC LAND CORNER  
MAINTENANCE**

**Corner ID : SE Sec. 11, T19N-R1W  
21901110000**

<u>DATE</u>	<u>CREW</u>	<u>MONUMENT TYPE -----</u>
May 27, 2016	Zachariah P. Dechant Gary L. Dechant	Drove existing 1/4" round iron bar down 10" because of road construction, at intersection of CTH "EW"/Atwood Road/CTH "N"

References:

	<u>Bearing</u>	<u>Distance</u>
1) Set 3/4"x24" round iron bar, down 6", 1' east of wood post, south of gate	N38E	112.06'
2) Existing 1" iron pipe, lowered 6"	S40E	70.23' (70.12')
3) Set 3/4"x24" round iron bar, down 6"	S38W	86.63'
4) Set 3/4"x24" round iron bar, down 6"	N40W	56.27'

1/4" iron bar and reference markers set on straight lines.

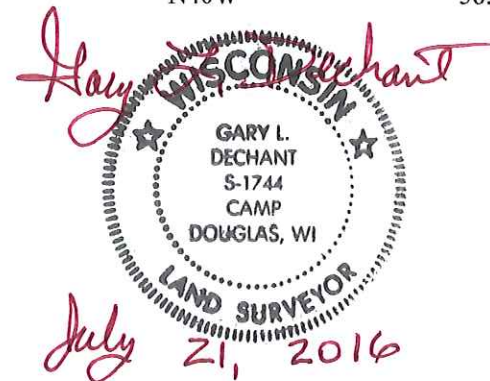

I, Harley A. Sime, do hereby certify that on the 1st day of October 19 75, I found (evidence) ~~no evidence~~ of the Southeast corner of Section 11, T 19 N, R 1 W Fourth Principal Meridian, and I re-established said corner according to the Wisconsin Statutes as shown and described hereon.

Dated this 1st day of March 1976.

County Surveyor  
Title

History of original corner establishment:

Since this corner was monumented by Harley Sime in October of 1975, this corner has been used in numerous surveys. The County Surveyor's Office was contacted by Norb Smith, Monroe County Highway Commissioner in the spring of 1992. He informed us that this portion of C.T.H. "E" was to be upgraded and repaved. The Harrison marker was removed July 7, 1992.  
Description of corner evidence found:

**Found a 3/4"x24" iron bar used by D. Marten and F. Zietlow in previous surveys. Removed the bar and replaced it with a Harrison marker.**

UPDATE: Following construction, this corner was reset with a 1 1/4"x30" round iron bar in the new hot-mix paving. This corner was reset using the two iron pipes shown. Did not verify any of the power pole measurements. The two iron pipes shown were set at the time that the Harrison was removed.

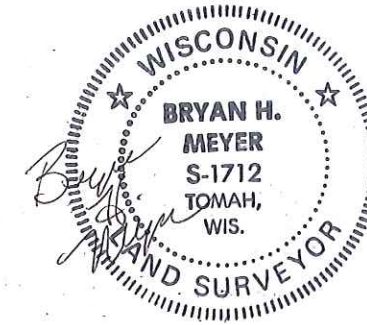

Bryan H. Meyer  
H. A. Sime and Associates  
P. O. Box 705  
Tomah, Wisconsin 54660  
Phone: (608)-372-5392

Description of corner and witness monuments, references and accessories used to perpetuate the original or re-established location of this corner:

Set a Harrison in the road intersection. There is a R.R. spike 8.05 ft. East of the corner also.

Witnesses to corner location: UPDATE: Removed harrison; set 1 1/4"x30" round iron bar

W.C. Jung-Chief *W.C. Jung*

A. Lueck

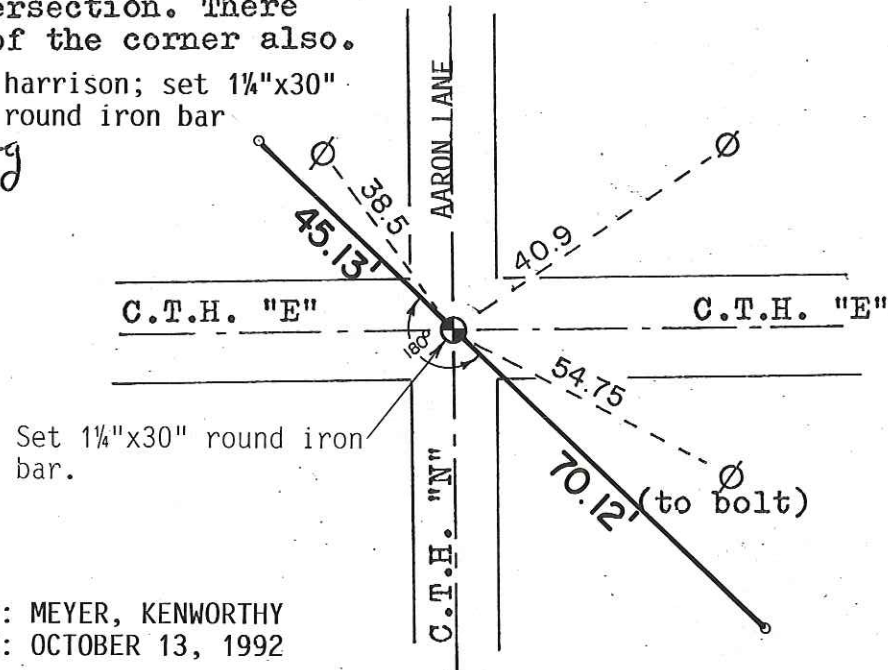
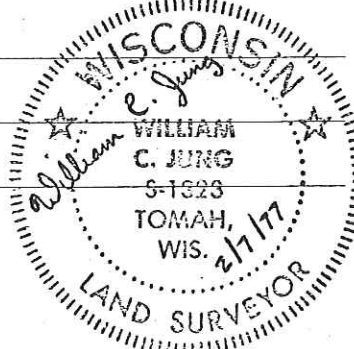

Set 1 1/4"x30" round iron bar.



SIGN PLACED 12/18/86

**See Reverse Side For Maintenance**

- ∅ = Power pole
- = Set 1 1/4"x24" iron pipe

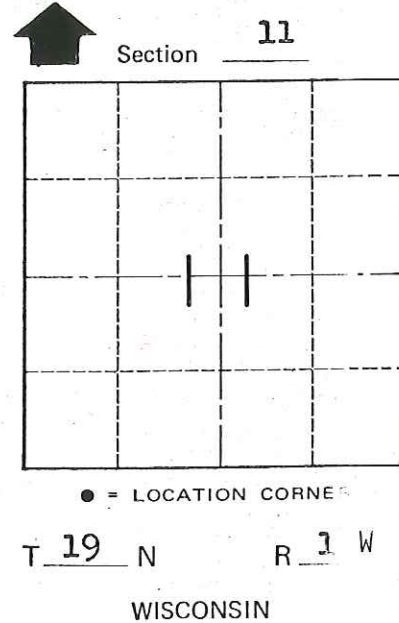

SURVEY CONTROL ORDER

UPDATE CREW: MEYER, KENWORTHY  
DATE: OCTOBER 13, 1992

SURVEY CONTROL ORDER		WISCONSIN COORDINATE SYSTEM			
Horizontal	Vertical	East (X)	North (Y)	Elevation (Z)	Zone
Corner					
Control Sta. Name					

~~City, Village or~~ Town Lincoln  
County of Monroe

COUNTY SURVEYOR FORM NO. 1

I, Garold A. Sime, do hereby certify that on the 22nd day of August 1986, I found (evidence) ~~(no evidence)~~ of the NW corner of Section 13, T 19 N, R 1W Fourth Principal Meridian, and I re-established said corner according to the Wisconsin Statutes as shown and described hereon.

Dated this 29th day of Dec. 1986.

Garold A. Sime  
Deputy County Surveyor  
Title

History of corner establishment since Original Government Survey

\*See previous land corner record

Description of corner evidence found:

Found Harrison Monument broke off down 14". Established new ties for corner

**See Reverse Side For Maintenance**

Description of corner and witness monuments, references and accessories used to perpetuate the original or re-established location of this corner:

Ex. Harrison Monument at corner

Witnesses to corner location:

Garold A. Sime, R.L.S.  
Dallas Wilhite  
Joel Tralmer

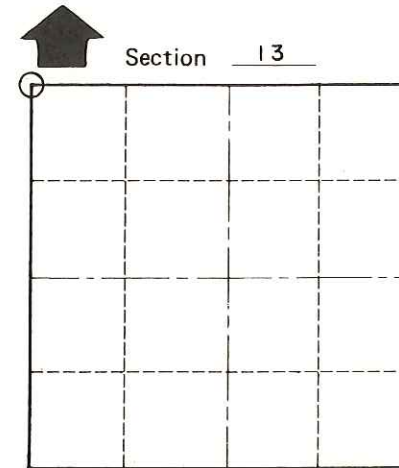
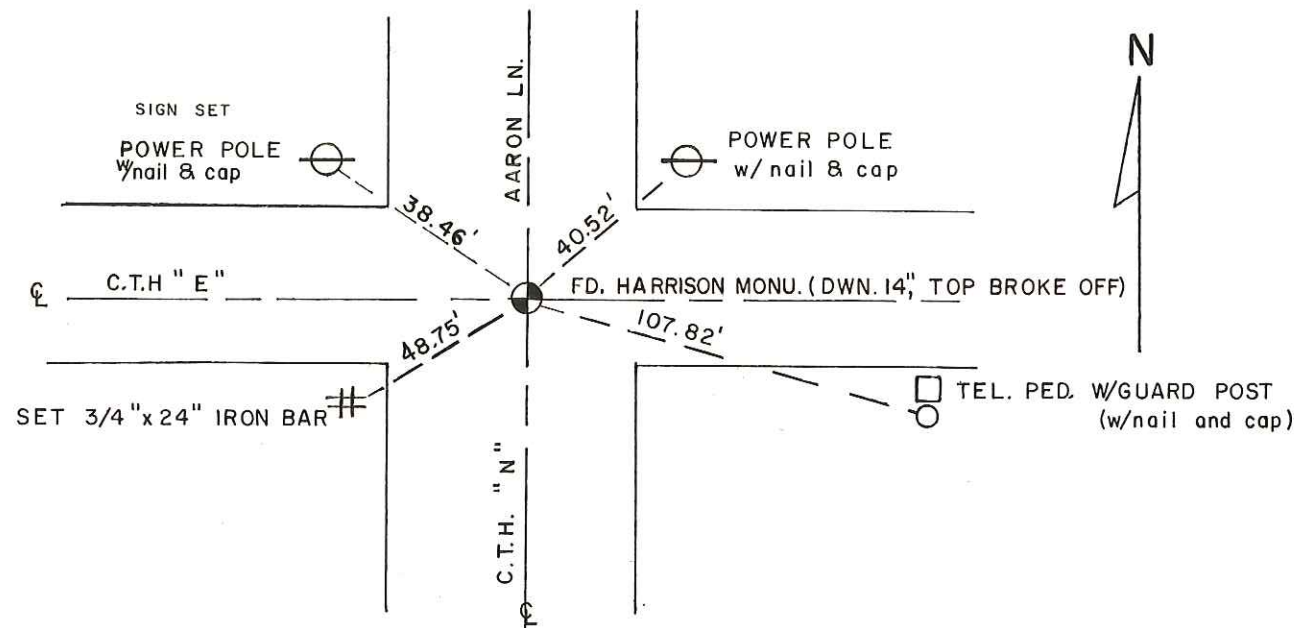

O = LOCATION CORNER

T 19 N R 1W  
WISCONSIN

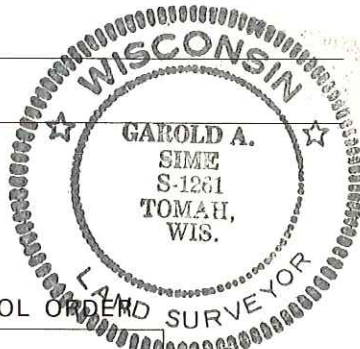

SURVEY CONTROL ORDER

Horizontal	_____
Vertical	_____

WISCONSIN COORDINATE SYSTEM

Corner	East (X)	North (Y)	Elevation (Z)	Zone
Control Sta. Name				

City, Village or Town Lincoln  
County of Monroe

COUNTY SURVEYOR FORM NO. 1

I, Harley A. Sime, do hereby certify that on the 1st day of October 19 75, I found (evidence) (~~no evidence~~) of the Southeast corner of Section 11, T 19 N, R 1 W Fourth Principal Meridian, and I re-established said corner according to the Wisconsin Statutes as shown and described hereon.

History of original corner establishment:

**See Reverse Side For Maintenance**

Dated this 1st day of March 1976.

Description of corner evidence found:

Found a 3/4"x24" iron bar used by D. Marten and F. Zietlow in previous surveys. Removed the bar and replaced it with a Harrison marker.

County Surveyor

Title

**Approved: HARLEY A. SIME  
MONROE CO. SURVEYOR**

Description of corner and witness monuments, references and accessories used to perpetuate the original or re-established location of this corner:

Set a Harrison in the road intersection. There is a R.R. spike 8.05 ft. East of the corner also.

Witnesses to corner location:

W.C. Jung-Chief *W.C. Jung*  
A. Lueck

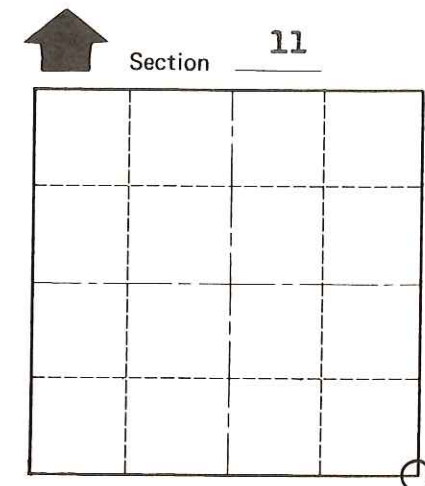
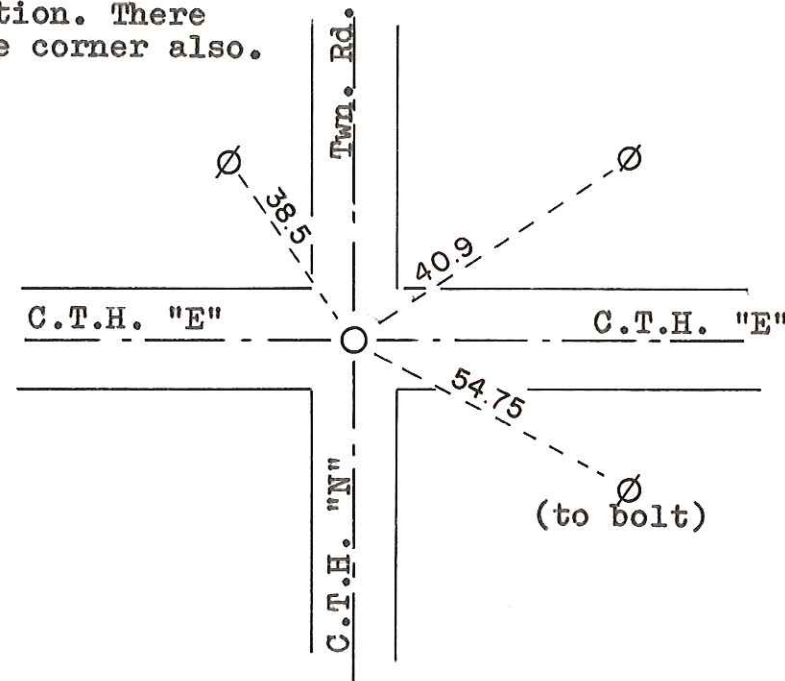
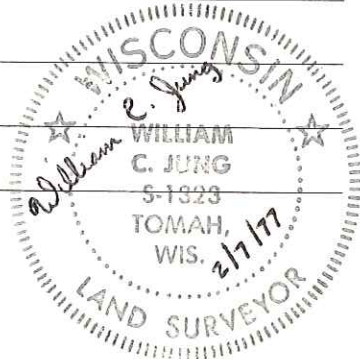

O = LOCATION CORNER  
T 19 N R 1 W  
WISCONSIN

Ø = Power pole

**SIGN PLACED 12/18/86**  
*Sime, Jensen*

SURVEY CONTROL ORDER

Horizontal	_____
Vertical	_____

WISCONSIN COORDINATE SYSTEM

Corner	East (X)	North (Y)	Elevation (Z)	Zone
Control Sta. Name				

City, Village or Town Lincoln

County of Monroe

COUNTY SURVEYOR FORM NO. 1