

21901102000

I, Harley A. Sime, do hereby certify that on the 1st day of October 1975, I found ~~(evidence)~~ (no evidence) of the East 1/4 corner of Section 10, T 19 N, R 1 W Fourth Principal Meridian, and I re-established said corner according to the Wisconsin Statutes as shown and described hereon.

History of original corner establishment:

Approved: **HARLEY A. SIME**  
**MONROE CO. SURVEYOR**

Description of corner evidence found:

Set the corner by splitting the distance between the section corners and "kinking" the bearing so as to match existing field evidence. Set as such, the bearing of the East line of the NE $\frac{1}{4}$  and the bearing of the West line of the NW $\frac{1}{4}$  of Sec. 10 match up to the original notes (in regards to the difference in variation).

Dated this 1st day of March 1976.

County Surveyor

Title

Description of corner and witness monuments, references and accessories used to perpetuate the original or re-established location of this corner:

Set a Harrison marker, up 2".

Witnesses to corner location:

W.C. Jung-Crew Chief *W.C. Jung*

A. Lueck

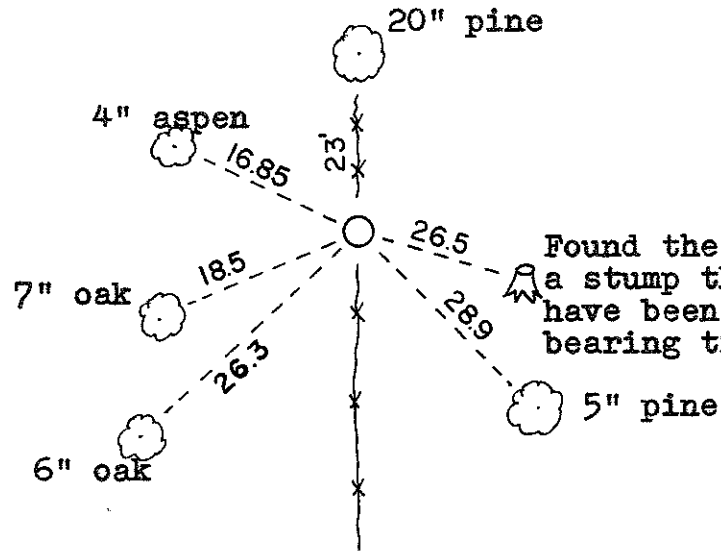
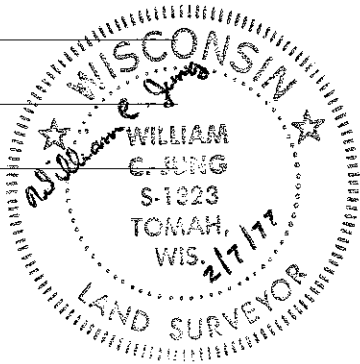

Found the ancient remains of a stump that could possibly have been one of the original bearing trees, though this was not confirmed.

Note: All trees blazed.

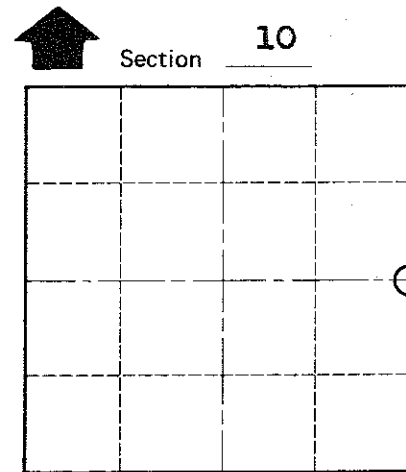

O = LOCATION CORNER

T 19 N R 1 W

WISCONSIN

COUNTY SURVEYOR FORM NO. 1

SURVEY CONTROL ORDER

Horizontal \_\_\_\_\_  
Vertical \_\_\_\_\_

WISCONSIN COORDINATE SYSTEM

Corner	East (X)	North (Y)	Elevation (Z)	Zone
Control Sta. Name				

City, Village or Town Lincoln

County of Monroe