

CERTIFICATE

CERTIFIED LAND CORNER

No. 72

21901180020

I, William C. Jung, do hereby certify that on the 13th day of June 1979, I found ~~evidence~~ ^(no evidence) of the South 1/4 corner of Section 18, T19 N, R1 W Fourth Principal Meridian, and I re-established said corner according to the Wisconsin Statutes as shown and described hereon.

History of corner establishment since Original Government Survey

A.S. Ingalls was at this corner in April of 1873. Duane Marten set an iron bar at this corner in September of 1973.

Description of corner evidence found:

Found the corner of record at the occupied corner, removed the iron bar and replaced it with a Harrison marker.

Dated this 5th day of Feb. 1981.

William C. Jung

William C. Jung, R.L.S. 1323
Title

Approved: **HARLEY A. SIME**
MONROE CO. SURVEYOR

COUNTY SURVEYOR FORM

Description of corner and witness monuments, references and accessories used to perpetuate the original or re-established location of this corner:

Witnesses to corner location:

W. Jung
D. Dade
T. Webb

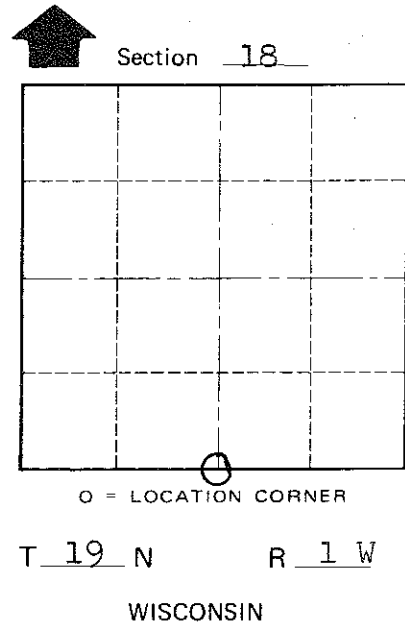
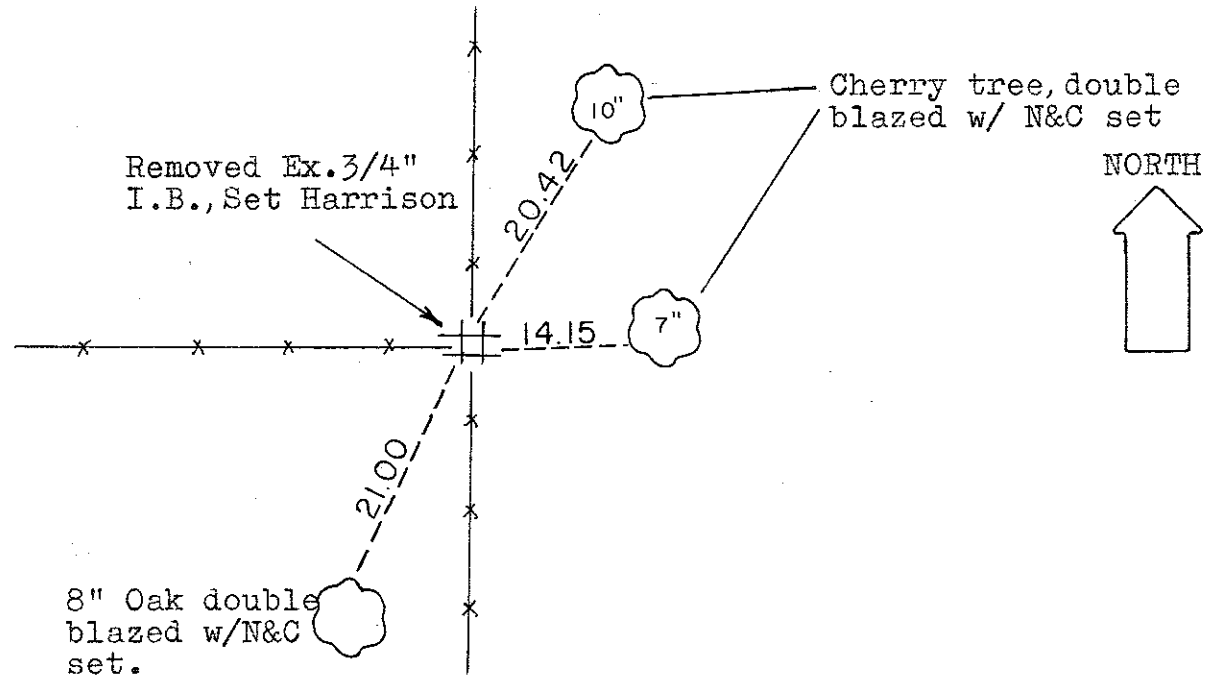
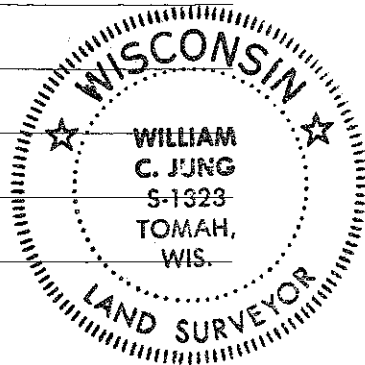

SURVEY CONTROL ORDER

Horizontal _____
Vertical _____

WISCONSIN COORDINATE SYSTEM

Corner	East (X)	North (Y)	Elevation (Z)	Zone
Control Sta. Name				

City, Village or Town Lincoln
County of Monroe