

21901272000

I, Ronald D. Parish, do hereby certify that on the 28th day of December 1987, I found ~~(evidence)~~ (no evidence) of the E 1/4 corner of section 27, T 19 N, R 1 W Fourth Principal Meridian, and I re-established said corner according to the Wisconsin Statutes as shown and described hereon.

Dated this 28th day of Dec. 1987.

Registered Land Surveyor  
Title

History of corner establishment since Original Government Survey  
No known history since the Original Government Survey  
*Holden set iron here in 1901.*

Description of corner evidence found:  
Set corner on line equi-distance between the Northeast corner and the Southeast corner of the Section. This fits a woven wire fence to the west across the drainage ditch.

Description of corner and witness monuments, references and accessories used to perpetuate the original or re-established location of this corner:

Witnesses to corner location:

Ronald D. Parish

Robert Sherwood

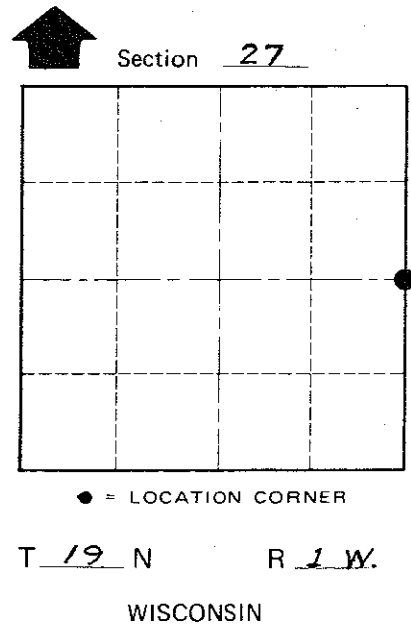
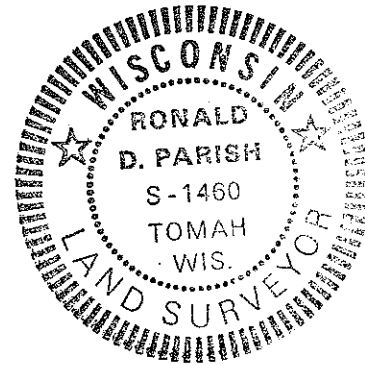
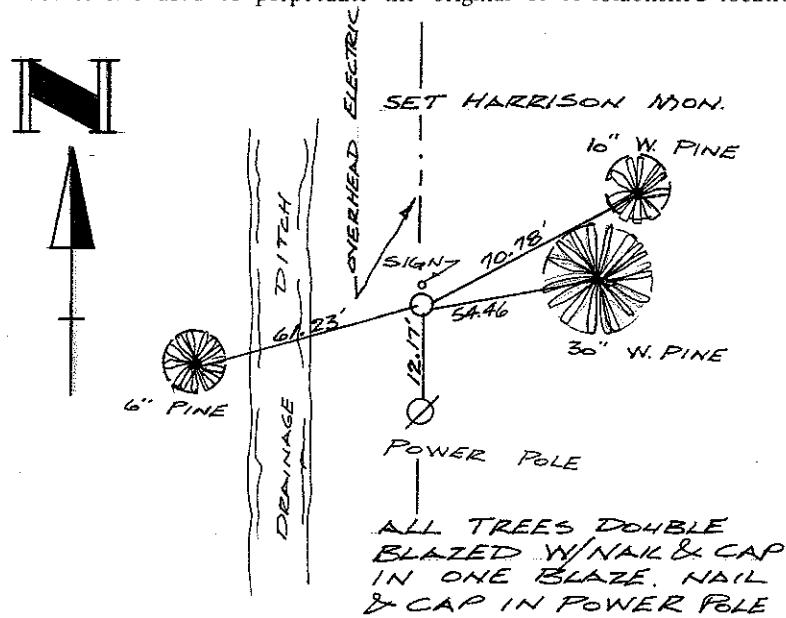

COUNTY SURVEYOR FORM NO. 1

SURVEY CONTROL ORDER

Horizontal	_____
Vertical	_____

WISCONSIN COORDINATE SYSTEM

Corner	East (X)	North (Y)	Elevation (Z)	Zone
Control Sta. Name				

Range or Town Lincoln

County of Monroe