

**U.S. PUBLIC LAND CORNER
MAINTENANCE**

86

**Corner ID: N1/4 Sec.27, T19N-R1W
21901220020**

<u>DATE</u>	<u>CREW</u>	<u>MONUMENT INFO</u>
July 16, 2020	Zachariah P. Dechant Gary L. Dechant	Found Harrison, top broke off, down 8", sign 1' north

	<u>Compass Bearing</u>	<u>Distance</u>
1) Set 2' section of T post, down 6", 4' NW of 10" White oak	S70E	17.50'
2) Existing 1/4" iron pipe, up 6" with steel post, NE corner Vol 18 CSM , P 65	South	48.18' (48.00')
3) Set 2' section of T post, down 6", 4' NE of 12" Maple	S60W	44.39'
4) Set 2' section of T post, down 6", 3' east of 6" Maple	West	23.33'

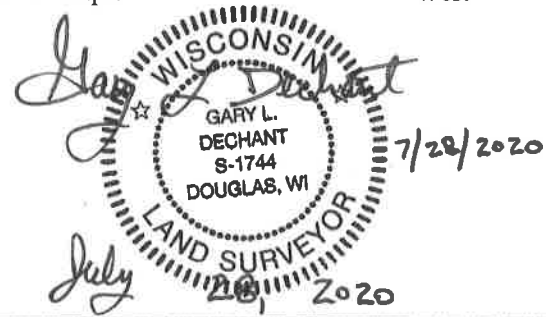

CERTIFICATE

I, Douglas J. Malliet, do hereby certify that on the 19th day of April 1978, I found (evidence) (no evidence) of the N¹/₄ corner of Section 27, T19 N, R 1 W, Fourth Principal Meridian, and I re-established said corner according to the Wisconsin Statutes as shown and described hereon.

Dated this 19th day of May 1978.

Douglas J. Malliet

REGISTERED LAND SURVEYOR, S-1266
Title

CERTIFIED LAND CORNER

No. 86

History of original corner establishment:

No subsequent history of monument perpetuation since the original U.S. Government Survey, except for reference to this corner in a plat of survey by J. Carroll. See explanation below.

Description of corner evidence found:

This corner was established half-way and on line between a Harrison at the NE corner of Sec. 27 and the NW corner of Sec. 27 as I have established it. This location does not agree with the occupied fence corner at this location. The established corner falls approximately 55.3' North and 170.3' East of the occupied corner. there are several reasons I didn't use the occupied corner. First, using the occupied corner produced a 1°30' kink in the section line and produced distances to the East and West far to long and short, respectively. A nearby landowner residing in the vicinity of this corner location and having knowledge of the area, told me personally that fences in this area had been moved, perhaps considerably, by a former landowner. I didn't use the corner as

Description of corner and witness monuments, references and accessories used to perpetuate the original or re-established location of this corner:

Witnesses to corner location:

Douglas J. Malliet

Lawrence A. Feddersen

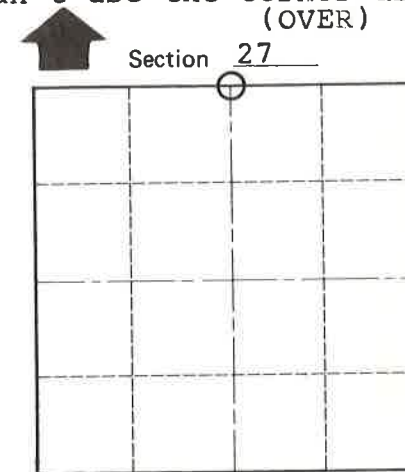
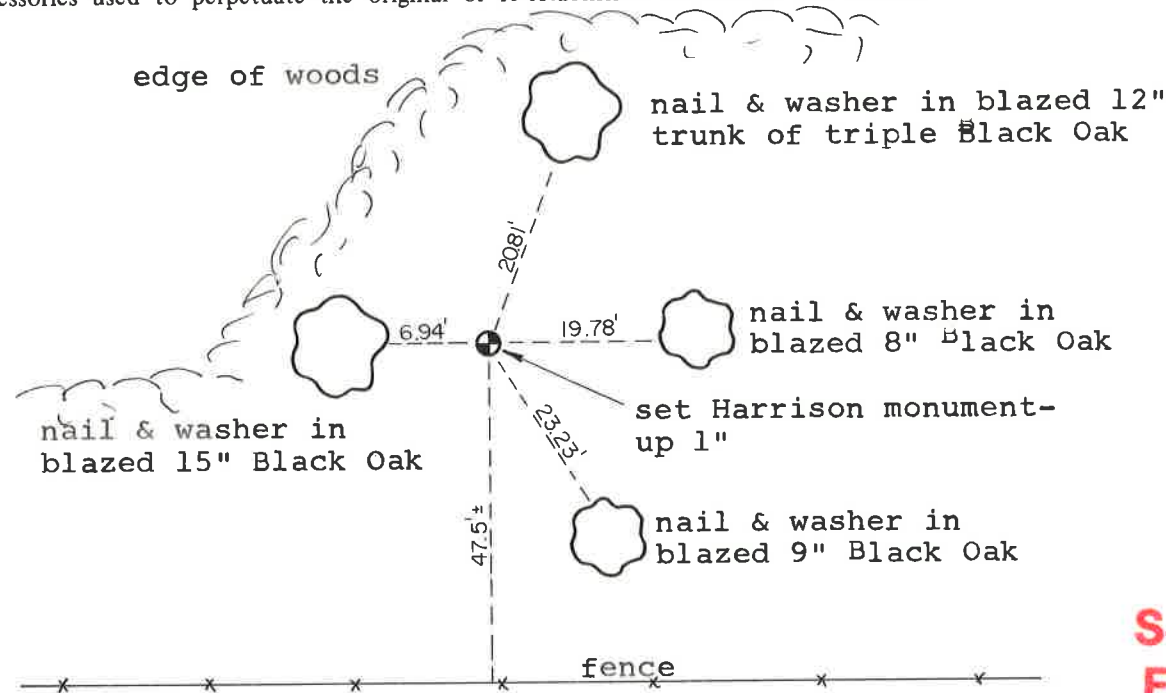

O = LOCATION CORNER

T 19 N R 1 W

WISCONSIN

See Reverse Side For Maintenance

COUNTY SURVEYOR FORM NO. 1

SURVEY CONTROL ORDER

Horizontal	_____
Vertical	_____

WISCONSIN COORDINATE SYSTEM

Corner	East (X)	North (Y)	Elevation (Z)	Zone
Control Sta. Name				

City, Village or Town of LINCOLN

County of MONROE

(CON'T.)

established by J. Carroll in Feb., 1977, as I believe it was incorrectly established, according to information obtained from him, written & verbal. Lastly, the bearing of the North line of Sec. 27 as I established it agrees fairly well with the bearing of the South line of Sec. 27 as I established it.