

21901210020

I, Harley A. Sime, do hereby certify that on the 19th day of March 1982, I found (evidence) (~~was~~) of the N/4 corner of Section 28, T 19 N, R 1 W Fourth Principal Meridian, and I re-established said corner according to the Wisconsin Statutes as shown and described hereon.

History of corner establishment since Original Government Survey  
No known recorded history since the original government survey.

Description of corner evidence found:

Accepted occupied fence corner as the best available evidence as it fits other field evidence well.

Dated this 29th day of March 1982.

Harley A. Sime, R.L.S. 355

County Surveyor

Approved: **HARLEY A. SIME**  
**MONROE CO. SURVEYOR**

Description of corner and witness monuments, references and accessories used to perpetuate the original or re-established location of this corner:

COUNTY SURVEYOR FORM N

Witnesses to corner location:

G. Dechant (D)

B. Meyer (M)

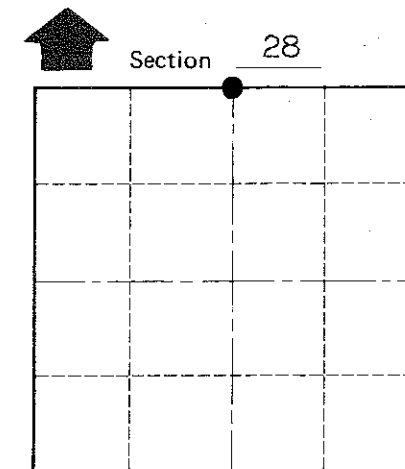
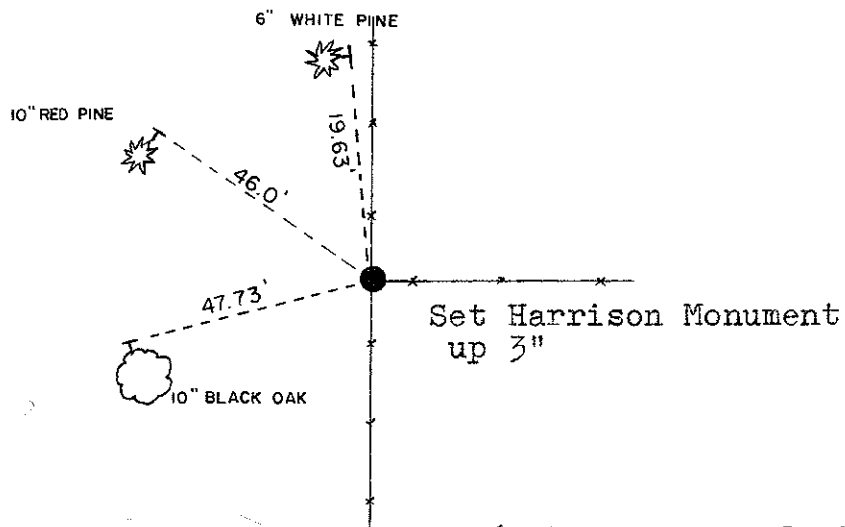
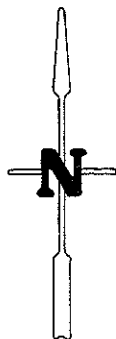

T 19 N R 1 W

WISCONSIN

(All trees double blazed, scribed, with nail set on side of tree, distance to nail)

SURVEY CONTROL ORDER

Horizontal	_____
Vertical	_____

WISCONSIN COORDINATE SYSTEM

Corner	East (X)	North (Y)	Elevation (Z)	Zone
Control Sta. Name				

~~City, Village or Town~~ Lincoln  
County of Monroe