

CERTIFICATE

CERTIFIED LAND CORNER

No. 114 E

21901313010

I, Harley A. Sime, do hereby certify that on the 2 day of February 19 78, I found ~~(evidence)~~ (no evidence) of the C 1/16 NE corner of Section 31, T. 19 N., R. 1 W. Fourth Principal Meridian, and I re-established said corner according to the Wisconsin Statutes as shown and described hereon.

History of original corner establishment:

Description of corner evidence found:

Set as Per Law after surveying exterior of Section

Dated this 6th day of Feb. 19 78.

Approved: **HARLEY A. SIME**

County Surveyor **MONROE CO. SURVEYOR**
Title

COUNTY SURVEYOR FORM NO. 1

Description of corner and witness monuments, references and accessories used to perpetuate the original or re-established location of this corner:

Set 1 1/4" x 30" Round Iron Bar

Witnesses to corner location:

G.A. Sime, Crew Chief *G.A. Sime*

C. Pietz

G. Dechant

L. Radcliffe

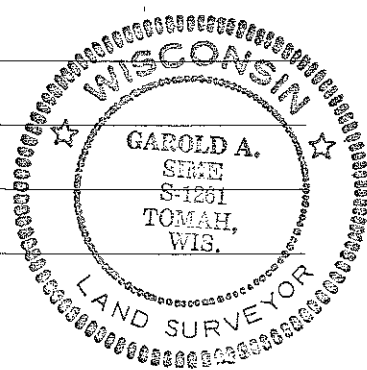

14" WHITE OAK

14" BLACK OAK

N & C IN POWER POLE

TRAVELED

CENTERLINE

AUBURN CT.

1 1/4" IRON BAR

4" WHITE PINE

Not blazed and no nail and cap set

All trees blazed and nail and cap set unless otherwise noted

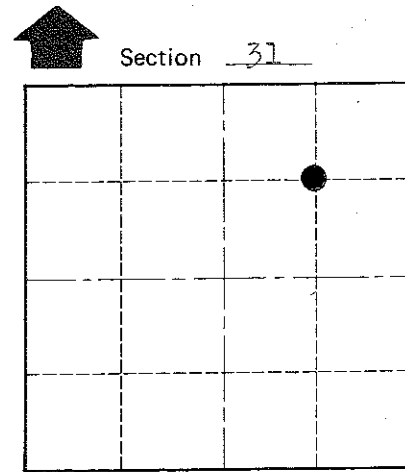
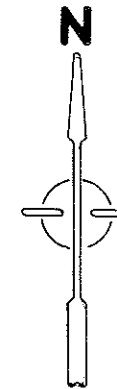

O = LOCATION CORNER

T 19 N R 1 W

WISCONSIN

SURVEY CONTROL ORDER

Horizontal	_____
Vertical	_____

WISCONSIN COORDINATE SYSTEM

Corner	East (X)	North (Y)	Elevation (Z)	Zone
Control Sta. Name				

City, Village or Town Lincoln

County of Monroe