

CERTIFICATE

CERTIFIED LAND CORNER

No. 114 D

21901313000

I, Harley A. Sime, do hereby certify that on the 2 day of February 19 78, I found ~~(evidence)~~ (no evidence) of the E 1/16 NE corner of Section 31, T 19 N, R 1W Fourth Principal Meridian, and I re-established said corner according to the Wisconsin Statutes as shown and described hereon.
Dated this 6th day of Feb. 19 78.

History of original corner establishment:

Description of corner evidence found:

Set as Per Law after surveying exterior of Section

County Surveyor

Title

Description of corner and witness monuments, references and accessories used to perpetuate the original or re-established location of this corner:

Set 1 1/4" x 30" Round Iron Bar

Witnesses to corner location:

G.A.Sime, Crew Chief *G.A. Sime*
C. Pietz
G. Dechant
L. Radcliffe

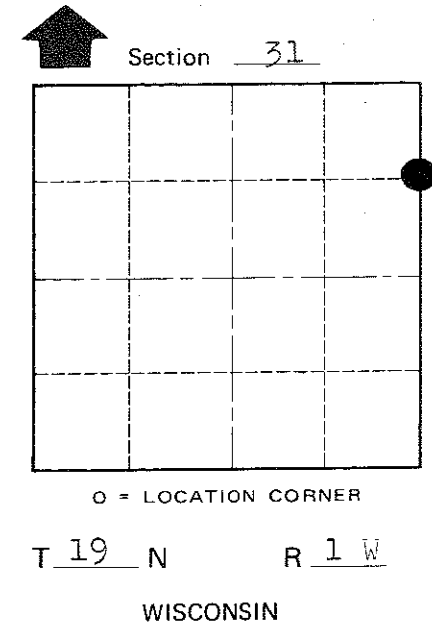
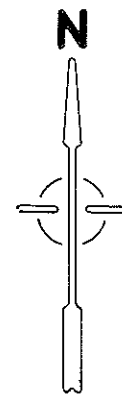
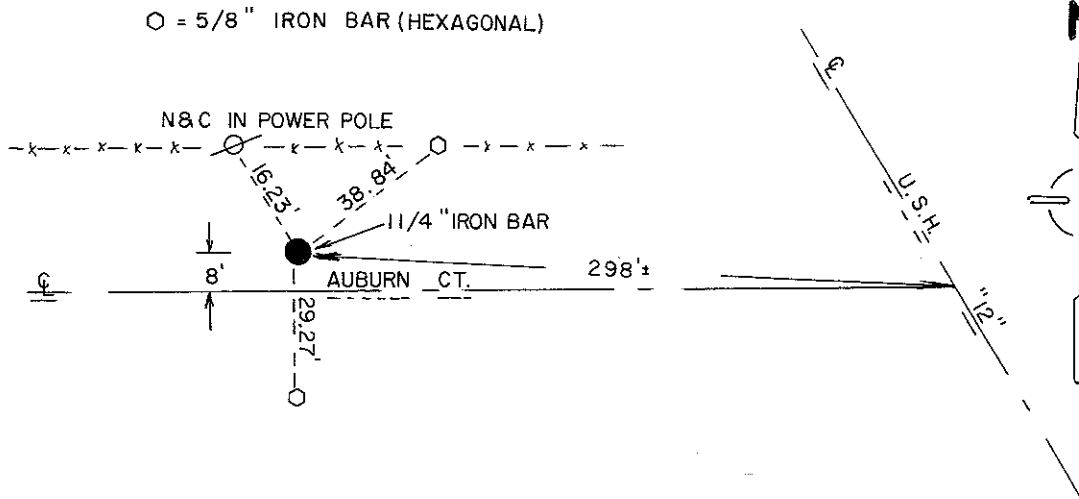
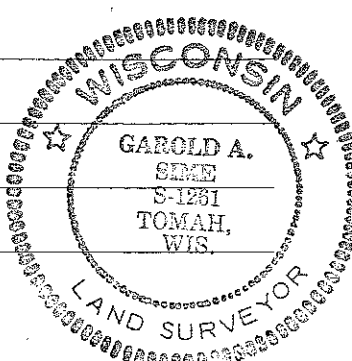

COUNTY SURVEYOR FORM NO. 1

SURVEY CONTROL ORDER

Horizontal _____
Vertical _____

WISCONSIN COORDINATE SYSTEM

| Corner | East (X) | North (Y) | Elevation (Z) | Zone |
|-------------------|----------|-----------|---------------|------|
| Control Sta. Name | | | | |

City, Village or Town Lincoln

County of Monroe