

CERTIFICATE

CERTIFIED LAND CORNER

No. 114c

**21901312010**

I, Harley A. Sime, do hereby certify that on the 2 day of February 19 78 I found (evidence) (no evidence) of the CEL/16 corner of Section 31, T 19 N, R 1W, Fourth Principal Meridian, and I re-established said corner according to the Wisconsin Statutes as shown and described hereon.  
 Dated this 6<sup>th</sup> day of Feb. 19 78.

History of original corner establishment:

Description of corner evidence found:  
 Set as Per Law after surveying exterior of Section

County Surveyor  
 Title

Description of corner and witness monuments, references and accessories used to perpetuate the original or re-established location of this corner:

Set 1 1/4 x 30" Round Iron Bar

Witnesses to corner location:

G. A. Sime, Crew Chief G. A. Sime

C. Pietz

G. Dechant

L. Radcliffe

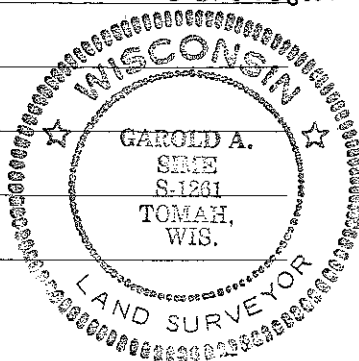

Trees blazed and nail and cap set

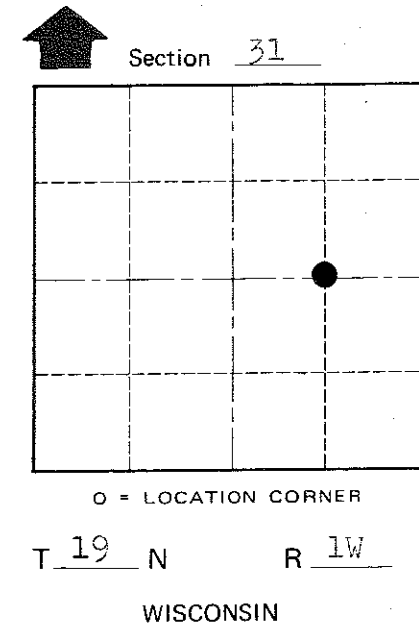
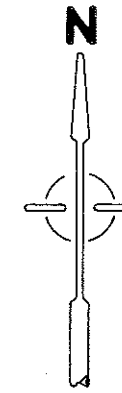
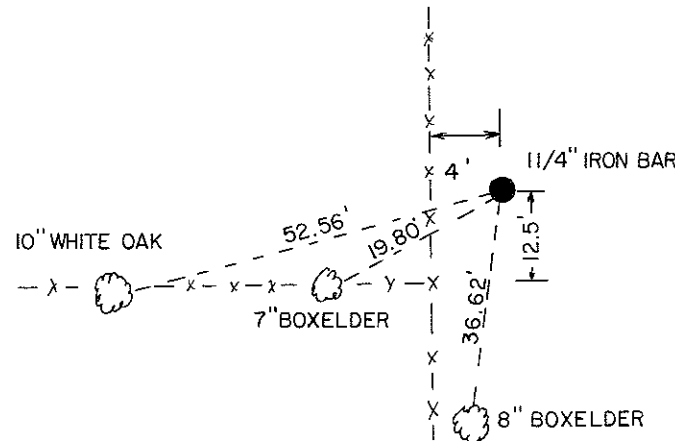

COUNTY SURVEYOR FORM NO. 1

SURVEY CONTROL ORDER

Horizontal	_____
Vertical	_____

WISCONSIN COORDINATE SYSTEM

Corner	East (X)	North (Y)	Elevation (Z)	Zone
Control Sta. Name				

City, Village or Town Lincoln  
 County of Monroe