

CERTIFICATE

CERTIFIED LAND CORNER

No. 114 L

**21901311020**

I, Harley A. Sime, do hereby certify that on the 2 day of February 19 78, I found ~~(evidence)~~ (no evidence) of the CS 1/16 corner of Section 31, T 19 N, R 1 W Fourth Principal Meridian, and I re-established said corner according to the Wisconsin Statutes as shown and described hereon.  
Dated this 6<sup>th</sup> day of Feb. 19 78.

History of original corner establishment:

Description of corner evidence found:

Set as per law after surveying exterior of Section

County Surveyor  
Title

COUNTY SURVEYOR FORM NO. 1

Description of corner and witness monuments, references and accessories used to perpetuate the original or re-established location of this corner:

Set 1 1/4" x 30" Round Iron Bar

Witnesses to corner location:

G.A. Sime, Crew Chief B.A. Sime

L. Radcliffe

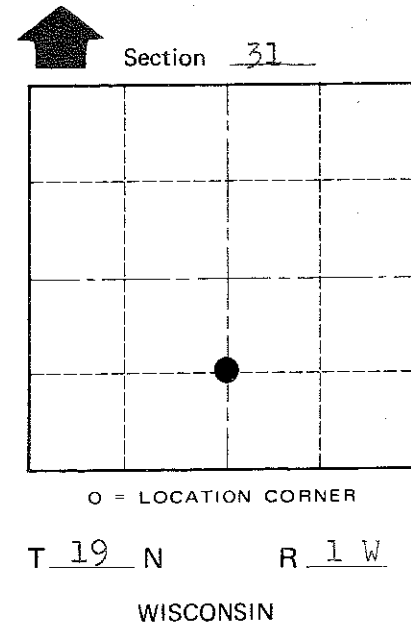
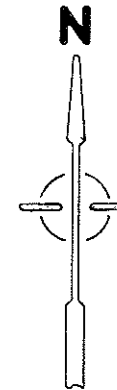
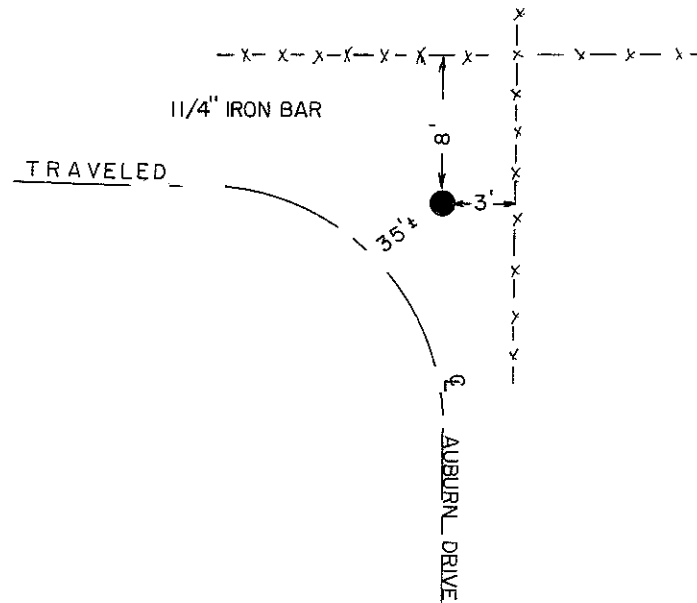
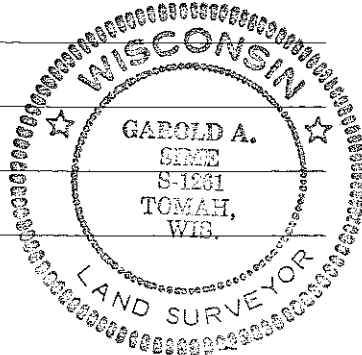

SURVEY CONTROL ORDER

Horizontal	_____
Vertical	_____

WISCONSIN COORDINATE SYSTEM

Corner	East (X)	North (Y)	Elevation (Z)	Zone
Control Sta. Name				

City, Village or Town Lincoln  
County of Monroe