

CERTIFICATE

I, Bryan H. Meyer, do hereby certify that on the 30th day of July 19 93, I found ~~(no evidence)~~ (no evidence) of the South 1/4 corner of Section 34, T 19 N, R 1 W Fourth Principal Meridian, and I re-established said corner according to the Wisconsin Statutes as shown and described hereon.

Dated this 2nd day of Aug. 19 93.

Bryan H. Meyer  
Deputy County Surveyor  
Title

CERTIFIED LAND CORNER

History of corner establishment since Original Government Survey

This corner was set in error in December of 1974.

Description of corner evidence found:

Gary Dechant had done some surveying in this area and informed the County surveyor's Office that the location of the monument at this corner appeared to be incorrect. I checked the distances to the West, North and East and found that the monument was indeed in an incorrect location. I removed the Harrison marker of record and set a 2 1/2" x 8' iron pipe at the intended location from 1974.

No. 126

**21901340020**

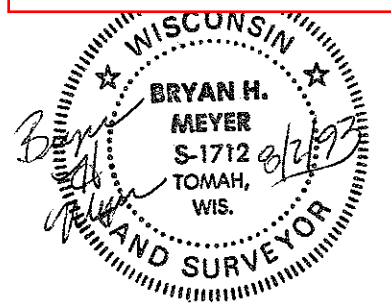

Bryan H. Meyer  
H. A. Sime and Associates  
P. O. Box 705  
Tomah, Wisconsin 54660  
Phone: (608)-372-5392

COUNTY SURVEYOR FORM NO. 1

Description of corner and witness monuments, references and accessories used to perpetuate the original or re-established location of this corner:

Crew: Meyer, Lobe  
Date: July 30, 1993  
Weather: P. Cloudy, 80°±  
Witnesses to corner location:

Bryan H. Meyer  
Rick Lobe

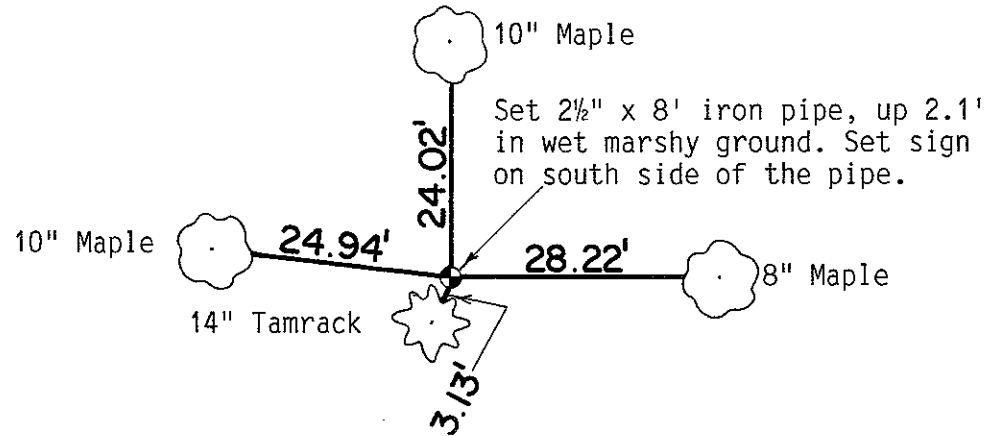

The four trees shown are double blazed with the blazes facing the corner. The distance shown to each tree is to a nail set in a hack in the side of each tree.

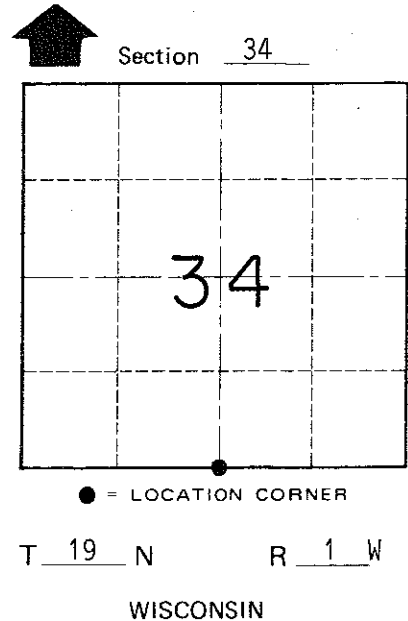

SURVEY CONTROL ORDER

Horizontal	_____
Vertical	_____

WISCONSIN COORDINATE SYSTEM

Corner	East (X)	North (Y)	Elevation (Z)	Zone
Control Sta. Name				

~~City/Village of~~ Town of Lincoln  
County of Monroe