

# 127

**U.S. PUBLIC LAND CORNER  
MAINTENANCE**

**Corner ID :** SE Sec. 33, T19N-R1W  
**21901330000**

<u>DATE</u>	<u>CREW</u>	<u>MONUMENT TYPE -----</u>
September 1, 2015	Zachariah P. Dechant Gary L. Dechant	Existing Harrison intact, down 12" On line with fence to east, on east side of driveway Fire No. 7326 Division Road. All old ties gone.

References:

	<u>Bearing</u>	<u>Distance</u>
1) Set 3/4"x24" round iron bar, down 6", 1' west of south end of gate	N36E	32.90'
2) Set 3/4"x24" round iron bar, down 6", 1' north of wood post fence running east	N83E	9.72'
3) Set 3/4"x24" round iron bar, down 12" in field	S36W	87.34'
4) Set 3/4"x24" round iron bar, down 6", 2' east of address sign	S83W	38.36'

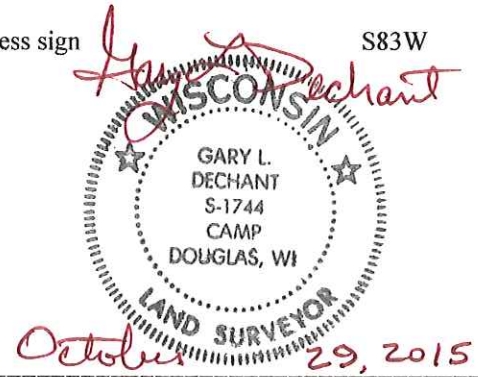

I, Harley A. Sime, do hereby certify that on the \_\_\_\_\_ day of \_\_\_\_\_ 1974, I found (evidence) (~~no evidence~~) of the Southwest corner of Section 34, T 19 N, R 1 W, Fourth Principal Meridian, and I re-established said corner according to the Wisconsin Statutes as shown and described hereon.

Dated this 7th day of Feb. 1977.

\_\_\_\_\_  
County Surveyor  
Title

History of original corner establishment:  
**Approved: HARLEY A. SIME**  
**MONROE CO. SURVEYOR**

**See Reverse Side**  
**For Maintenance**

Description of corner evidence found:

Duane Marten found a 1½" iron pipe at this corner on December 24, 1971. The pipe had been used in previous survey work. He removed the pipe and set a Harrison marker in its place. K. Pritzlaff found this Harrison in 1974. I have used this marker since then.

Description of corner and witness monuments, references and accessories used to perpetuate the original or re-established location of this corner:

**Existing Harrison marker. It is in the ditch, 7.2 feet South of the fence, and 41'± Northeast of the Town Road centerline.**

Witnesses to corner location:

K. Pritzlaff-Crew Chief  
A. Lueck  
W.C. Jung-Witness W.C. Jung  
G. Dechant

Set an iron bar at the West end of # the gate.

Set an iron bar #

SHED

N&C in stump



WISCONSIN COORDINATE SYSTEM

SURVEY CONTROL ORDER

Horizontal	_____
Vertical	_____

Corner	East (X)	North (Y)	Elevation (Z)	Zone
Control Sta. Name				

City, Village or Town Lincoln

County of Monroe

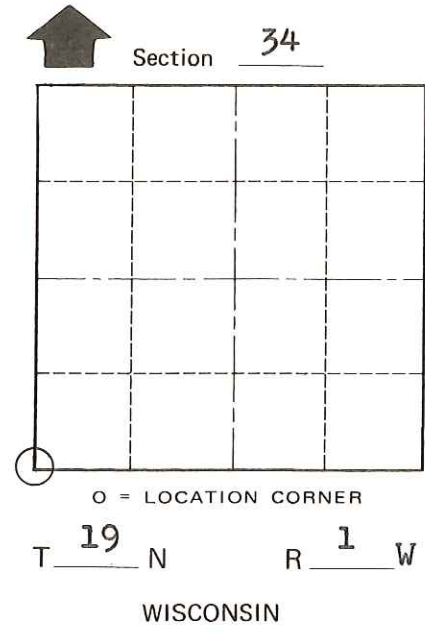

COUNTY SURVEYOR FORM NO. 1