

36

**U.S. PUBLIC LAND CORNER
MAINTENANCE**

**Corner ID : E1/4 Sec.8, T19N-R1W
21901082000**

<u>DATE</u>	<u>CREW</u>	<u>MONUMENT TYPE</u> -----
May 6, 2015	Zachariah P.Dechant Gary L. Dechant	Existing Harrison intact, down 8", in centerline of driveway at 2496 Atlantic Road, 88' NE of Railroad

<u>References:</u>	<u>Bearing</u>	<u>Distance</u>
1) Set 3/4"x24" round iron bar, down 6", 6' SE of 36" Black Oak	N70E	40.28'
2) Set 3/4"x24"round iron bar, down 6", 92' north of Railroad centerline	S63E	44.45'
3) Set 3/4"x24" round iron bar, down 6", 92' north of railroad,between first two south rows of Red Pine	N58W	33.49'
4) Set 3/4"x24" round iron bar, down 6", SE of 12" Red Pine south of trail	N25W	48.44'

Gary L. Dechant

October 28, 2015

CERTIFICATE

CERTIFIED LAND CORNER

No. 36

I, Harley A. Sime, do hereby certify that on the 15th day of June 1973, I found ~~(evidence)~~ (no evidence) of the East 1/4 corner of Section 8, T 19 N, R 1 W Fourth Principal Meridian, and I re-established said corner according to the Wisconsin Statutes as shown and described hereon.

Dated this 1st day of March 1976.

History of original corner establishment:

O.R. Dahl, Co. Surveyor, was at this corner on Feb. 14, 1871.

See Reverse Side For Maintenance

Description of corner evidence found:

Set the corner on line with the existing fence going North and at the record distance from the S.E. corner of Section 8.

County Surveyor Approved: HARLEY A. SIME
Title MONROE CO. SURVEYOR

COUNTY SURVEYOR FORM NO. 1

Description of corner and witness monuments, references and accessories used to perpetuate the original or re-established location of this corner:

Set a Harrison marker, down 6", in the East track of a driveway.

Witnesses to corner location:

D. Marten - Crew Chief

Found the Harrison in good condition in November of 1977. WC Jung

SURVEY CONTROL ORDER

Horizontal	_____
Vertical	_____

WISCONSIN COORDINATE SYSTEM

Corner	East (X)	North (Y)	Elevation (Z)	Zone
Control Sta. Name				

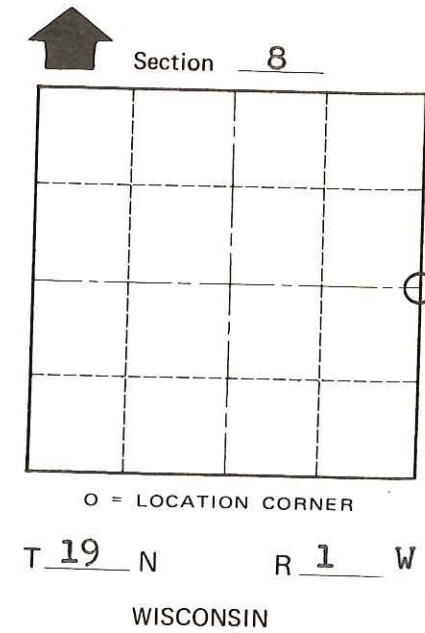
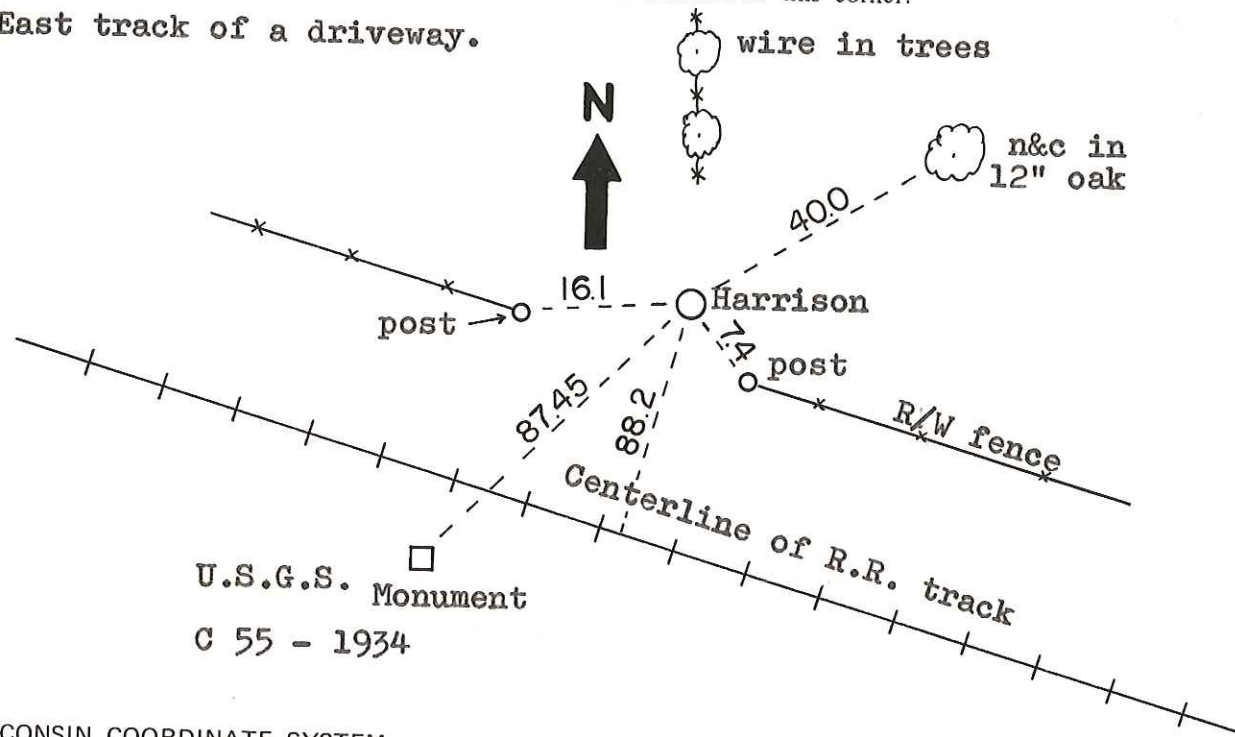

City, Village or Town Lincoln

County of Monroe