

16

**U.S. PUBLIC LAND CORNER
MAINTENANCE**

**Corner ID : E1/4 Sec. 5, T19N-R1W
21901052000**

<u>DATE</u>	<u>CREW</u>	<u>MONUMENT TYPE</u> -----
November 4, 2015	Zachariah P.Dechant Gary L. Dechant	Set 3/4"x6' hexagon iron bar inside of rotted 3" iron pipe Falls in Lake , loose ground

References:

	<u>Bearing</u>	<u>Distance</u>
1) Set 3/4"x24", iron bar ,down 6", 3' north of treated 4"x6"wood post	N72°52'25"E	34.09'
2) Set 3/4"x24" iron bar, down 6", NW side of canoe rack	S32°59'38"E	48.74'
3) Set 3/4"x24" iron bar, down 6 , 4' SE of 16" Black Oak	N38°37'25"W	39.35'
4) Set 3/4"x24" iron bar, down 6", 3' west of 14" White Pine 6' west of fence	N8°49'51"W	39.49'

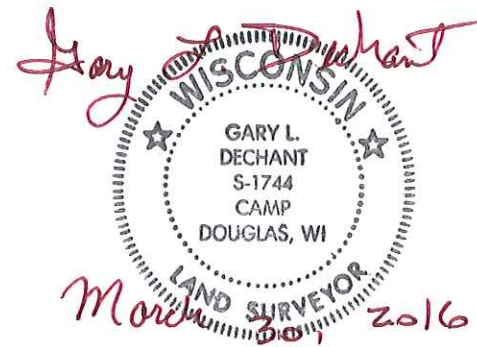

I, Bryan H. Meyer, do hereby certify that on the 22nd day of July 19 83, I found (evidence) ~~no evidence~~ of the West 1/4 corner of Section 4, T 19 N, R 1 W Fourth Principal Meridian, and I re-established said corner according to the Wisconsin Statutes as shown and described hereon.

Dated this 20th day of Dec. 19 83.

Bryan H. Meyer
Deputy County Surveyor
Title

History of corner establishment since Original Government Survey

Duke Marten was here in July of 1973 and found a 3" iron pipe, up 1' from water level.

Description of corner evidence found:

Found 3" iron pipe in water. Pipe was very loose. Removed said pipe and replaced it with a 3"x78" iron pipe, up 14"±.

See Reverse Side For Maintenance



COUNTY SURVEYOR FORM NO. 1

Description of corner and witness monuments, references and accessories used to perpetuate the original or re-established location of this corner:

Crew: Meyer, Wilhite
Date: July 22, 1983 - 2:00 P.M.
Weather: Humid, Overcast, 85°±.

Witnesses to corner location:

Bryan H. Meyer

Dallas Wilhite

APPROVED: Harley A. Sime
Monroe County Surveyor

SURVEY CONTROL ORDER

Horizontal	_____
Vertical	_____

The four trees shown are single blazed. The distances shown are to nails set in each blaze.

WISCONSIN COORDINATE SYSTEM

Corner	East (X)	North (Y)	Elevation (Z)	Zone
Control Sta. Name				

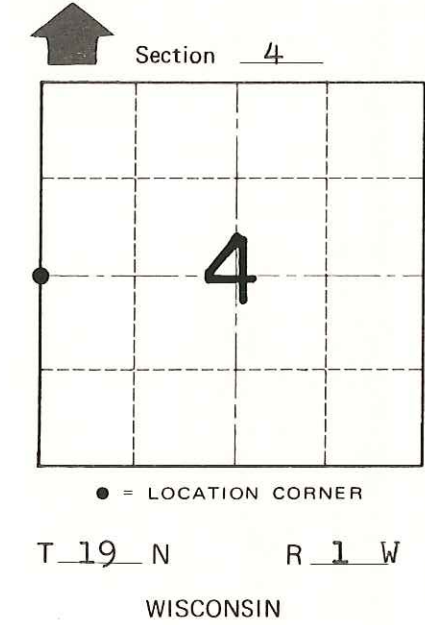
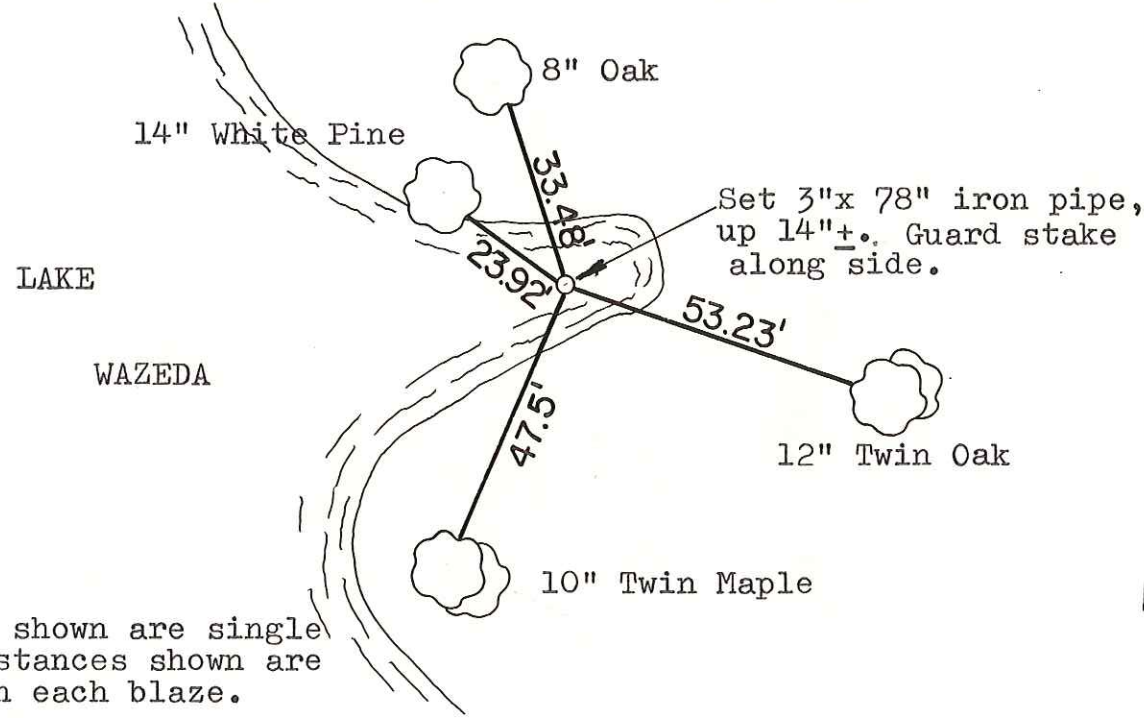

~~City, Village or~~ Town of Lincoln
County of Monroe

I, Harley A. Sime, do hereby certify that on the 3rd day of November 1972, I found (evidence) (~~no evidence~~) of the West 1/4 corner of Section 4, T 19 N, R 1 W Fourth Principal Meridian, and I re-established said corner according to the Wisconsin Statutes as shown and described hereon.

History of original corner establishment:

Description of corner evidence found:

Dated this 1st day of March 1976.

Found a 3" pipe at the corner.

See Reverse Side For Maintenance

County Surveyor **Approved: HARLEY A. SIME**
Title **MONROE CO. SURVEYOR**

Description of corner and witness monuments, references and accessories used to perpetuate the original or re-established location of this corner:

Found a 3" pipe, up 1 ft., at the corner with an iron T-bar as a guard stake. The corner falls in the water.

Witnesses to corner location:

D. Marten

F. Zietlow

G. Sime

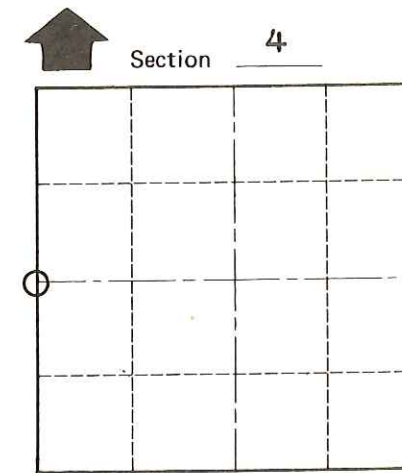
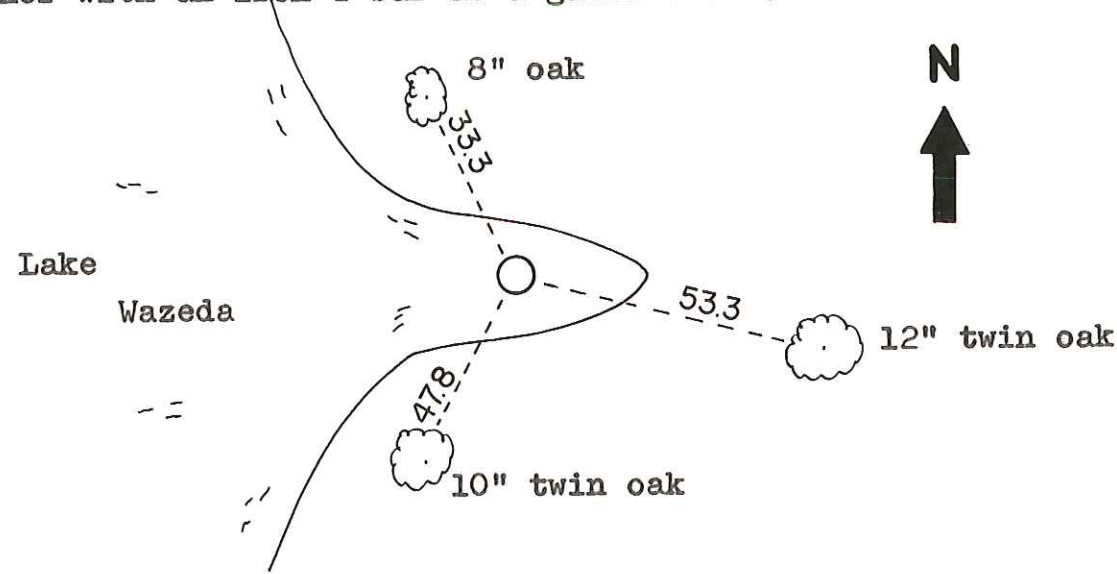

O = LOCATION CORNER
T 19 N R 1 W
WISCONSIN

Note: All trees have nails and caps in them.

SURVEY CONTROL ORDER

Horizontal	_____
Vertical	_____

WISCONSIN COORDINATE SYSTEM

Corner	East (X)	North (Y)	Elevation (Z)	Zone
Control Sta. Name				

City, Village or Town Lincoln

County of Monroe

COUNTY SURVEYOR FORM NO. 1