

52

U.S. PUBLIC LAND CORNER MAINTENANCE

Corner ID : S1/4 Sec. 7, T19N-R1E

41901070020

DATE	CREW	MONUMENT TYPE -----
May 27, 2016	Zachariah P.Dechant Gary L. Dechant	Drove existing 1/4" iron bar down 10" because of road construction

References:

	<u>Bearing</u>	<u>Distance</u>
1) Set 3/4"x24" round iron bar, down 6", in line with row of walnuts to east	N42E	80.89'
2) Set 3/4"x24" round iron bar, down 6", north edge pine plantation	S14E	39.19'
3) Existing 3/4" round iron bar, 4' north of power pole	S42W	28.60' (28.55')
4) Set 3/4"x24"round iron bar, down 6" in center of trail	N14W	59.72'

1/4" iron bar and reference markers set on straight lines.



41901070020

I, Garold A. Sime, do hereby certify that on the 24th day of December 1986, I found ~~evidence~~ (no evidence) of the N¹/₄ corner of Section 18, T 19 N, R 1E Fourth Principal Meridian, and I re-established said corner according to the Wisconsin Statutes as shown and described hereon.

Dated this 29th day of Dec. 1986.

Garold A. Sime
Deputy County Surveyor
Title

History of corner establishment since Original Government Survey

Kennedy was near this corner in early 1937, he makes no mention of actually locating this corner
The Town Road records call for the north line of the NE¹/₄ of Sec.18 as being on the centerline of the road.

Description of corner evidence found:

I established this corner on line with the centerline of C.T.H. "E" projected west and at a distance prorated to Kennedy's given for said line prorated to the orig.notes.

See Reverse Side For Maintenance

COUNTY SURVEYOR FORM NO. 1

Description of corner and witness monuments, references and accessories used to perpetuate the original or re-established location of this corner:

Set 1 1/4" x 15" round iron bar at corner

Witnesses to corner location:

Garold A. Sime, R.L.S.

Dallas Wilhite

John Kenworthy

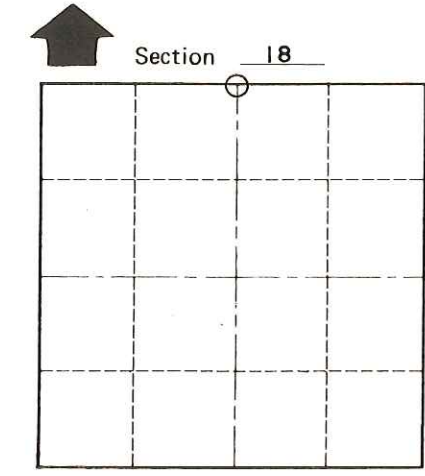
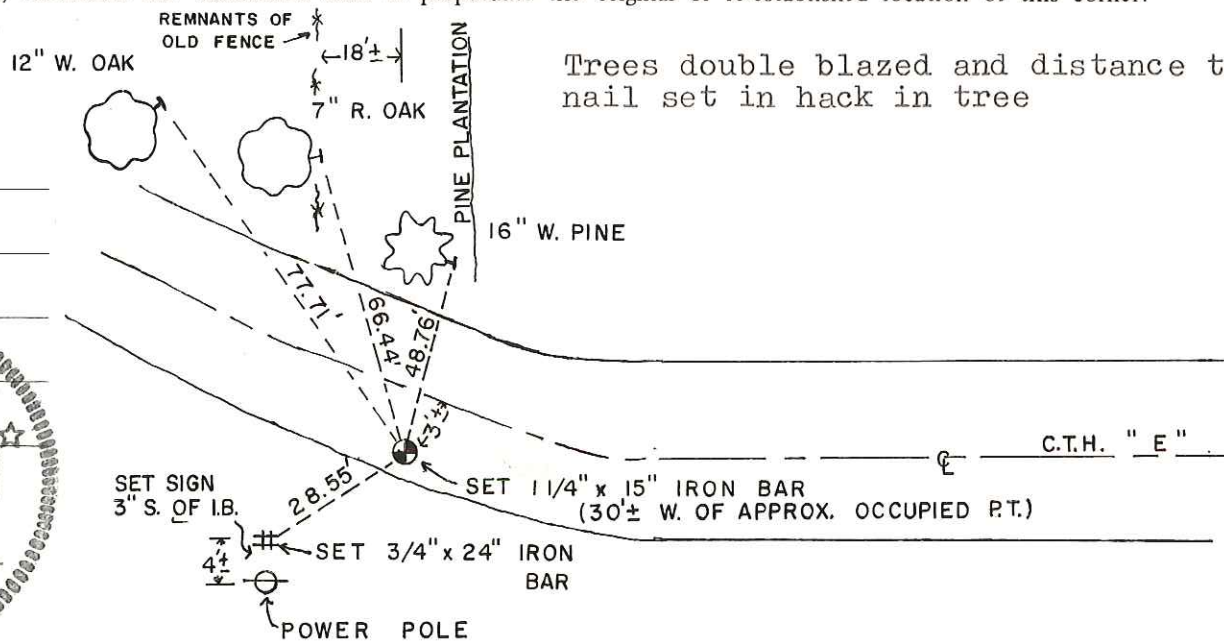
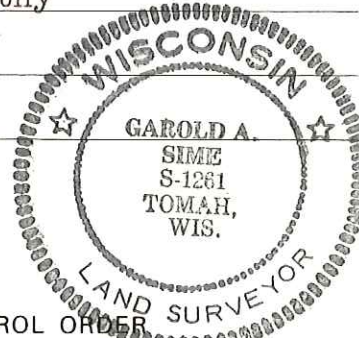

O = LOCATION CORNER
T 19 N R 1E
WISCONSIN

SURVEY CONTROL ORDER

Horizontal	_____
Vertical	_____

WISCONSIN COORDINATE SYSTEM

Corner	East (X)	North (Y)	Elevation (Z)	Zone
Control Sta. Name				

City, Village or Town Scott
County of Monroe