

59

**U.S. PUBLIC LAND CORNER
MAINTENANCE**

Corner ID : E1/4 Sec.14, T19N-R1E
41901142000

<u>DATE</u>	<u>CREW</u>	<u>MONUMENT TYPE -----</u>
December 6, 2014	Zachariah P. Dechant Gary L. Dechant	Found Harrison intact. In forest approx. 600' south of STH "173". All newer BT's in good shape.

References:

	<u>Bearing</u>	<u>Distance</u>
1) Set 3/4"x24" iron bar, down 6"	N89E	26.76'
2) Set 3/4"x24" iron bar, down 6"	S71W	23.98'
3) Set 3/4"x24" iron bar, down 6"	N58W	38.24'
4) Set 3/4"x24" iron bar, down 6"	N17W	28.24'

Gary L. Dechant



October 29, 2015

419011A2000

I, William C. Jung, do hereby certify that on the 23rd day of February 1982, I found ~~evidence~~ (no evidence) of the West 1/4 corner of Section 13, T 19 N, R 1 E Fourth Principal Meridian, and I re-established said corner according to the Wisconsin Statutes as shown and described hereon.

Dated this 23rd day of Feb. 1983.

William C. Jung
Deputy County Surveyor
Title

History of corner establishment since Original Government Survey

Fred Holden re-established this corner in July of 1908. He also used this corner in surveys done in March of 1903 and July of 1903.

Description of corner evidence found:

After an extensive amount of searching and surveying in the NW1/4 of Section 13 (in and around the Norway Ridge area), I set the corner at a computed location that best fits the evidence that I found. In setting this corner, I feel that I found the rotted remains of a stump that Holden found, 6.6' to the West of my Harrison. This old bearing tree would have fit my corner.

See Reverse Side For Maintenance

Description of corner and witness monuments, references and accessories used to perpetuate the original or re-established location of this corner:

Witnesses to corner location:

William Jung
Bryan Meyer

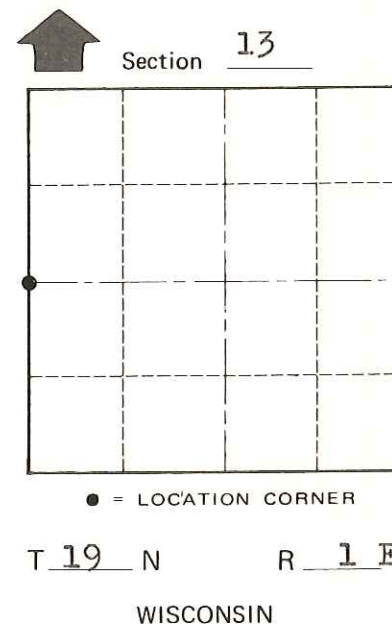
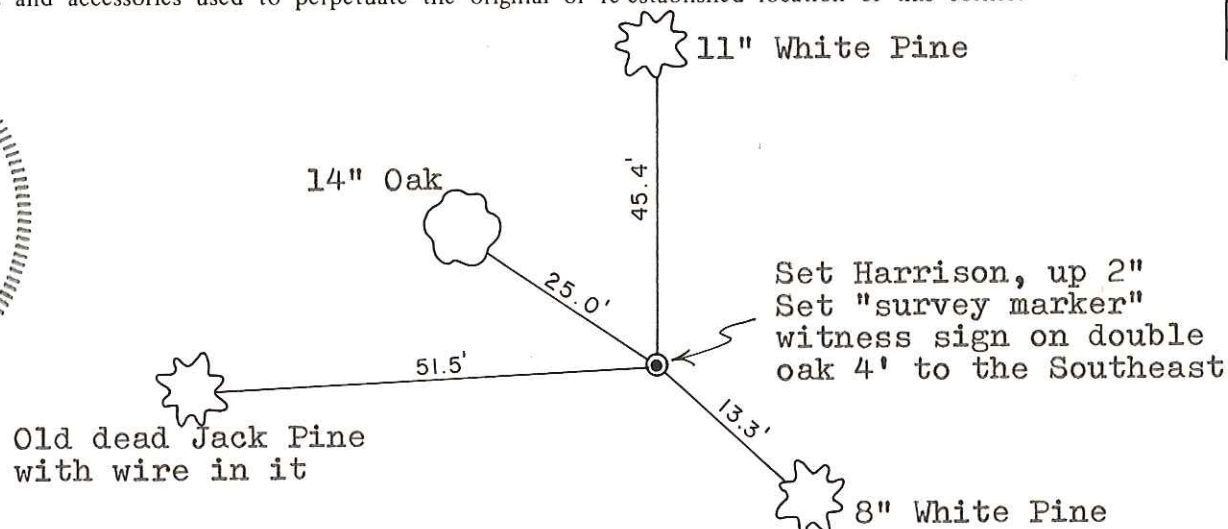
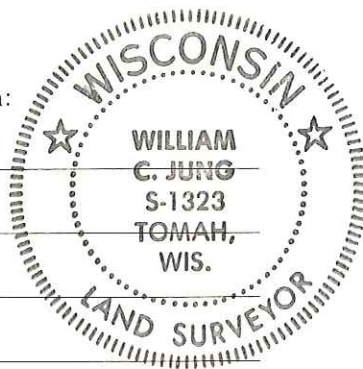

Note: All bearing trees are double blazed. Each distance is to the lower blaze. There is a nail in the lower blaze.

Approved: HARLEY A. SIME
MONROE CO. SURVEYOR

SURVEY CONTROL ORDER

Horizontal _____
Vertical _____

WISCONSIN COORDINATE SYSTEM

Corner	East (X)	North (Y)	Elevation (Z)	Zone
Control Sta. Name				

~~City, Village or~~ Town Scott
County of Monroe

COUNTY SURVEYOR FORM NO. 1