

# 35

**U.S. PUBLIC LAND CORNER  
MAINTENANCE**

**Corner ID : E1/4 Sec. 7, T19N-R1E  
41901072000**

<u>DATE</u>	<u>CREW</u>	<u>MONUMENT TYPE</u>
February 19, 2018	Zachariah P.Dechant Gary Dechant	Existing Harrison intact 16' east center line of Augusta Road 120' north of roadway running east

<u>References:</u>	<u>Bearing</u>	<u>Distance</u>
1) Set 1"x24" round iron bar, down 4" in middle of old roadway	N66E	39.10'
2) Existing 3/4" round iron bar, steel post 1/2' east	S87E	32.88'
3) Set 1"x24" round iron bar on bank, down 4", 7' NE of 10" White Pine	S66W	52.47'
4) Set 1"x24" round iron bar on bank, down 4", 4' NE of 10" White Pine	N87W	49.32'

**Harrison and reference markers set on straight lines.**

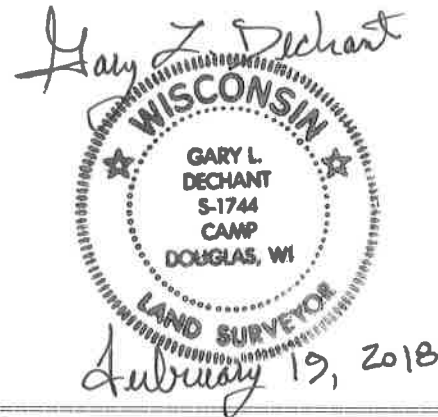

41901072000

I, Garold A. Sime, do hereby certify that on the 18<sup>th</sup> day of December 1986, I found ~~(evidence)~~ (no evidence) of the E/4 corner of Section 7, T 19 N, R 1 E Fourth Principal Meridian, and I re-established said corner according to the Wisconsin Statutes as shown and described hereon.

Dated this 29<sup>th</sup> day of Dec. 1986.

Garold A. Sime

Deputy County Surveyor

Title

History of corner establishment since Original Government Survey

Kennedy was near this corner in 1937, he makes no mention as to actually locating the corner.

Description of corner evidence found:

I established this corner on line and equidistant between Section corners.

**See Reverse Side For Maintenance**

Description of corner and witness monuments, references and accessories used to perpetuate the original or re-established location of this corner:

Set Harrison Monument at corner

Witnesses to corner location:

Garold A. Sime, R.L.S.

Eric Jensen

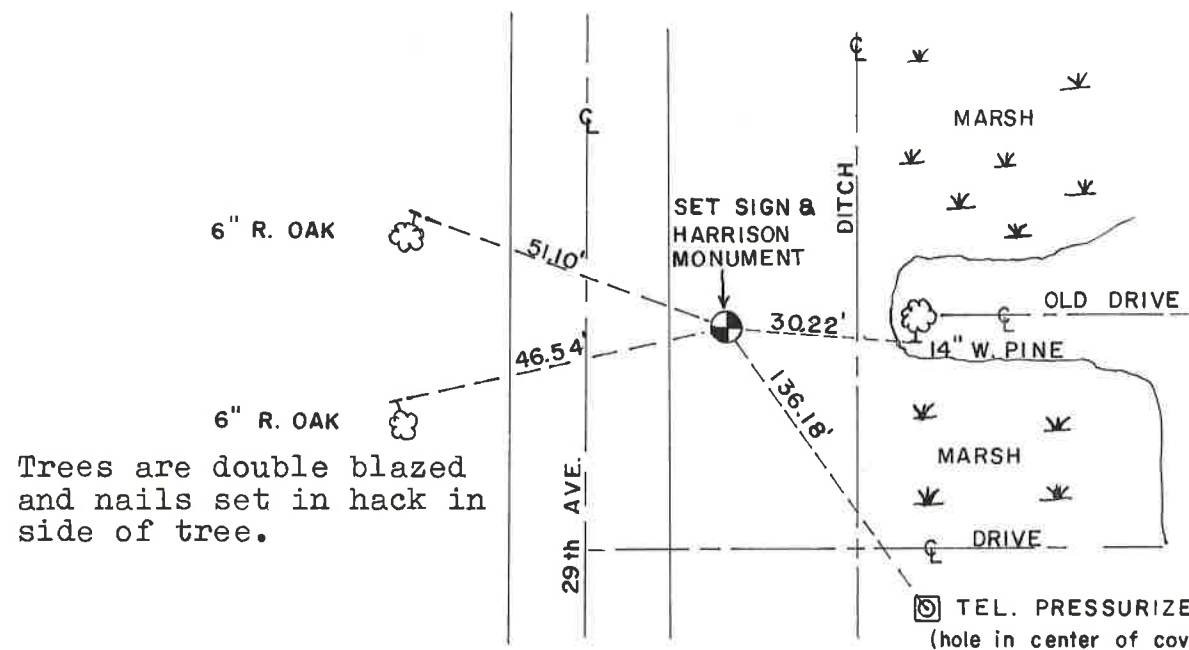
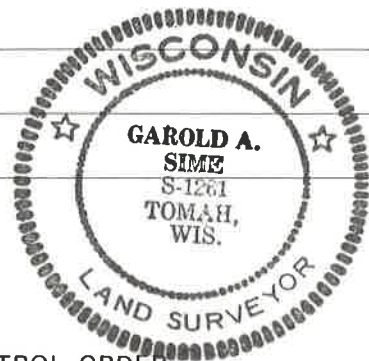

Trees are double blazed and nails set in hack in side of tree.

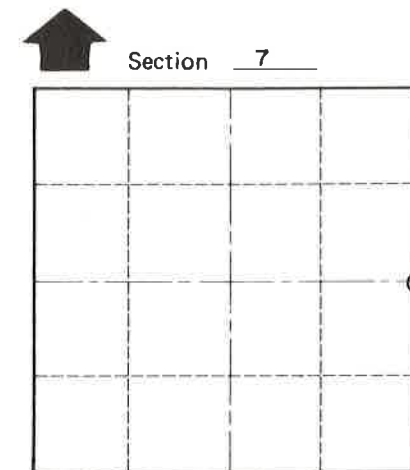

O = LOCATION CORNER

T 19 N R 1 E

WISCONSIN

TEL. PRESSURIZER (hole in center of cover going into ground)

SURVEY CONTROL ORDER

Horizontal	_____
Vertical	_____

WISCONSIN COORDINATE SYSTEM

Corner	East (X)	North (Y)	Elevation (Z)	Zone
Control Sta. Name				

City or Town Scott

County of Monroe

COUNTY SURVEYOR FORM NO. 1