

41901180000

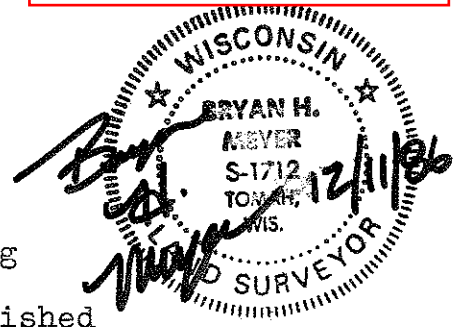

I, Bryan H. Meyer, do hereby certify that on the 29th day of April 1986, I found ~~evidence~~ (no evidence) of the Northwest corner of Section 20, T 19 N, R 1 E Fourth Principal Meridian, and I re-established said corner according to the Wisconsin Statutes as shown and described hereon.

Dated this 11th day of Dec. 1986.

Bryan H. Meyer

Deputy County Surveyor
Title

History of corner establishment since Original Government Survey

Fred A. Holden was here in June of 1902 and set a stone with a "X" mark. Kennedy was here in May of 1938.

Description of corner evidence found:

I searched the area of the corner for Mr. Holden's stone and witnesses. I found nothing. They were probably destroyed during construction of cranberry beds. I set this corner in the following manner: I found Mr. Holden's stone at the North 1/4 corner; I established the N1/16NW corner using the remains of Holden's Oak bearing tree; I established the Northwest corner of Section 20 by doubling West the bearing and distance of the line which runs along the North line of the NE1/4 of the NW1/4 of Section 20.

Description of corner and witness monuments, references and accessories used to perpetuate the original or re-established location of this corner:

Crew: Meyer, Sime
Date: April 29, 1986
Weather: Sunny, 70°
Witnesses to corner location:

Bryan H. Meyer

Gary Sime

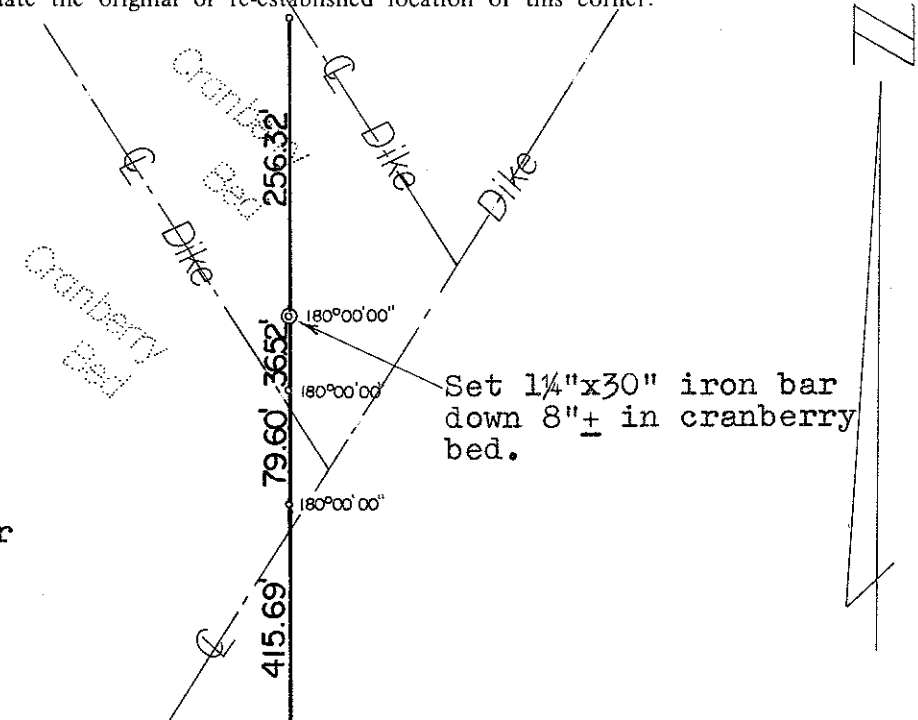

o = Set 3/4" x 24" iron bar

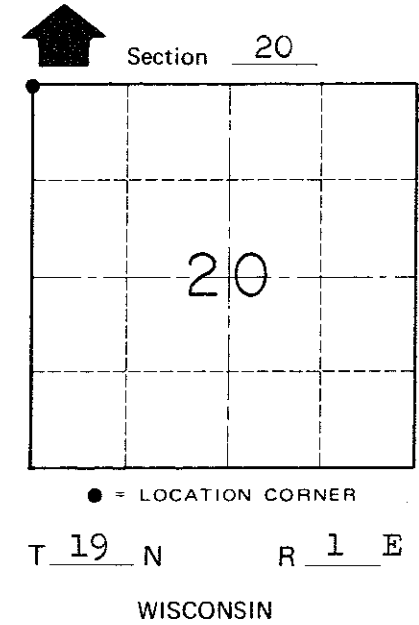

COUNTY SURVEYOR FORM NO. 1

SURVEY CONTROL ORDER

Horizontal	_____
Vertical	_____

WISCONSIN COORDINATE SYSTEM

Corner	East (X)	North (Y)	Elevation (Z)	Zone
Control Sta. Name				

~~City/Village of~~ Town of Scott
County of Monroe