

#9

**U.S. PUBLIC LAND CORNER  
MAINTENANCE**

**Corner ID : SE Sec. 32, T19N-R1E**

**41901320000**

<u>DATE</u>	<u>CREW</u>	<u>MONUMENT TYPE -----</u>
October 12, 2017	Zachariah P. Dechant Gary L. Dechant	Existing 2" stamped and Capped iron pipe, up 2' 5' west of Drainage ditch, west of Copper Road, North of STH "173". Set survey sign 2' North.

References:

	<u>Bearing</u>	<u>Distance</u>
1) Set 3/4"x24" round iron bar, down 6", west of ditch, east side of berm	North	24.49'
2) Set 3/4"x24" round iron bar, down 6", top of berm	S41W	21.59'
3) Set 3/4"x24" round iron bar, down 6", west side of berm	West	21.88'
4) Set 3/4"x24" round iron bar, down 6", top of berm	N42W	23.92'

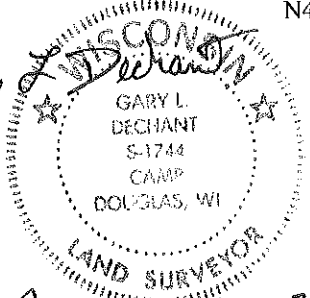
*Gary L. Dechant*  
  
*November 18, 2017*

I, Harley A. Sime, do hereby certify that on the 4th day of June 1980, I found (evidence) ~~(evidence)~~ of the NW corner of Section 4, T 18 N, R 1 E Fourth Principal Meridian, and I re-established said corner according to the Wisconsin Statutes as shown and described hereon.

Dated this 26th day of Feb. 1981.

Harley A. Sime, R.L.S. 355  
 \_\_\_\_\_  
 County Surveyor  
 Title

History of corner establishment since Original Government Survey

Holden was at this corner in September of 1909. Holden found the original corner in January of 1903. During his survey done in the 1930's, Kennedy set a pipe at this corner. Bergman found and used Kennedy's pipe in his survey of July, 1954.

Description of corner evidence found:

Found Kennedy's pipe.

**See Reverse Side  
For Maintenance**

COUNTY SURVEYOR FORM NO. 1

Description of corner and witness monuments, references and accessories used to perpetuate the original or re-established location of this corner:

Witnesses to corner location:

M. Scott Sowers  
T. Tormoen  
C. Dade

**Approved: HARLEY A. SIME  
MONROE CO. SURVEYOR**

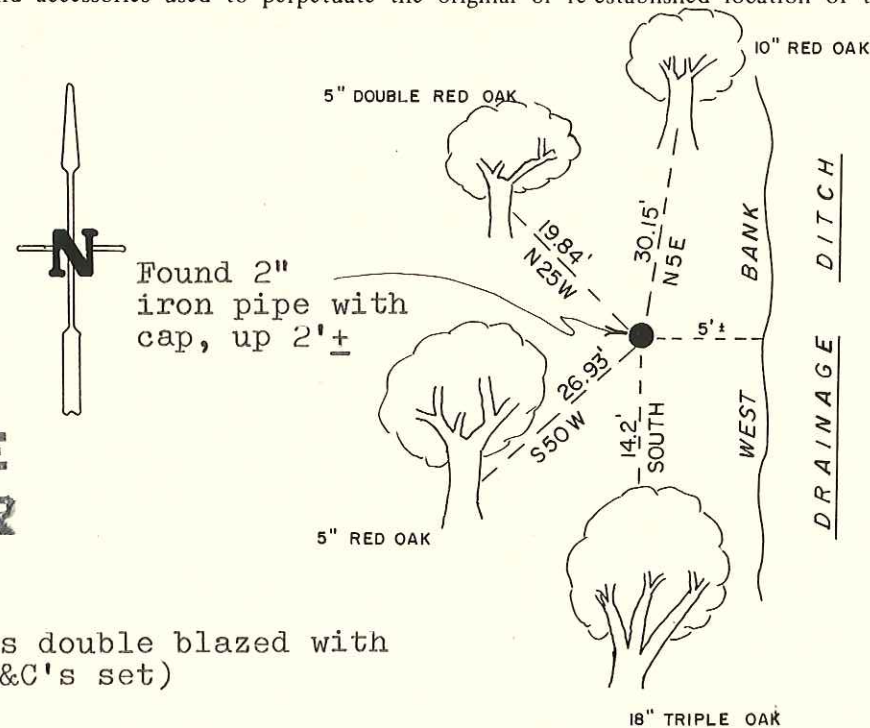

(All trees double blazed with N&C's set)

SURVEY CONTROL ORDER

Horizontal	_____
Vertical	_____

WISCONSIN COORDINATE SYSTEM

Corner	East (X)	North (Y)	Elevation (Z)	Zone
Control Sta. Name				

**PLACED  
COUNTY SURVEYOR'S  
SIGN 6-18-87**

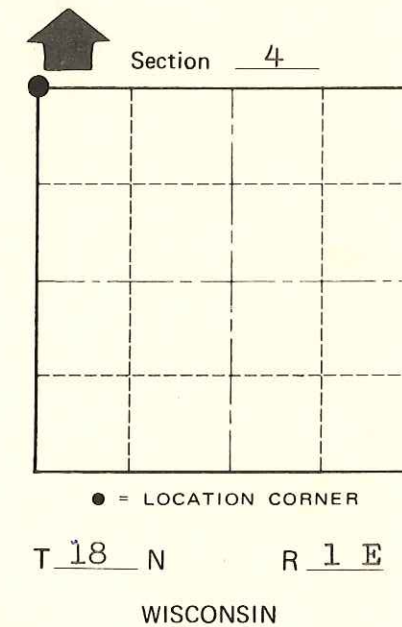

~~City, Village or~~ Town Byron  
 County of Monroe